Volume 18, No. 3—Summer 2005

MID-WESTERN EDUCATIONAL RESEARCHER

• Official Publication of the Mid-Western Educational Research Association •



Ashland University

Special Program Issue

October 12–15, 2005

The Westin Great Southern Hotel, Columbus, Ohio

On The Cover

Ashland University

Ashland University's new College of Education Building, which is expected to be completed in the spring of 2006, will be home to the undergraduate teacher education program as well as the master of education and doctor of education programs. The two-story, 52,000-square-foot building will provide much needed student instructional space in the form of 12 classrooms, four seminar rooms, 60 faculty and staff offices, several commons or meeting areas, state-of-the-art media center, peer teaching studio with one-way viewing mirror and 120-seat lecture hall.

The education program, which offers pre-K through doctorate level courses, is one of the largest among independent and state institutions in Ohio. The undergraduate teacher education program is the largest academic program on campus and has been NCATE accredited since 1973. All of AU's education programs—undergraduate, master of education, doctor of education and professional development services—are recognized on a state and national basis.

Founded in 1878, Ashland University is a private, comprehensive institution committed to challenging and supporting students intellectually, spiritually, socially, culturally and physically. Located midway between Cleveland and Columbus off Interstate 71, Ashland University is home to 2,150 full-time, undergraduate students. The University's total enrollment is 6,900 students, and this includes graduate programs in business, education and theology and the off-campus centers in Cleveland, Columbus, Massillon and Elyria.

To find out more about Ashland University and its College of Education, visit the AU web site at www.ashland.edu.

Call for Manuscripts

The *Mid-Western Educational Researcher* is a scholarly journal that publishes research-based articles addressing a full range of educational issues. The journal also publishes literature reviews, theoretical and methodological discussions that make an original contribution to the research literature, and feature columns. There are four issues of the journal published annually.

The journal is accepting manuscripts for review and possible publication. Manuscripts are submitted to blind reviews by three researchers with knowledge of the literature in the appropriate area. The editors will review the manuscript and make the final decision. The review process requires approximately four months.

Manuscripts are accepted from faculty, students, and professionals working in educational or non-educational settings. Membership in the MWERA is not required in order to submit a manuscript for review. The editors encourage the submission of revised papers that have been presented at the annual meetings of the MWERA, AERA, and other professional organizations.

Manuscripts may be submitted for review as hard copy or electronically.

Hard Copy Submission. Submit four (4) copies of the manuscript with a cover letter to Deborah Bainer Jenkins, Co-Editor. Manuscripts should conform to the style and format described in the *Publication Manual of the American Psychological Association, 5th edition*. All manuscripts should be typed, double-spaced, and on 8½ x 11 paper with 1½ inch margins on all sides. An abstract of less than 100 words should accompany the manuscript. The author's name, contact information, and affiliation should appear on the title page only. Submissions typically are less than 20 pages in length. A disk file (3½ inch diskette, MS Word) is also required with the submission.

Electronic Submission. Submit the manuscript to Deborah Bainer Jenkins, Co-Editor, at mer@westga.edu as an e-mail attachment. Indicate in the subject line that this is a MWERJ manuscript. As with hard copy, the manuscript should conform to APA style, be produced in MS Word, and be limited to 20 pages, including abstract and references, and contain full contact information for the author(s).

All manuscripts, whether submitted in hard copy or electronically, will be acknowledged upon receipt. Please note that authors are responsible to submit manuscripts that are free of grammatical and mechanical errors. The editors reserve the right to make minor modifications in order to produce a more concise and clear article.

Questions regarding the journal or the submission of feature columns should be directed to the co-editors listed below.

Deborah Bainer Jenkins, Ph.D.
Professor and Director
University of West Georgia
228 Education Annex
Carrollton, GA 30118
(678) 839-6078
mer@westga.edu

Adrian Rodgers, Ph.D.
Assistant Professor
The Ohio State University
1179 University Drive
Newark, OH 43055
(740) 366-9261
rogers.50@osu.edu

The *Mid-Western Educational Researcher* (ISSN 1056-3997) is published quarterly by the MidWestern Educational Research Association through The Ohio State University. The Summer issue serves as the annual meeting program. Non-profit postage paid at Columbus, Ohio, with permission of the College of Education, Donna Evans, Dean.
POSTMASTER: Send address change to Jean W. Pierce, Dept. EPCSE, Northern Illinois University, DeKalb, IL 60115.

MID-WESTERN EDUCATIONAL RESEARCHER

Volume 18, Number 3 · Summer 2005

ISSN 1056-3997

Program Chair

Sharon A. Valente
Ashland University

Associate Program Chairs

Janet K. Holt
Northern Illinois University

Rodney J. Greer
Western Illinois University

MWER Interim Co-Editors

Deborah L. Bainer Jenkins
State University of West Georgia

Adrian Rodgers
The Ohio State University

MWER Editorial Advisory Board

Ayres D'Costa
The Ohio State University

Louise Fleming
Ashland University

Tom Ganser
*University of Wisconsin
Whitewater*

Richard Lipka
Pittsburg State University

Isadore Newman
University of Akron

A. William Place
Past President
University of Dayton

Jackie Rickman
Educational Consultant

Thomas J. Smith
Northern Illinois University

Anne D'Antonio Stinson
*University of Wisconsin
Whitewater*

Consulting Editor

Mary Bendixen-Noe
Managing Editor
The Ohio State University

Layout and Design

Judy E. Teska
JET Desktop Solutions

| | |
|--|----|
| Welcome to MWERA—2005 | 2 |
| General Information | 3 |
| Conference Events and Highlights | 4 |
| Professional Development: Workshops | 5 |
| Board of Directors, Association Council, Program Committee | 6 |
| Proposal Reviewers | 7 |
| Conference Registration and Hotel Reservation | |
| Hotel Facilities and Services | 9 |
| Conference Registration Form | 10 |
| Hotel Reservation Form | 11 |
| Directions to the Westin Great Southern | 12 |
| Chronological Listing of Sessions | |
| Wednesday | 13 |
| Thursday | 15 |
| Keynote Address (Michael Schwartz, Cleveland State University) | 17 |
| New Member Welcome | 18 |
| Association Council Meeting | 19 |
| Cracker Barrel Social | 25 |
| Friday | 26 |
| Business Meeting (Division Chairs and Co-Chairs) | 26 |
| Luncheon Address (Bernard Franklin, National Collegiate Athletic Assn.) | 29 |
| MWERA Association Council and Officer's Orientation | 34 |
| President's Reception | 35 |
| Saturday | 36 |
| MWER Editorial Board Meeting | 37 |
| Presidential Address (Janet K. Holt, Northern Illinois University) | 37 |
| MWERA 2005 Feedback | 38 |
| Board of Director's Meeting | 39 |
| Division Meetings/Invited Addresses | 40 |
| References | |
| Cross-Index to Session Sponsors | 44 |
| Subject Index | 46 |
| Participant Index | 48 |
| Address Directory of Participants | 51 |
| Hotel Map | 59 |
| Conference At-A-Glance | 60 |

MWER Publication Address

Deborah Bainer Jenkins
State University of West Georgia
228 Education Annex
Carrollton, GA 30118
Phone: (770) 836-4461
e-mail: djenkins@westga.edu

MWER Subscription & MWERA Membership Information

Jean W. Pierce
LEPF Department
Northern Illinois University
DeKalb, IL 60115
Phone: (815) 753-8470
Fax: (815) 753-8750
e-mail: jpierce@niu.edu

Welcome to MWERA 2005!



Sharon A. Valente
MWERA Vice-President
& 2005 Program Chair

On behalf of the Board of Directors, Officers, and the 2005 Program Committee, I would like to welcome you to the 2005 Annual Meeting of the Mid-Western Educational Research Association. The program is comprised of keynote addresses; papers, which have undergone a rigorous peer-review process; invited addresses and panels; workshops; roundtables; and symposiums.

Our meeting opens on Wednesday, October 12, with three workshops. Later that evening, it is our honor to host **Dr. Michael Schwartz**, President of Cleveland State University for an informal conversation, our traditional Fireside Chat. Dr. Schwartz's Keynote Address, *The Chief Purpose of Universities: Academic Discourse and the Diversity of Ideas*, will be delivered on Thursday, October 13, at 9:30 am in the Grand Ballroom.

The Luncheon Keynote Address on Friday, October 14, will feature **Dr. Bernard Franklin**, Senior Vice President of the National Collegiate Athletic Association (NCAA). Dr. Franklin will be addressing *College Athletics as a Model For Promoting Academic Integrity in Higher Education*.

On Saturday, October 15, we will welcome the current President of MWERA, **Dr. Janet K. Holt**. Dr. Holt is an Associate Professor in the Department of Educational Technology, Research and Assessment at Northern Illinois University. Her talk is titled *How Do We Measure Up? Capturing the Complexities of Educational Growth*. Dr. Holt will address how advances in growth modeling approaches facilitate the measurement of educational policy goals

Dr. Holt's presidential address will tie in with the variety of invited addresses at this year's meeting. It is our honor to host **Dr. Barbara Byrd-Bennett**, CEO of Cleveland Municipal Schools; Ohio Senate President **Bill Harris**; **Dr. Nina Dorsch**, Department of Teaching and Learning at Northern Illinois University; **Dr. William Bowen**, Director of the Ph.D. program in Urban Studies and Public Affairs at Cleveland State University; and many other learned colleagues. In addition, an invited panel on the topic of Faculty Issues in Academic Integrity is scheduled for 3:10 pm on Thursday.

Our fellow MWERA authors will be hosting a book discussion/signing at 4:40 pm in the Grand Ballroom on Thursday and at 10:30 am in the Seneca Parlor on Friday. Come and meet the authors. See how their materials can work in your classrooms and your own research.

We have an exciting program this year that should be of interest to everyone who has a personal and professional interest in academic integrity. I would like to thank those that worked hard to bring this program together including the presenters, reviewers, discussants, chairs, Division Chairs and Co-Chairs, the Association Council and the Board of Directors. This program would not have been possible without your efforts.

Come join the dialogue centering on a neglected role in the academic integrity debate, the faculty. **Faculty Issues in Academic Integrity, Session F.0310.TC**, an invited panel, will do just that. Panel members represent a cross-section of administration and faculty in the K – College, public/private academic community.

General Information

The 2005 Annual Meeting of the Mid-Western Educational Research Association will be held from Wednesday, October 12 through Saturday, October 15, at the Westin Great Southern in Columbus, Ohio. Registration and a pre-conference workshop will begin Wednesday afternoon, with the **Fireside Chat** starting the formal program at 8:00 pm. Thursday, Friday, and Saturday will consist of research papers presented in a variety of different formats, workshops, invited speakers, meetings, and social events. The conference will conclude following the final sessions at noon on Saturday.

Meeting Registration is expected of everyone participating in or attending the 2005 annual meeting of the Mid-Western Educational Research Association. Registrants are provided a MWERA-05 Name Tag, which must be worn at all times while at the conference. Those planning to attend MWERA-05 are strongly encouraged to pre-register for the conference and workshops, and to make hotel reservations as soon as possible. Pre-registration and hotel reservations must be received by September 23, 2004. Registrations mailed after this date may not be received in time for processing, and on-site payment in the form of cash or personal check will be expected. If double-payment is later determined, a refund will be issued. On-site registration and packet pick-up will be available at the registration desk in the Lobby of the Westin Great Southern at the following times:

Wednesday, October 12, 1:00 pm–6:00 pm

Thursday, October 13, 8:00 am–5:00 pm

Friday, October 14, 8:00 am–5:00 pm

Saturday, October 15, 8:00–10:00 am

Membership in the Mid-Western Educational Research Association provides reduced conference registration fees and a subscription to the *Mid-Western Educational Researcher*, the official MWERA publication. Attendees are encouraged to join. **Conference presenters must be paid members for 2005.**

MWERA **Publications** are available through pre-registration. These include the *Directory of MWERA Members* for \$8 and the *MWERA 2005 Program Abstracts* for \$8. These items may not be available at the conference unless ordered through pre-registration. If additional items are available they will be offered for sale at the registration table by cash or check only.

This year's **Exhibit Hall** will feature publishers and others providing materials and services to educators on Friday from 9:00 am to 4:40 pm. The Exhibit Hall will be located in the Mezzanine.

Session Formats

Paper Presentation

Paper sessions allow presenters the opportunity to make short, relatively formal presentations in which they overview their papers to an audience. Three to four individual papers dealing with

related topics are grouped into a single session lasting no longer than one hour and twenty minutes. The presenter(s) of each paper is (are) allowed approximately 15 minutes to present the highlights of the paper. Sessions will have a Session Discussant who will, following all papers, provide comments and a critical review. A Session Chair moderates the entire session. Presenters are expected to provide complete copies of their papers to all interested audience members.

Roundtable Discussion/Poster

Roundtable Discussion/Poster sessions provide opportunities for interested individuals to participate in a dialogue with other interested individuals and the presenter(s) of the paper. Presenters are provided a small table around which interested individuals can meet to discuss the paper. Presenters may elect to provide small, tabletop poster-type displays, ancillary handouts, or other tabletop A/V materials to augment their discussions. Interested individuals are free to move into and out of these discussions/posters as they wish. Presenters are expected to make available complete copies of the paper to all attendees. Multiple roundtable discussion/poster sessions are simultaneously scheduled in a common session slot lasting one hour and twenty minutes.

Symposium

A symposium provides an opportunity for examination of specific problems or topics from a variety of perspectives. Symposium organizers have identified the topic or issue along with individual speakers who will participate in the session. Participants may be provided with papers or other handouts relevant to, reflective of, or drawn from the symposium, and may be encouraged to participate in discussions and/or focused exercises as a part of the symposium's activities. Symposia are typically scheduled for one hour and twenty minutes.

Workshop

Workshops provide an extended period of time during which the workshop leader(s) helps participants develop or improve their ability to perform some process (e.g., writing grant proposals, using the latest features of the Internet, or conducting an advanced statistical analysis). Workshops have been scheduled throughout the conference, allowing attendees the opportunity to attend several workshops of their choosing. All workshops involve pre-registration, although same day registration will be considered on a space-available basis.

Alternative Session

Only the imagination and creativity of the session organizer limit the form, topics, format and length of time of alternative format sessions. The presenter(s) of alternative sessions have recruited the major participants or speakers, as well as developed and provided necessary materials. They will conduct or mediate the session as detailed in the program description.

Conference Events and Highlights

Dr. Michael Schwartz will open the 2005 Annual Meeting of MWERA with an informal Fireside Chat Wednesday evening at 8:00 pm in the Mezzanine. Refreshments will be provided. On Thursday at 9:30 am Dr. Schwartz will present the Keynote Address, *The Chief Purpose of Universities: Academic Discourse and the Diversity of Ideas*, in the Grand Ballroom. Dr. Schwartz will discuss academic integrity from the role of the state in funding education and the responsibility of institutions to fulfill their mandates. Dr. Schwartz will be available for further discussion and questions following the Keynote in the Chittenden Parlor.

Division Meetings have been scheduled throughout the day on Thursday and Friday. All division meetings have invited speakers! Just a few of our more notable invited addresses includes: **Dr. Barbara Byrd-Bennett**, CEO of Cleveland Schools; **Mr. Bill Harris**, President of the Senate of the State of Ohio; **Dr. William Bowen**, Director of the Ph.D. program in Urban Studies at Cleveland State; and **Dr. Nina Dorsch**, Chair of the Department of Teaching and Learning at Northern Illinois. Participation in a division is an important part of MWERA membership. Get to know some of your colleagues in a division and become active by helping to recruit new members and plan next year's conference.

New Members are encouraged to attend a new member welcome session Thursday morning at 10:30 am in the Mezzanine. Come meet other MWERA members both new and old, and find out why we are proud of our research efforts, collegiality, support, and friendships. **Student Members** are encouraged to attend the Division E invited address by current doctoral candidates, entitled, *The Road Less Traveled: How to Make a Difference in Your Doctoral Studies*, at 3:10 pm on Thursday. Our student member welcome session follows at 4:40 pm in the Seneca Parlor. Come and get acquainted with your fellow students and the benefits of MWERA membership.

The **MWERA Association Council** will hold its annual meeting over lunch on Thursday, beginning at Noon in the Grand Ballroom. All Association Council members are expected to attend.

Two **Roundtable Discussion/Poster** sessions have been scheduled in the Grand Ballroom. Both are scheduled for 3:10 pm with one on Thursday and one on Friday. Numerous interesting presentations on a variety of topics will take place during these times.

The **Cracker Barrel Social** will be held from 6:00 pm to 8:00 pm in the Mezzanine on Thursday. This informal event offers a chance to relax and enjoy the company of your MWERA colleagues and friends. A cash bar and hors d'oeuvres will be provided. Division Chairs and Co-

Chairs are invited to the Continental Breakfast on Friday at 7:00 am and the Division meeting on Friday at 8:00 am in the Hartman Parlor.

Everyone is encouraged to attend the annual **Business Meeting**, scheduled on Friday from 9:30 am through 10:20 am in the Grand Ballroom. President Janet K. Holt will preside over an agenda of issues critically important to the association. Your input is both needed and welcome!

At the Friday Luncheon Keynote Address, we are honored to have **Dr. Bernard Franklin**, Senior Vice-President of the National Collegiate Athletic Association. The title of Dr. Franklin's talk is *College Athletics as a Model For Promoting Academic Integrity in Higher Education*. Remember, you must pre-register for the conference in order to be guaranteed a seat at the luncheon! Immediately following the luncheon, Dr. Franklin will be available for questions, in the Chittenden Parlor beginning at 1:40 pm.

All newly elected Association Council Members and Officers should attend the **MWERA Association Council and Officers' Orientation** Friday at 4:40 pm in the Chittenden Parlor. All members holding elected positions within the Association are requested to attend this session.

The highlight of Friday evening will be the **President's Reception**, scheduled from 6:00 pm until 8:00 pm in the Mezzanine. Your host for the evening will be Janet K. Holt, the current President of MWERA. This reception is a great way to unwind and catch up with your colleagues!

The **Editorial Board** of the Mid-Western Educational Researcher will meet on Saturday morning at 8:00 am in the Vendome Board Room. All members of the Editorial Board should attend.

Dr. Janet K. Holt, Associate Professor in the Department of Educational Technology, Research and Assessment at Northern Illinois University and President of MWERA, will deliver the Presidential Address on Saturday at 9:30 am in the Grand Ballroom. Her talk is titled *How Do We Measure Up? The Complexities of Growth*. Dr. Holt will address how advances in growth modeling approaches facilitate the measurement of educational policy goals. **Sharon Valente**, the 2005 Program Chair, and the 2006 Program Chair, **Craig Mertler**, will be available to listen to your comments about the 2005 Annual Meeting at the **Conference Feedback** session Saturday morning starting at 10:30 am in the Mezzanine. Planning for the 2006 conference begins at this session so be sure your comments are heard.

Professional Development: Workshops

MWERA will sponsor a series of Professional Development Workshops held in conjunction with the Annual Meeting. These workshops are organized to meet specific training needs and to transmit specific research, development, and evaluation skills.

Hierarchical Linear Modeling

Fee: \$150

Wednesday, 1:00 pm–4:00 pm—Neil House Parlor

PRESENTER: Rafa M. Kasim, Kent State University and Sema A. Kalaian, Eastern Michigan University.

This workshop covers the basics and applications of multilevel modeling via Hierarchical Linear Modeling (HLM). Participants will learn: (1) how to conceptualize the basic two-level structured multilevel data; (2) how to analyze multilevel data using the HLM6 software; and (3) how to interpret the HLM6 analysis results. Each participant will be provided with a binder that includes the workshop outline and handouts of how to use HLM6, and HLM6 outputs. Participants are encouraged to bring their own laptop computers.

Writing and Securing Grants

Fee: **

Wednesday, 1:00 pm–3:30 pm—Park Parlor

PRESENTERS: Howard Walters and Sharon Valente, Ashland University.

The overall objective of the workshop is to utilize an organized, focused approach to seek, write, and obtain grant funds. The first part of the presentation will deal with successful grant seeking strategies. The importance of defining your request and creating a list of relevant search terms will be emphasized and modeled on-line. The second part of the workshop will focus on the key elements to writing a successful grant. Finally, the presenters will conclude with tips for grant writing success from their own experience.

**The presenters have requested that attendees bring their own laptops and procure the hotel's internet connection. There is no other charge.

Focus Group Interview Moderator Training

Fee: N/C

Wednesday, 4:00 pm–6:00 pm—Park Parlor.

PRESENTER: Thomas M. Archer, The Ohio State University

In a Focus Group Interview (FGI), a small group is guided through a pre-thought line of questioning for 1-2 hours by a trained Moderator. But the role of a Moderator is not easy. A good FGI Moderator possesses skills that are markedly different from other group facilitation. This workshop will highlight the process of FGI research. Detailed skills of high quality FGI Moderators will be discussed and demonstrated. Guidelines and tips will be shared for completing FGI projects on low budgets and in a variety of settings.

Facilitating Stimulating Case Study Discussions

Fee: N/C

Thursday, 1:40 pm–3:00 pm—Park Parlor

PRESENTER: Mary R. Sudzina, The University of Dayton.

Case studies are being increasingly integrated into teacher preparation programs. This increase appears to be in response to the need for preservice teachers to be exposed to case studies in preparation for the Praxis II: Principles of Learning and Teaching Test, which is case-based. Instructors who have experienced traditional, teacher-centered instruction are looking for ways to apply case studies, a constructivist, student-centered approach to teaching and learning, in their courses. Workshop highlights include: a 5-step process for case analysis; 20 techniques for facilitating case discussions; and, a video of a case discussion in progress in which those techniques are demonstrated and modeled.

Effective and Ineffective Metacognitive Knowledge Monitoring in Post-Secondary Education

Thursday, 1:40 pm–3:00 pm—Thurber Conference Suite

PRESENTER: Randy M. Isaacson, Indiana University South Bend.

One of the most frustrating teaching dilemmas in post-secondary education is helping students who claim to have mastered the course content but are unable to demonstrate their understanding. But instructors who carefully question these students realize this is not the case. This workshop will report on research from the last decade on metacognitive knowledge monitoring and present a program that teaches both self-regulated learning and metacognition. Over the past five years the author has researched the relationship between metacognitive knowledge monitoring and classroom learning and has developed a program in his educational psychology class which compels student to self-regulate their learning and develop skills in metacognitive knowledge monitoring.

The Five Ws of Getting Published

Friday, 10:30 am–11:50 am—Chittenden Parlor

PRESENTER: Deborah Bainer Jenkins, State University of West Georgia.

Everyone can be effective at scholarship once they consider the five Ws of publishing. Prospective writers need to decide WHAT they'll write about, WHO they'll target with their manuscript, WHEN they work best on scholarship, WHERE they will submit their manuscript, and WHY they want to publish at all. This interactive workshop aims to answer questions commonly posed by would-be publishers, and to inspire participants to take action in setting concrete goals and becoming published. Information about the MWERA journal and submission processes will also be presented.

Board of Directors

Immediate Past President

A. William Place, *University of Dayton*

President

Janet K. Holt, *Northern Illinois University*

President-Elect

Rodney J. Greer, *Western Illinois University*

Vice-President

Sharon A. Valente, *Ashland University*

Secretary

Cynthia Campbell, *Northern Illinois University*

Vice-President Elect

Craig A. Mertler, *Bowling Green State University*

Vice-President-Elect Elect

Dimitar Dimitrov, *George Mason University*

Member-at-Large

Thomas J. Cody, *Western Illinois University*

Member-at-Large Elect

Gordon Brooks, *Ohio University*

Executive Officer (ex officio)

Jean W. Pierce, *Northern Illinois University*

Co-Editors, Mid-Western Educational Researcher (ex officio)

Deborah Bainer Jenkins, *State University of West Georgia*

Adrian Rodgers, *The Ohio State University*

Historian/Archivist (ex officio)

Sharon McNeely, *Northeastern Illinois University*

Association Council

2003-2005

Mary Bendixen-Noe, *The Ohio State University*

Gordon Brooks, *Ohio University*

Dimitar Dimitrov, *Kent State University*

Sharon McNeely, *Northeastern Illinois University*

Carol Newman, *The University of Akron*

Thomas Smith, *Northern Illinois University*

E. Jane Williams, *The Ohio State University*

2004-2006

Doris Bergen, *Miami University*

Beverly Dretzke, *University of Wisconsin at Eau Claire*

Carmen Giebelhaus, *Educational Testing Service*

Richard Hofmann, *Miami University*

Carole Newman, *University of Akron*

David Newman, *Cleveland State University*

Aimin Wang, *Miami University*

2005-2007

Kelly Bradley, *University of Kentucky*

Kathleen Sullivan Brown, *University of Missouri–
St. Louis*

Thomas J. Cody, *Western Illinois University*

Doug Feldmann, *Northern Kentucky University*

Gregory P. Montalvo, *Western Illinois University*

Glenda Moss, *Indiana University Purdue University
Fort Wayne*

Ted A. Zigler, *University of Cincinnati*

Judith A. Zimmerman, *Bowling Green State University*

Program Committee

Program Chair

Sharon A. Valente, *Ashland University*

Associate Program Chairs

Rodney J. Greer, *Western Illinois University*

Janet K. Holt, *Northern Illinois University*

Division A: Administration

Charles Kline, *Purdue University*

Ted Zigler, *University of Cincinnati*

Division B: Curriculum Studies

Bruce W. Jones, *Notre Dame College*

Doug Feldmann, *Northern Kentucky University*

Division C: Learning and Instruction

Tracey Stuckey-Mickell, *Northern Illinois University*

Division D: Measurement and Research Methodology

Gordon P. Brooks, *Ohio University*

Sema Kalaian, *Eastern Michigan University*

Division E: Counseling and Human Development

John M. Laux, *University of Toledo*

Andrew Burck, *University of Toledo*

Jean Roberts, *University of Toledo*

Division F: History and Historiography

Amy Rose, *Northern Illinois University*

Sandra Spickard Prettyman, *University of Akron*

Division G: Social Context of Education

Aimin Wang, *Miami University*

Mark Brown, *Eastern Illinois University*

Division H: School Evaluation and Program Development

Isadore Newman, *The University of Akron*

Russell C. Brown, *Cleveland Municipal School
District*

Division I: Education in the Professions

Major LeAnn Derby, *United States Air Force
Academy*

Catherine Marsh, *North Park University*

Division J: Postsecondary Education

Heath Marrs, *Fort Hays State University*

Mark Magnuson, *Ivy Tech State College–Central
Indiana*

Division K: Teaching and Teacher Education

Francine Falk-Ross, *Northern Illinois University*

Glenda Moss, *Indiana University Purdue University
Fort Wayne*

Division L: Educational Policy and Politics

Kathleen S. Brown, *University of Missouri–St. Louis*

James E. Murray, *University of Missouri–St. Louis*

Join me in congratulating our newly elected officers:

Dimitar Dimitrov, Vice-President-Elect Elect;
Gordon Brooks, Member-at-Large, and the
new members of the **Association Council**.

Welcome!

Proposal Reviewers

The 2005 Program Committee wishes to express our appreciation to the following individuals who donated their time to assist in the process of reviewing proposals:

Albert Adusah, *Ohio University*
Christian Anderson, *Pennsylvania State University*
David Anderson, *Eastern Michigan University*
Robert Archer, *Notre Dame College*
Debi Askelson, *Northern Illinois University*
Lu Bailey, *Ohio State University*
Linda Bakken, *Wichita State University*
Robert Barcikowski, *Ohio University*
Jamie Basham, *Eastern Illinois University*
Doris Bergen, *Miami University*
Carl Beyer, *Concordia University*
Doris U. Bolliger, *St. Cloud State University*
Kelly D. Bradley, *University of Kentucky*
Will Bradley, *University of Kentucky*
Kathleen Brown, *University of Missouri St. Louis*
Mark S. Brown, *Eastern Illinois University*
Russell Brown, *Cleveland Municipal School District*
Martha Brueggeman, *Ashland University*
Amy Camardese, *Westminster College*
Cynthia Campbell, *Northern Illinois University*
Ni Chang, *Indiana University-South Bend*
E. Anne Christo-Baker, *University of Toledo*
Tom Cody, *Western Illinois University*
Rosetta Marantz Cohen, *Smith College*
Steven Corfman, *Antioch College*
Ed Corley, *Heidelberg College*
Daniel B. Coupland, *Saginaw Valley State University*
Jane Cox, *University of Toledo*
Cathryn Crosby, *Ohio State University*
Jessica Cunningham, *University of Kentucky*
Sally Ann Davis, *Northern Illinois University*
Gary Daytner, *Western Illinois University*
Katrina Daytner, *Western Illinois University*
Stephanie Lynn Daza, *Ohio State University*
Ayres G. D'Costa, *Ohio State University*
Corey Drake, *University of Missouri St. Louis*
Beverly J. Dretzke, *University of Wisconsin-Eau Claire*
Elin Driana, *Ohio University*
Mark A. Earley, *Bowling Green State University*
Hua Fang, *Ohio University*
Doug Feldmann, *Northern Kentucky University*
Clara Fitzpatrick, *Columbia College*
John Fraas, *Ashland University*
Masoud Ghaffari, *East Tennessee State University*
Caremn R. Giebelhaus, *ETS Praxis Workshop Coordinator*
Connie Goddard, *Roosevelt University*
Barbara Graham, *Ball State University*
Ann Hassenpflug, *University of Akron*
Barbara Havira, *Western Michigan University*
Ashimuneze Heanacho, *Central Michigan University*
Victor Heh, *Ohio University*
Laurie Mose Hines, *Kent State University-Trumbull*
Rich Hofmann, *Miami University*
Janet K. Holt, *Northern Illinois University*
Hsin-Ling Hung, *Ohio State University*
Diane M. Hunn, *Miami University*
Yooyeun Hwang, *Hope College*
Tim Ilg, *University of Dayton*
Edward A. Janak, *University of Wyoming*
Erwin V. Johannningmeier, *University of South Florida*
George A. Johanson, *Ohio University*
Joan M. Johnson, *Northeastern Illinois University*
Bruce W. Jones, *Notre Dame College*
Melissa Jones, *Eastern Illinois University*
Benjamin Justice, *Rutgers University*
Sema Kalaian, *Eastern Michigan University*
Deborah Kalkman, *Northern Illinois University*
Gibbs Y. Kanyongo, *Duquesne University*
Necdet Karasu, *Indiana University*
Carol Karpinski, *Fairleigh Dickinson University*
Rafa Kasim, *Kent State University*
Ralph D. Kidder, *Newbury College*
Beverly M. Klecker, *Morehead State University*
Chuck Kline, *Purdue University*
Theodore J. Kowalski, *University of Dayton*
Jay Levine, *The University of Akron*
Marsha Lewis, *Ohio University*
Xin Liang, *University of Akron*
David Loe, *Chardon High School*

Ann Marie LoPrieno, *Northwestern University*
Brenda Lee Love, *Private*
Catherine A. Lugg, *Rutgers University*
Mark M. Magnuson, *Ivy Tech Community College*
Michael D. Malone, *University of Cincinnati*
Eric Mansfield, *Western Illinois University*
Virginia Marion, *Ursuline College*
Heath Marrs, *Fort Hays State University*
Catherine A. Marsh, *North Park University*
Joy L. Matthews-Lopez, *Ohio University*
Charles May, *University of Northern Iowa*
Nelly Maynard, *Chicago State University*
Sharon McNeely, *Northeastern Illinois University*
Keith McNeil, *New Mexico State University*
Craig Mertler, *Bowling Green State University*
Scott Metzger, *Michigan State University*
Willie R. Mickell, *Northern Illinois University*
Larry Miller, *Ohio State University*
Greg Montalvo, *Western Illinois University*
Glenda Moss, *Indiana University Purdue University*
James E. Murray, *University of Missouri St. Louis*
Noriko Nagata, *Ohio State University*
Virginia Navarro, *University of Missouri St. Louis*
Carole Newman, *University of Akron*
David Newman, *Cleveland State University*
Isadore Newman, *The University of Akron*
Robert Nolan, *Oklahoma State University*
Jerry Obiekwe, *University of Akron-Wayne College*
Marlene G. O'Brien, *Cleveland State University*
Linda O'Neill, *Northern Illinois University*
Thomas S. Parish, *Upper Iowa University;*
Kansas State University
Michelle C. Partlow, *University of Dayton*
Kelli Paul, *Indiana University*
Kim Pittman, *Aurora University*
A. William Place, *University of Dayton*
John Poster, *University of Michigan-Dearborn*
Cathy Pugh, *Ohio University*
Hema Ramanathan, *Butler University*
Adah Ward Randolph, *Ohio University*
Carolyn S. Ridenour, *University of Dayton*
Jeff Ritchey, *Pennsylvania State University*
Bruce Rogers, *University of Northern Iowa*
Chris Roseman, *University of Toledo*
Amanda Rovnak, *The University of Akron*
Kenneth Royal, *University of Kentucky*
Joy Russell, *Eastern Illinois University*
J. Paul Rutter, *Pennsylvania State University*
Ann Marie Ryan, *Loyola University Chicago*
Lesla Sadler, *Pennsylvania State University*
Shannon Sampson, *University of Kentucky*
Susan J. Sanner, *Clayton College*
Alvin J. Schilling, *University of Florida*
Marlene Schommer-Aikins, *Wichita State University*
Lucia Schroeder, *Eastern Illinois University*
Greg Seals, *College of Staten Island/CUNY*
Hiral Shah, *Eastern Michigan University*
Carla Shaw, *Northern Illinois University*
David Sheppard, *TriCounty Special Education*
Shelley Sherman, *Lake Forest College*
Cathy Siebert, *Ball State University*
Ellen Sigler, *Indiana University-Kokomo*
Thomas Sinclair, *Eastern Illinois University*
Ruslan Slutsky, *University of Toledo*
Denise M. Smith, *California State University-Monterey Bay*
Thomas J. Smith, *Northern Illinois University*
Sandra Spickard Prettyman, *University of Akron*
W. Franklin Spikes, *Kansas State University*
Barbara Sposet, *Notre Dame College*
William M. Stone, *Saint Xavier University*
Angie Stuckey, *Northern Illinois University*
KayAnn Taylor, *SUNY Fredonia*
Shawgi Tell, *Nazareth College of Rochester*
Kelli R. Thomas, *University of Kansas*
Randy Turk, *Wichita State University*
Paul Vogt, *Illinois State University*
Selma Vonderwell, *Cleveland State University*
David A. Walker, *Northern Illinois University*
Steve Wallace, *Aurora University*
Peter Wallenstein, *Virginia Tech*
Aimin Wang, *Miami University*
Joseph Watras, *University of Dayton*
Deborah D. Webster, *Cleveland State University*
Kathryn Wiggins, *DePaul University*
Elizabeth Wilkins, *Northern Illinois University*
Robert S. Wolff, *Central Connecticut State University*
Jennifer L. Young, *University of Wisconsin*
Mary Zahner, *University of Dayton*
Ted A. Zigler, *University of Cincinnati*
Judy Zimmerman, *Bowling Green State University*

Conference Registration and Hotel Reservations

Attending MWERA begins with registering for the conference and reserving a room at the Westin. These two steps require the completion of two different forms, mailed to two different locations, with two different deposits and sets of required information. **DO NOT SEND YOUR CONFERENCE REGISTRATION TO THE HOTEL, OR SEND YOUR HOTEL RESERVATION IN WITH YOUR CONFERENCE REGISTRATION!** This can delay your registration/reservation, or result in your not being registered for the conference and/or not having a place to stay in Columbus.

Pre-Registration vs. On-Site Registration

MWERA allows both pre-registration and on-site registration; however, pre-registration is strongly encouraged. Pre-registrants have first opportunity to enroll in Workshops, to purchase Materials, and to attend the catered Luncheon on Friday. Pre-registration is also less expensive! To pre-register for the 2005 Annual Meeting, complete the form on the following page and return it, with your check or money order for payment in full, to Jean W. Pierce, MWERA's Executive Officer.

Pre-registrations must be postmarked by September 24, 2005, to qualify for the reduced rates!

Be sure to mention MWERA when making your reservations

On-site registration will be available at the registration desk in the lobby of the Westin Great Southern Hotel beginning at 1:00 pm on Wednesday, October 12, and continuing through 10:00 am on Saturday, October 15.

October 12–15, 2005, is an unusually busy time in Columbus. A few of the events include a Renoir exhibit and an Ohio State home football game. Hotel space could be tight, if not completely unavailable, to those who do not have confirmed reservations. Our convention hotel, the Westin Great Southern, is holding a block of rooms for MWERA attendees; however, they will only hold these rooms until September 24! To ensure that you have a place to stay please make your reservations with the hotel early. The hotel must receive your reservations by September 24. **Participants in the conference are strongly urged to register at the Westin Great Southern, since that directly affects the amount which MWERA will owe the hotel.** Please help us keep our costs low so that we can continue to provide a high quality conference.

Hotel Facilities and Services

The 196 luxurious guestrooms at the Westin Great Southern boast the Westin Hotels' infamous Heavenly Bed™ and the Heavenly Bath™, coffee makers, irons and ironing boards, hair dryers, refreshment centers and 27" televisions that are equipped with Nintendo®, pay-per-view movies and web access. Wireless Internet access is available for a fee. Each phone includes data ports and personalized voice-mail, and for extra security, an in-room safe is offered. A fitness room is conveniently located on the 3rd floor and the city has many walking/jogging paths close to the hotel.

Overhead projectors and screens will be provided by MWERA. **However as was stated clearly in our call, presenters needing additional A/V equipment, such as a laptop and LCD projector, are responsible for providing their own equipment or for arranging to rent from the hotel at the presenter's own expense.** The hotel has a wide variety of audio-visual equipment for rent. Contact the hotel directly well before the meeting for your needs, hotel pricing and availability, and payment. The telephone number is (614) 228-3800.



MWERA-2005 Conference Registration Form

Great Southern Hotel, Columbus, OH

October 12–15, 2005

Your Name: _____
(as you would like it to appear on your name tag) (First Name) (Middle Initial) (Last Name)

Affiliation: _____

Mailing Address: _____

Home Phone: (_____) _____ Office Phone: (_____) _____

FAX: (_____) _____ E-mail: _____

Highest Degree: _____ Institution Awarding Degree: _____

MWERA Division Preference: _____ Area of Specialization: _____

Is this your first MWERA conference? Yes No If YES, who told you about MWERA? _____

Workshop Registration

Advanced registration for workshops is strongly recommended. All work-shops are subject to cancellation for insufficient registration, and are open to on-site and same-day registration on a space available basis.

- W.0100.NH HLM \$150
- W.0100.PP Grant **
- W.0400.PP Focus Group N/C
- T.0140.PP Case Studies N/C
- T.0140.TC Metacognition N/C
- F.1030.CP Publishing N/C

**The presenters have requested that attendees bring their own laptops and procure the hotel's internet connection. There is no other charge.

Meeting Registration

| | By <u>9/24/05</u> | After <u>9/24/05</u> |
|---|----------------------|-------------------------|
| <input type="checkbox"/> MWERA Member | \$65.00 | \$75.00 |
| <input type="checkbox"/> Non-Member | \$70.00 | \$80.00 |
| <input type="checkbox"/> Student Member (see note below) | \$30.00 | \$35.00 |
| <input type="checkbox"/> One day registration (includes Friday Luncheon) | \$40.00 | \$50.00 |
| <input type="checkbox"/> Attending Luncheon Only | \$25.00 | \$28.00 |
| TOTAL Registration Fee Enclosed: | \$ _____ | |

Membership Dues

| | <u>Regular</u> | <u>Student</u> |
|--|----------------|----------------|
| 2005–2006 Membership | \$45.00 | \$25.00 |
| Lifetime | \$450.00 | \$450.00 |
| TOTAL Membership Dues Enclosed: | \$ _____ | |

MWERA-2005 Conference Materials

| | Cost per | Qty | Total |
|----------------------------|----------|-------|-------|
| MWERA Membership Directory | \$8.00 | _____ | _____ |
| MWERA-05 Program Abstracts | \$8.00 | _____ | _____ |
| MWERA Lanyard | \$2.00 | _____ | _____ |

TOTAL Materials Costs Enclosed: \$ _____

TOTAL AMOUNT ENCLOSED: \$ _____

The Friday Luncheon is included in the Registration Fee. Please help us plan for the correct number of attendees!

Will you be attending the Friday Luncheon? Yes No Will you require a special menu? Yes No

If YES, please describe: _____

Will you be staying at the Great Southern Hotel? Yes No If YES, circle all that apply: Tue Wed Thu Fri Sat

Make your check or money order payable to "MWERA". **Register before September 24, 2005**, to receive the lowest conference rates! Persons applying for Student Membership must provide proof of student status (copy of a current student ID or registration, or letter from advisor). All presenters must register for the meeting and be a current (2005–2006) member of the Association. New presenters may join using this registration. Mail completed form and payment to:

Dr. Jean Pierce
Northern Illinois University
LEPF Department
DeKalb, Illinois 60115

The Westin Great Southern Hotel Reservation Form

Mid-Western Educational Research Association Meeting

October 12–15, 2005

Your Name: _____
(First Name) (Middle Initial) (Last Name)

Affiliation: _____

Mailing Address: _____

Day Telephone: (_____) _____ E-mail _____

Accommodations Requested

Arrival Date: ____/____/____ Departure Date: ____/____/____

Bed Type: ____ Single (1 King) ____ Double (2 Doubles)

Smoking Preference: ____ Smoking ____ Non-Smoking

Number of People: Rooms based upon availability

- \$120 / Night–Single
- \$120 / Night–Double
- \$130 / Night–Triple
- \$140 / Night–Quad
- \$150 / Night–Single/Double Suite
- \$160 / Night–Triple Suite
- \$170 / Night–Quad Suite

| Graduate Students |
|--|
| Documented Student status only! |
| <input type="checkbox"/> \$97 / Night–Single or Double |
| <input type="checkbox"/> \$107 / Night–Triple |
| <input type="checkbox"/> \$127 / Night–Quad |

**These group rates are only guaranteed UNTIL
SEPTEMBER 24, 2005.**

**BE SURE TO MENTION MWERA WHEN YOU
MAKE YOUR RESERVATIONS.**

Name(s) of Roommate(s) (if any): _____

Special Needs: _____

To confirm your reservation, the hotel requires a first night's deposit or a credit card guarantee.

Method of Payment

- Check or Money Order
- Credit Card (circle to indicate card):
MasterCard Visa American Express
Discover Diners Club

Credit Card Number: _____

Name on Credit Card: _____

Expiration Date: _____

Signature: _____

You must cancel this reservation 72 hours prior to your expected date of arrival and receive a cancellation number to avoid billing on your credit card for the first night's room and tax or the loss of your deposit. The above rates do not include state and local taxes. Automobile parking (valet or self-parking) is available at the hotel for an additional \$20 per day (plus taxes) for registered hotel guests. Check in time is 3:00 pm; check out time is 1:00 pm. On site luggage storage is available for early arrival and late check out. The above group rates are only guaranteed **UNTIL SEPTEMBER 24, 2005.**

**Phone or send completed form and deposit by
mail or fax to:**

**The Westin Great Southern Hotel
310 South High Street
Columbus, OH 43215
(614) 228-3800**

**Reservations only: (800) 228-3000
FAX: (614) 228-7666**

Chronological Listing of Sessions

Wednesday, October 12, 2005

1:00 PM – 6:00 PM MWERA Registration Desk

MWERA allows both pre-registration and on-site registration; however, pre-registration is strongly encouraged. Pre-registrants have the first opportunity to enroll in workshops, to purchase materials, and to attend the luncheon on Friday. Pre-registration is also less expensive! To pre-register for the 2005 Annual Meeting, complete the conference registration form and return it, with your check or money order for payment in full, to Jean W. Pierce, MWERA's Executive Officer.

W.0100.NH Hierarchical Linear Modeling (HLM) Workshop

D: Measurement and Research Methodology — Workshop
Wednesday, 1:00 PM to 4:00 PM — Neil House Parlor

PRESENTER *Rafa M. Kasim, Kent State University*

CO-PRESENTER *Sema A. Kalaian, Eastern Michigan University*

ABSTRACT

This three-hour workshop covers the basics and applications of multilevel modeling via Hierarchical Linear Modeling (HLM). Participants will learn (1) how to conceptualize the basic two-level structured multilevel data, (2) how to analyze multilevel data using the HLM6 software, and (3) how to interpret the HLM6 analysis results. Participants are expected to have a working knowledge of multiple regression using any of the available statistical software (e.g., SPSS, SAS, or Minitab). The instruction for this workshop will consist of lectures, hands-on HLM6 computer experience, and individualized tutorials and consultations.

The workshop covers the following topics:

- Basics of multilevel modeling
- Examples of two-level models
- Multilevel applications using HLM6
- Other HLM applications

Each Participant will be provided with a binder that includes the workshop outline, handouts of how to use HLM6, and HLM6 outputs.

Participants are encouraged to bring their own laptop computers.

FEE: \$150

W.0100.PP Writing and Securing Grants

H: School Evaluation and Program Development — Workshop
Wednesday, 1:00 PM to 3:30 PM — Park Parlor

PRESENTER *Howard D. Walters, Ashland University*

CO-PRESENTER *Sharon A. Valente, Ashland University*

ABSTRACT

The overall objective of the workshop, *Writing and Securing Grants*, is to utilize an organized, focused approach to seek, write, and obtain grant funds. The first part of the presentation will deal with successful grant seeking strategies. The importance of defining your request and creating a list of relevant search terms will be emphasized and modeled on-line. The second part of the workshop will focus on the key elements to writing a successful grant.

Finally, the presenters will conclude with tips for grant writing success from their own experience.

FEE: There is no fee, but attendees are requested to bring their own wireless laptops and procure the hotel's wireless internet connection.

Consider turning your MWERA paper into a *Mid-Western Educational Researcher* manuscript! Refer to the *Call for Manuscripts* on the inside front cover for details on submissions. Information about the MWERA journal and submission processes will also be presented at the workshop, *The Five Ws of Getting Published*, Friday at 10:30 AM in the Chittenden Parlor.

W.0400.PP Focus Group Interview Moderator Training

D: Measurement and Research Methodology — Workshop
Wednesday, 4:00 PM to 6:00 PM — Park Parlor

PRESENTER *Thomas M. Archer, The Ohio State University*

ABSTRACT

One robust qualitative data collection method is the Focus Group Interview (FGI). The basic idea of an FGI is simple: A small group is guided through a pre-thought line of questioning for 1-2 hours by a trained Moderator. The Moderator focuses the discussion on issues of interest to the research. The goal is to give the participants the opportunity to express their ideas/ thoughts/ views. The interaction and stimulation among the people in the group are the biggest advantages. Analysis of gathered information attempts to discern patterns and trends that develop among participants and across Focus Groups. But the role of a Moderator is not easy. A good FGI Moderator possesses skills that are markedly different from other group facilitation. This workshop will highlight the process of FGI research. Detailed skills of high quality FGI Moderators will be discussed/ demonstrated. Guidelines and tips will be shared for completing FGI projects on low budgets and in a variety of settings.

FEE: No charge.

**W.0800.M Fireside Chat and Social
with Dr. Michael Schwartz**

Wednesday, 8:00 PM to 9:30 PM — Great Southern Gallery

CHAIR *Sharon A. Valente, Ashland University*

NOTES *Join Dr. Schwartz for an informal discussion of his new book, *The Chief Purpose of Universities: Academic Discourse and the Diversity of Ideas*. Reception sponsored by Mellen Press.*

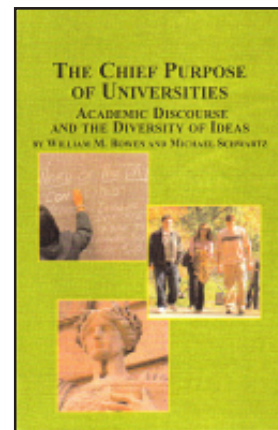

Call for Graduate Student Reviewers

The *Mid-Western Educational Researcher* is a scholarly journal that publishes research-based articles addressing a full range of educational issues. The journal also publishes literature reviews, theoretical and methodological discussions that make an original contribution to the research literature, and feature columns.

The editors seek to support doctoral students in building their vita by adding their names to our growing list of reviewers.

Please e-mail Deborah Bainer-Jenkins at mer@westga.edu for further information.

Thursday, October 13, 2005

8:00 AM – 5:00 PM MWERA Registration Desk

T.0800.CP Improving Learning Through Professional Development for Educators

C: Learning and Instruction — Paper Presentation
Thursday, 8:00 AM to 9:20 AM — Chittenden Parlor

CHAIR *Craig Mertler, Bowling Green State University*

DISCUSSANT *Steve Wallace, Aurora University*

PRESENTATIONS

Identifying Essential Topics in General and Special Education Assessment Textbooks. *Cynthia Campbell, Northern Illinois University, Vicki L. Collins, Northern Illinois University*

Using a test analysis program to improve classroom assessment in the K-12 setting. *Marsha S. Lewis, Ohio University, Gordon Brooks, Ohio University, Mike Nicholson, Battelle for Kids*

Action Research concerning the transfer and application of reflective practices for professional development. *Janet M. Herrelko, University of Dayton, Barbara DeLuca, University of Dayton, Darla Twale, University of Dayton*

T.0800.DP The Mirror of Comparative Analysis in Policy and Practice

L: Educational Policy and Politics — Paper Presentation
Thursday, 8:00 AM to 9:20 AM — Deshler Parlor

CHAIR *Corey Drake, University of Missouri St. Louis*

DISCUSSANT *Virginia Navarro, University of Missouri St. Louis*

PRESENTATIONS

Hypocritical oaths: Gifted, talented, and other exclusionary programs and the ethic of doing harm to children of lower socioeconomic class. *Ashimuneze Heanacho, Central Michigan University*

Comparative Analyses of School Effectiveness: Ohio Public School Districts vs the Community Schools Within The Districts. *Lawrence W. Sherman, Rich Hofmann, Percy Jenkins, Susan Mosley-Howard, Miami University*

Misconnections between Policy and Practice in the Educational Reform in an EFL Context. *Yun-chi Chen, Pennsylvania State University*

Learner Participation & Outcomes: A Comparison Study Between A Community ABE/GED Program And Family Literacy Program In Three Countries: Do Different Strategies Yield Different Results. *William K. Koomson, Pennsylvania State University*

T.0800.HP Self-Perception and Culture: Exploring Their Unique Interrelationship in the Classroom

G: Social Context of Education — Paper Presentation
Thursday, 8:00 AM to 9:20 AM — Hartman Parlor

CHAIR *Camille Clark, Revere High School*

DISCUSSANT *Michelle Partlow, University of Dayton*

PRESENTATIONS

College Teachers! Performances and College Students! Motivation to Learn: A Quantitative Comparison of Graduates and Undergraduates. *Zongmin Kang, University of Toledo, Sema A. Kalaian, Eastern Michigan University*

Intermarriages in Taiwan and Methods of Working with and Educating the Immigrant Females and children. *Min Ju Tsai, Pennsylvania State University*

How different levels of education change students' minds and their perceptions of themselves and the society. *Xiao Qin, Miami University, Diyan Liu, Miami University, Aimin Wang, Miami University*

T.0800.NH Simulations and Online Technology as Learning Tools in Statistics Courses

D: Measurement and Research Methodology — Symposium

Thursday, 8:00 AM to 9:20 AM — Neil House Parlor

CHAIR *David Walker, Northern Illinois University*

DISCUSSANT *Mark A. Earley, Bowling Green State University*

PRESENTATIONS

Simulations and Online Technology as Learning Tools in Statistics Courses. *David Walker, Northern Illinois University, Beverly Dretzke, University of Wisconsin-Eau Claire, Thomas J. Smith, Northern Illinois University, Robert Barcikowski, Ohio University*

T.0800.PP Philanthropy and Educational Reform in the Early Twentieth Century

F: History and Historiography — Symposium

Thursday, 8:00 AM to 9:20 AM — Park Parlor

CHAIR *Joseph Watras, University of Dayton*

DISCUSSANT *Laurie A. Hines, Kent State University - Trumbull Campus*

PRESENTATIONS

Pedro Orata, Fundamental Education and Developing Nations. *Joseph Watras, University of Dayton*
"Invisible Women" of Educational Philanthropy: Flora Rhind and the General Education Board. *Jayne R. Beilke, Ball State University*
Thomas W. Salmon: The National Committee for Mental Hygiene and Progressive Ideas About Children and Youth, 1899 to 1939. *Theresa Richardson, Ball State University*
Micro-Giving and Receiving in the Deep South: The Case of the Albany Bible and Manual Training Institute and the Hazard Family of Rhode Island, 1895 to 1943. *Thomas O'Brien, Ohio State University-Mansfield*

T.0800.S Models for Teacher Preparation

K: Teaching and Teacher Education — Paper Presentation

Thursday, 8:00 AM to 9:20 AM — Seneca Parlor

CHAIR *Francine C. Falk-Ross, Northern Illinois University*

DISCUSSANT *Tracey Stuckey-Mickell, Northern Illinois University*

PRESENTATIONS

Professional Learning Communities and Critically Reflective Practice. *David R. Loe, Kent State University*
Did Undergraduate Students Support A Hybrid Course? *Ni Chang, Indiana University South Bend*
Processing a constructive curriculum: Breaking Down and Building Up. *Hema Ramanathan, Butler University*
A model approach to pre-service teacher efficacy. *James A. Freeman, III, Ohio State University*

T.0800.TC Expanding Services to Reach More Students

H: School Evaluation and Program Development — Paper Presentation

Thursday, 8:00 AM to 9:20 AM — Thurber Conference Suite

CHAIR *Amanda Rovnak, University of Akron*

DISCUSSANT *Russell C. Brown, Cleveland Municipal School District*

PRESENTATIONS

Broadening the Roles of School Psychologists through an Evaluation of Learning Environments: A Pilot Study. *Jessica K. Faulkner, Kelly D. Bradley, University of Kentucky*
Parents' Perceptions of Ideal After-School Programs. *Chia-Shen Shen, Huei-Ling Wang, Pennsylvania State University*

Call for Manuscripts

The *Mid-Western Educational Researcher* is a scholarly journal that publishes research-based articles addressing a full range of educational issues. The journal also publishes literature reviews, theoretical and methodological discussions that make an original contribution to the research literature, and feature columns.

Submit manuscripts or obtain a complete version of the *Call for Manuscripts* by contacting Deborah Bainer-Jenkins, Co-editor, at mer@westga.edu.

T.0930.GB Keynote Address

MWERA — Alternative Session
Thursday, 9:30 AM to 10:20 AM — Grand Ballroom
Sharon A. Valente, Ashland University

CHAIR

PRESENTATION

Michael Schwartz
Cleveland State University
***The Chief Purpose of Universities:
Academic Discourse and the Diversity of Ideas***



From the Foreword: "...Bowen and Schwartz also understand the importance of science and technology in the university. They decry the dilution of the curriculum and of teaching loads for senior faculty, which result in students getting less education in science and technology than they once did.... As the authors concede, political correctness was born of legitimate concerns, but it has spun out of control. Their critics will argue that excesses are rare and minor. Bowen and Schwartz are right, though, that political correctness pervasively chilled academic discourse and inquiry. Such intolerance spreads unless schools affirmatively defend academic freedom. Sadly, administrators fearing personal criticism often cave in to the demands of political correctness.... No treatise can dramatically alter higher education. The interests threatened by maximizing the variation of ideas will not be won over by any argument, however rational and cogent it may be. But this volume will inform those who care about the public interest and perhaps inspire them to help defend our embattled universities." — Dr. George W. Dent, Jr., Schott-van den Eynden Professor of Law, Case School of Law

Schwartz was unanimously selected as President of Cleveland State University by the Board of Trustees on November 13, 2001, after serving six months as Interim President. Recently, he agreed to serve through at least June 2008. Dr. Schwartz came to Cleveland State from Kent State, where he is President Emeritus and Professor Emeritus.

Schwartz has published in the area of social psychology of adolescent deviant behavior and with Sheldon Stryker, was the author of the first monograph published by the American Sociological Association in the Arnold and Carolyn Rose Monograph Series. He has authored numerous articles on higher education issues. He has served as a trustee of the Northeastern Ohio Universities College of Medicine and Central State University. He is a member of the North Central Association of Colleges and Schools' consultant- evaluator corps and its Accreditation Review Council. He also has served on the Association of Governing Boards' Commission on Strengthening the Academic Presidency. He was named Distinguished Alumnus of the Institute of Labor and Industrial Relations at the University of Illinois in Champaign-Urbana. Youngstown State University awarded him a Honorary Doctor of Laws Degree, and the American Association of State Colleges and Universities has given him its Distinguished Service Award.

T.1030.CP Follow-Up Discussion From the Keynote Address

MWERA — Alternative Session
Thursday, 10:30 to 11:50 AM — Chittenden Parlor
Sharon A. Valente, Ashland University

CHAIR

NOTES

This is a follow-up session for Dr. Schwartz's address. There will be opportunities to pose questions and interact with Dr. Schwartz.

T.1030.DP Challenges to Academic Development

E: Counseling and Human Development — Paper Presentation
Thursday, 10:30 AM to 11:50 AM — Deshler Parlor

CHAIR

DISCUSSANT

PRESENTATIONS

Tom Cody, Western Illinois University
Doug Feldmann, Northern Kentucky University

The effect of comorbid AD/HD + LD on academic and behavioral outcomes. *Thomas J. Smith, Northern Illinois University, Gail Adams, Northern Illinois University*

Television Viewing: Its Impact on Obesity and the Age of Onset of Menarche. *Bonnie E. Tandoc, Wichita State University, Linda Bakken, Wichita State University, Christy Calvert, Wichita State University*

The Effect of School Type on the Domain-Specific Self-Concept and Global Self Esteem of Early Adolescents: An Observation of Schools in Rural Southeast Kansas. *Dale R. May, Pittsburg State University*

Peer relationships between hearing and deaf/hard-of-hearing students in public secondary schools with inclusive programs. *Hsin-Ling Hung, Ohio State University*

T.1030.HP Perceptions of International Students and Faculty

G: Social Context of Education — Paper Presentation
Thursday, 10:30 AM to 11:50 AM — Hartman Parlor

CHAIR *Cathy M. Spidell, University of Akron*

DISCUSSANT *Mary E. Lavin Crerand, Ashland University - Columbus Center*

PRESENTATIONS

Voices of Korean High School Teachers. *Myung-sook Koh, Eastern Michigan University, Sunwoo Shin, Eastern Michigan University*

Constraints on international students' identities imposed by a second-language environment. *Min-Hua Hsieh, Northern Illinois University*

Age Differences in School-Aged Chinese Students' Self-Perception. *Jianxiang Yang, Miami University, Mingzhu Xia, Miami University, Aimin Wang, Miami University*

T.1030.M New Member Welcome

MWERA — Alternative Session

Thursday, 10:30:00 AM to 11:50:00 AM — Great Southern Gallery

CHAIR *Craig Mertler, Bowling Green State University*

NOTES *All new and existing MWERA members are invited to this new member welcome session. Come and meet each other and get to know first-hand what MWERA collegiality is all about!*

T.1030.NH TQP Preservice Survey: Development, Implementation and Results

D: Measurement and Research Methodology — Symposium

Thursday, 10:30 AM to 11:50 AM — Neil House Parlor

CHAIR *William E. Loadman, The Ohio State University*

PRESENTATIONS

TQP Preservice Survey: Development, Implimentation and Results. *Wiliam E. Loadman, The Ohio State University, Kevin Loy, Ohio State University, James Freeman, Ohio State University, Yonghee Kim, Ohio State University, Dirk Richter, Ohio State University, Rael Moore, Ohio State University*

T.1030.PP Trends for Leadership

A: Administration — Paper Presentation

Thursday, 10:30 AM to 11:50 AM — Park Parlor

CHAIR *Charles Kline, Purdue University*

DISCUSSANT *Tim Ilg, University of Dayton*

PRESENTATIONS

Practicing Scholarly Partnerships: Educators from the University and K-12 Researching Together. *Glenda C. Moss, Indiana University Purdue University Fort Wayne, Barry Kanpol, Indiana University Purdue University Fort Wayne, Jeff Abbott, East Allen County Schools, Kathleen Murphey, Indiana University Purdue University Fort Wayne, Joe Nichols, Indiana University Purdue University Fort Wayne, Kevin Kempton, Smith-Green Community Schools, Terry Springer; Fort Wayne Community Schools*

A Call to Action: The Moral Imperative in School Leadership. *Frederick C. Buskey, Putnam County Educational Service Center, Mark Earley, Bowling Green State University*

Institutionalizing Service Learning in Higher Education: Change or Not to Change. *Paula K. Reams, University of Dayton*

T.1030.S Data to Inform School Decision Making Processes

H: School Evaluation and Program Development — Paper Presentation

Thursday, 10:30 AM to 11:50 AM — Seneca Parlor

CHAIR *Roger J. Goudy, South Euclid-Lyndhurst Schools*

DISCUSSANT *John Fraas, Ashland University*

PRESENTATIONS

Using the Illinois Interactive Report Card to Select Control Schools for a Teacher Quality Enhancement Grant. *David Walker, Northern Illinois University*

Collecting Data for a School District's Community Survey: Are School Districts Collecting Usable Data: A Case Study. *John Ewing, The Ohio State University, M. Susie Whittington, The Ohio State University*

T.1030.TC Using Technology in the Classroom for Assessment and Instruction

K: Teaching and Teacher Education — Paper Presentation
Thursday, 10:30 AM to 11:50 AM — Thurber Conference Suite

CHAIR *David Loe, Chardon High School*

DISCUSSANT *Rafa Kasim, Kent State University*

PRESENTATIONS

Computer Education in Ghanaian Schools. *Sandra V. Turner, Ohio University*

Teacher preparation of ECE Teachers for Science Competencies in Korea. *Yang Eun Kim, Pennsylvania State University*

Teacher Perceptions as an Integral Component in the Development of On-Line Learning Tools. *Jessica D. Cunningham, University of Kentucky, Kelly D. Bradley, University of Kentucky.*

Media and Middle Level Literacy Lessons: Case Studies in Action Research. *Francine C. Falk-Ross, Northern Illinois University*

T.1200.GB MWERA Association Council Meeting

MWERA — Meeting
Thursday, 12:00:00 PM to 1:30:00 AM — Grand Ballroom

CHAIR *Janet Holt, Northern Illinois University*

DISCUSSANT *Rodney J. Greer, Western Illinois University*

PRESENTATIONS

NOTES *All MWERA Association Council Members and MWERA Officers should attend. Luncheon will be served.*

T.0140.CP Issues in Reliability

D: Measurement and Research Methodology — Paper Presentation
Thursday, 1:40 AM to 3:00 AM — Chittenden Parlor

CHAIR *Kelly D. Bradley, University of Kentucky*

DISCUSSANT *Ayres G. D'Costa, Ohio State University*

PRESENTATIONS

A Comparison of the Spearman-Brown and Flanagan-Rulon Formulas for Split-Half Reliability under Various Variance Parameter Conditions. *David Walker, Northern Illinois University*

Reliability Estimation in Item Response Theory. *Tianli Li, Michigan State University*

Comparison of Parametric Methods to Examine Reliability in Sequential Delphi Surveys. *Hiral A. Shah, Eastern Michigan University, Sema A. Kalaian, Eastern Michigan University*

The History and Development of Cohen's Kappa as a Means of Establishing Interrater Reliability for Nominal/Qualitative Data. *John L. Rausch, John Carroll University*

T.0140.DP Education and the Struggle for African American Education during the 1960s and 1970s in Two Northern Cities in the Delaware Valley: Philadelphia and Camden

F: History and Historiography — Symposium
Thursday, 1:40 PM to 3:00 PM — Deshler Parlor

CHAIR *Matthew Davis, Rowan University*

DISCUSSANT *Kim Kit Holder, Rowan University*

PRESENTATIONS

African American Studies and its Relationship to the Surrounding Community. *Patrick Spearman, Rowan University*

"Fire-Bell in the Night": The Revolution at Rutgers South Jersey, 1969. *Laurie Lahey, George Washington University*

The Struggle for School Desegregation in Philadelphia: Mayor Frank Rizzo is the Issue, 1967-1981. *Anne E. Phillips, Rowan University*

T.0140.HP Investigations in Technology and Learning

C: Learning and Instruction — Paper Presentation
Thursday, 1:40 PM to 3:00 PM — Hartman Parlor

CHAIR *Angie Stuckey, Northern Illinois University*

DISCUSSANT *Tracey Stuckey-Mickell, Northern Illinois University*

PRESENTATIONS

The Role of Technology Coordinators as Leaders in Technology Integration. *Judith N. Oberlander, University of Dayton, Carolyn Talbert-Johnson, University of Dayton*

Electronic and Traditional Print Text: Student Preference, Effort, and Achievement in Writing Expository Papers. *Courtney A. Farrell, The University of Iowa, Kathy L. Schuh, The University of Iowa*

Modeling Teachers' Use of Computer Technology in K-12 Classrooms. *Dipendra R. Subedi, Michigan State University*

Improving the Learner's Experience With Technology Driven Learning Solutions. *Kellye L. Guidry, Northern Illinois University*

T.0140.NH Division Meeting

L: Educational Policy and Politics — Meeting
Thursday, 1:40 PM to 3:30 PM — Neil House Parlor

CHAIR *Kathleen Brown, University of Missouri St. Louis*

DISCUSSANT *James E. Murray, University of Missouri St. Louis*

INVITED ADDRESS

*The Honorable Bill Harris
President of the Ohio Senate*

*Ohio's FY06-07 Budget:
Primary, Secondary, and Higher Education*



T.0140.PP Facilitating Stimulating Case Study Discussions

C: Learning and Instruction — Workshop
Thursday, 1:40 PM to 3:00 PM — Park Parlor

PRESENTER *Mary R. Sudzina, University of Dayton*

ABSTRACT

Case studies are being increasingly integrated into teacher preparation programs. This increase appears to be in response to the need for preservice teachers to be exposed to case studies in preparation for the Praxis II: Principles of Learning and Teaching Test, which is case-based. Instructors who have experienced traditional, teacher-centered instruction are looking for ways to apply case studies, a constructivist, student-centered approach to teaching and learning, in their courses. Workshop highlights include: a 5-step process for case analysis; 20 techniques for facilitating case discussions; and, a video of a case discussion in progress in which those techniques are demonstrated and modeled.

FEE: No charge.

T.0140.S Division Meeting

G: Social Context of Education — Meeting
Thursday, 1:40 PM to 3:00 PM — Seneca Parlor

CHAIR *Aimin Wang, Miami University*

DISCUSSANT *Mark S. Brown, Eastern Illinois University*

INVITED ADDRESS

*William M. Bowen
Cleveland State University
The University and Its Enemies:
Social and Economic Implications
of the Idea Variation Hypothesis*



T.0140.TC Effective and Ineffective Metacognitive Knowledge Monitoring in Post-Secondary Education

J: Postsecondary Education — Workshop
Thursday, 1:40 PM to 3:40 PM — Thurber Conference Suite

PRESENTER *Randy M. Isaacson, Indiana University South Bend*

ABSTRACT

One of the most frustrating teaching dilemmas in post-secondary education is helping students who claim to have mastered the course content but are unable to demonstrate their understanding. These students are often convinced they have a command of the material and may even be able to persuade their instructor that their failure is due to the test. But instructors who carefully questions these students realize these students have not mastered the material. This workshop will report on research from the last decade on metacognitive knowledge monitoring and present a program that teaches both self-regulated learning and metacognition. Over the past five years the author has researched the relationship between metacognitive knowledge monitoring and classroom learning and has developed a program in his educational psychology class which compels student to self-regulate their learning and develop skills in metacognitive knowledge monitoring.

FEE: No charge.

T.0310.CP Diversity Issues in Higher Education

J: Postsecondary Education — Paper Presentation
Thursday, 3:10 PM to 4:30 PM — Chittenden Parlor

CHAIR *Eric Mansfield, Western Illinois University*

DISCUSSANT *Tom Cody, Western Illinois University*

PRESENTATIONS

Campus Climate for Diversity. *Lawrence J. Mrozek, The Ohio State University, Barbara I. Wharton, The Ohio State University*

Orientation and Minority Student Retention. *Dustin C. Derby, Northern Illinois University*

The influence of gender awareness on ESL communication in a cross-cultural context. *Ling-Miao Yeh, The Ohio State University*

An Exploratory Study of the Experiences of Mexican American Women Attending Community College. *Diane P. Sarther, Northern Illinois University*

T.0310.DP Division Meeting

C: Learning and Instruction — Meeting
Thursday, 3:10 PM to 4:30 PM — Deshler Parlor

CHAIR *Tracey Stuckey-Mickell, Northern Illinois University*

INVITED ADDRESS

Greg Montalvo

Western Illinois University

Online Design Elements: Improving Student Success and Minimizing Instructor Load

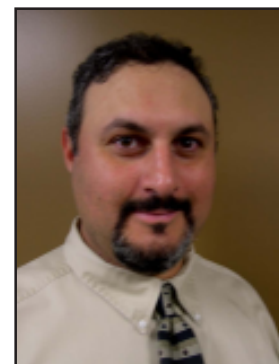

T.0310.GB Roundtables and Posters

C: Learning and Instruction and D: Measurement and Research
Methodology — Roundtable Discussion/Poster
Thursday, 3:10 PM to 4:30 PM — Grand Ballroom

PRESENTATIONS

TABLE 1 The Importance of Anchor Item Selection for Accuracy of Equating in Test Adaptation. *Hua G. Senteney, Ohio University*

TABLE 2 Do Cohort Groups Promote Student Feelings of Success? A Correlation Study. *Mark A. Clark, Illinois State University, Nancy Gardner, Illinois State University, Carolyn Koos, Illinois State University, Scott Laird, Illinois State University, John Rugutt, Illinois State University*

TABLE 3 Identifying Ways to Enhance Students' Successes in the Classrooms and Beyond. *Thomas S. Parish, Upper Iowa University, Joycelyn Gay Parish, Upper Iowa University, Kenneth Adderley, Upper Iowa University*

(Listing continued on next page)

- TABLE 4 What motivates Chinese students to achieve better academically than their American peers? *Qingling Yang, Cleveland State University*
- TABLE 5 Teacher Perceptions of Student Behavior. *Joshua M. Englehart, Cleveland State University*
- TABLE 6 The Circularity of Goals and Personal Standards. *Angeline Stuckey, Northern Illinois University*
- TABLE 7 Personal Epistemology and the constructivist metaphor: An alternative. *Paul J. Wendel, Kent State University*
- TABLE 8 Concept Map as a Tool to Display Mathematical Knowledge. *Feiye Yew, The Ohio State University*
- TABLE 9 The influence of a student-designed rubric for self-assessment of a 6th grade writing activity. *Dan C. McGuire, Northern Illinois University, Jean Pierce, Northern Illinois University*
- TABLE 10 Elite or Mass education: A continuing tension in educational policy making in socialist China since 1949. *Guofang Yuan, Cleveland State University*

T.0310.HP Division Meeting

B: Curriculum Studies — Meeting
 Thursday, 3:10 PM to 4:30 PM — Hartman Parlor

CHAIR *Bruce W. Jones, Notre Dame College*
 DISCUSSANT *Doug Feldmann, Northern Kentucky University*
 INVITED ADDRESS

Doug Feldmann
Northern Kentucky University
Curriculum and Community Involvement



T.0310.NH Assessment of Learning in Preservice Teachers

D: Measurement and Research Methodology — Paper Presentation
 Thursday, 3:10 PM to 4:30 PM — Neil House

CHAIR *Gibbs Y. Kanyongo, Duquesne University*
 DISCUSSANT *Rich Hofmann, Miami University*
 PRESENTATIONS

- The Impact of Classroom Assessment Training on Teachers' Assessment Literacy. *Craig A. Mertler, Bowling Green State University*
- Psychometric Evaluation of the Assessment of Learner-Centered Practices. *Mark A. Earley, Bowling Green State University, Ron Skidmore, Morehead State University, Dan Fasko, Bowling Green State University*
- Validation of the Assessment Literacy Inventory (ALI) With Preservice Teachers. *Cynthia Campbell, Northern Illinois University, Craig A. Mertler, Bowling Green State University*
- Measuring Teacher Candidates Beliefs, Knowledge and Expectation about Diversity. *Xin Liang, University of Akron, Kay Alderman, University of Akron, Susan Colville-Hall, Cathryn Chappell, University of Akron*

T.0310.PP Leadership Issues

A: Administration — Paper Presentation
 Thursday, 3:10 PM to 4:30 PM — Park Parlor

CHAIR *Carla Edlefson, Ashland University*
 DISCUSSANT *Anne Christo-Baker, University of Toledo*
 PRESENTATIONS

- A Profile of Educators Who Use Baldrige: A Learning and Improvement Framework. *Judith A. Zimmerman, Bowling Green State University*
- Parental Involvement Factors That Influence High School Student Achievement. *Ovella V. Roulette-McIntyre, Cleveland State University*

T.0310.S Division Meeting

E: Counseling and Human Development — Meeting
Thursday, 3:10 PM to 4:30 PM — Seneca Parlor

CHAIR *John Laux, University of Toledo*

DISCUSSANT *Andrew Burck, University of Toledo*

INVITED ADDRESS

Andrew Burck and Jean Roberts

University of Toledo

The Road Less Traveled:

How to Make a Difference in Your Doctoral Studies

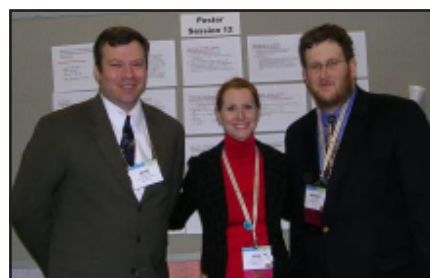
**T.0310.TC Faculty Issues in Academic Integrity**

H: School Evaluation and Program Development — Alternative Session
Thursday, 3:10 PM to 4:30 PM — Thurber Conference Suite

CHAIR *Oscar T. McKnight, Ashland University*

INVITED PANEL

Oscar T. McKnight, Ashland University, Robert Suggs, Ashland University, Scott Quade, Medina High School, Marc Cutright, Ohio University

NOTES Come join the dialogue centering on a neglected role in the academic integrity debate, the faculty. Panel members represent a cross-section of administration and faculty in the K-12 and higher education communities.

T.0440.CP Analyzing Test Items

D: Measurement and Research Methodology — Paper Presentation
Thursday, 4:40 PM to 6:00 PM — Chittenden Parlor

CHAIR *Jerry Obiekwe, University of Akron-Wayne College*

DISCUSSANT *Gordon Brooks, Ohio University*

PRESENTATIONS

An IRT Approach to Validation of Cognitive Operations for Test Items. *Dimiter M. Dimitrov, George Mason University*

Validating an Assessment through Rasch techniques: The process of measurement, feedback, reflection, and change. *Shannon O. Sampson, University of Kentucky, Kelly D. Bradley, University of Kentucky, Jaclyn W. Babcock, University of Kentucky*

Investigating the Effect of Multidimensionality on Unidimensionality-Based DIF Analyses. *Sungwon Ngudgratoke, Michigan State University*

Ideal Item Pool Design for a Stratified Adaptive Testing. *Wei He, Michigan State University, Mark D. Reckase, Michigan State University*

T.0440.DP Processes of Life: Jobs, Satisfaction, and Learning

I: Education in the Professions — Paper Presentation
Thursday, 4:40 PM to 6:00 PM — Deshler Parlor

CHAIR *Catherine Marsh, North Park University*

DISCUSSANT *LeAnn Derby, Air Force Academy*

PRESENTATIONS

Hurry, Hurry, Beam Me Up Scotty: Implications of Trinity Paradigm of Intelligence in Developing a Culture of Integrity. *Masoud Ghaffari, East Tennessee State University*

Differences in Satisfaction of Nurses related to Career Track Choice. *Joan L. Frey, Aultman College of Nursing and Health Sciences*

The Application of Adult Education Principles to Teaching Doctors How to Better Listen to and Communicate with Patients. *Frank R. DiSilvestro, Indiana University*

Job Satisfaction and Organizational Commitment of Ohio State University Extension Educators. *Larry E. Miller, Ohio State University, Jessica M. Fontana, Ohio State University*

T.0440.GB MWERA Member Authors

MWERA — Alternative Session
Thursday, 4:40 PM to 6:00 PM — Grand Ballroom

PRESENTATIONS

- TABLE 1 Doug Feldmann, Northern Kentucky University: *Curriculum and the American Rural School*, University Press
- TABLE 2 Craig A. Mertler, Bowling Green State University: *Action Research: Teachers as Researchers in the Classroom*, Sage Publications; and more!
- TABLE 3 Mary Sudzina, *Case Study Applications for Teacher Education*, A. B. Longman; *Teaching and Learning with Case Studies*, Insight Media

NOTES Come hear our member authors discuss their books. Get your very own autographed copy!

T.0440.HP Building Leaders, Building Schools, and Building a Sense of Community

L: Educational Policy and Politics — Paper Presentation
Friday, 1:40 PM to 3:00 PM — Hartman Parlor

CHAIR *Joy Matthews-Lopez, Ohio University*

DISCUSSANT *James E. Murray, University of Missouri St. Louis*

PRESENTATIONS

- Ohio's New Leadership Standards: Redefinition or Policy Alignment. *Kathleen T. Jorissen, Bowling Green State University, Julie Edmister, Bowling Green State University*
- The Ohio School Facilities Commission & Ohio's Constitutional Crisis, 1997-2005. *Guy L. Parmigian, Miami University*
- The Development of an Educational Paradox Index and Its Meaning. *Rich Hofmann, Miami University*

T.0440.NH Factors in Teacher Preparation

K: Teaching and Teacher Education — Paper Presentation
Thursday, 4:40 PM to 6:00 PM — Neil House Parlor

CHAIR *Hema Ramanathan, Butler University*

DISCUSSANT *Cathryn Crosby, The Ohio State University*

PRESENTATIONS

- The Influence of Initial Teacher Preparation on Teacher Efficacy. *Dirk Richter, Ohio State University*
- A University Assessment System for Teacher Education: What Do We Really Need to Know? *Beverly M. Klecker, Morehead State University*
- Preparing Teachers to Become Highly Qualified. *Carolyn Talbert-Johnson, The University of Dayton, Judith Oberlander, ITTEL, Tamela Dixon, Tiffin College*
- Case Studies of Four Universities Approaches to Organizing Student Teaching Experiences. *Thomas S. Haynes, Illinois State University, Weirong Wang, Illinois State University, Lori McCoy, Illinois State University*

T.0440.PP Faculty Issues

J: Postsecondary Education — Paper Presentation
Thursday, 4:40 PM to 6:00 PM — Park Parlor

CHAIR *Jeff Ritchey, Pennsylvania State University*

DISCUSSANT *Greg Montalvo, Western Illinois University*

PRESENTATIONS

- Grade Inflation: The Role of the Vietnam Draft at the University of Kansas. *Sylvia L. Martinez, University of Kansas*
- Out of the Loop: Adjunct Faculty in Schools of Education. *Naomi Jeffery Petersen, Indiana University South Bend, Barbara Garii, SUNY Oswego*
- Non-Instructional Factors Influencing Job Satisfaction of Department Chairs in American Colleges and Universities. *Paul M. Madden, Ohio University, Valerie Martin Conley, Ohio University*
- Faculty Beliefs about Grades and Grade Inflation: Pilot Study. *Terri L. Lane, University of Dayton*

T.0440.S Student Member Meeting

MWERA — Meeting
Thursday, 4:40 PM to 6:00 PM — Seneca Parlor

CHAIR *Kelly D. Bradley, University of Kentucky*

NOTES *After Andrew and Jean's scintillating presentation at T.0310.S on surviving doctoral studies, stay in the Seneca Parlor for this session devoted to students. All new and existing MWERA student members are invited. Come and meet fellow students. Learn to make the most of your MWERA membership!*

**T.0440.TC Exploring Diversity Issues in the Classroom and In Society:
Broadening our Cultural-Familial Awareness**

G: Social Context of Education — Paper Presentation
Thursday, 4:40 PM to 6:00 PM — Thurber Conference Suite

CHAIR *Steve Corfman, Antioch College*

DISCUSSANT *Doris Bergen, Miami University*

PRESENTATIONS

Personal Epistemology and Culture. *Heath Marrs, Fort Hays State University*

An exploration of factors related to the decline in black marriages. *William Harris, Jr., University of Kentucky, Kelly D. Bradley, University of Kentucky*

Diversity Study Circles in Teacher Education Practice: A Critical Experiential Learning Project. *Glenda C. Moss, Indiana University Purdue University Fort Wayne, Christine Patterson, Indiana University Purdue University Fort Wayne*

The Impact of Teacher/Student Gender Congruency on Mathematics Anxiety. *Pamela C. Charity, Cleveland State University, Yvette N. Daugherty, Cleveland State University, Joshua G. Bagakas, Cleveland State University*

T.0600.M Cracker Barrel Social

MWERA—Alternative Session
Thursday, 6:00 PM to 8:00 PM — Great Southern Gallery

NOTES *Come and join us for some fun! Hors d'oeuvres and cash bar.*

Call for Papers

**Advocating for African American Students:
Cultural Perspectives on Best Practices**

Our research on African American women teachers provides insights on how teachers have historically made and currently make valuable contributions to students lives while offering significant insights on how best to reach African American children. The voices of African American are at best, rarely heard in the teacher education and best practices literature, and thus, commonly marginalized in larger conversations of improving the academic performance of African Americans and other children of color.

This special edition is intended to instead, expand examples of best practices articulated through racial/ethnic, cultural, and familial frameworks. We are seeking papers that present principles of practice situated in research, narratives of classroom practices, and theory.

Manuscripts are due by December 1, 2005, to the editors:

Adrienne D. Dixon, The Ohio State University, dixon.1@osu.edu and
Jeannine E. Dingus, University of Rochester, jdingus@its.rochester.edu

Friday, October 14, 2005

F.0700.HP Division Chair and Co-Chair Breakfast

MWERA — Meeting

Friday, 7:00 AM to 7:50 AM — Hartman Parlor

NOTES

All 2005 Division Chairs and Co-Chairs are invited to a continental breakfast as MWERA's way of expressing our sincere gratitude for their hard work on the 2005 program.

8:00 AM – 5:00 PM MWERA Registration Desk

F.0800.CP Factors Affecting Students' Success in the Classroom

K: Teaching and Teacher Education — Paper Presentation

Friday, 8:00 AM to 9:20 AM — Chittenden Parlor

CHAIR

Glenda Moss, Indiana University Purdue University Fort Wayne

DISCUSSANT

Deborah D. Webster, Cleveland State University

PRESENTATIONS

Impact of the Arts on Children's School Readiness Skills. *Ruslan Slutsky, University of Toledo, Mahpara Siddiqui, Project ABC, Stacey Pistorova, University of Toledo*

Service Learning as a Bridge Between Theory and Practice in Literacy. *Susan Z. Turner, University of Akron, Jennifer Bozeka, University of Akron*

Benefits of Parent Involvement in the Education for Young Children. *Ali K. Tekin, Pennsylvania State University*

F.0800.DP The Superintendency

A: Administration — Paper Presentation

Friday, 8:00 AM to 9:20 AM — Deshler Parlor

CHAIR

Ted Zigler, University of Cincinnati

DISCUSSANT

Carla Edlefsen, Ashland University

PRESENTATIONS

Profile of First-Time Ohio Superintendents: Characteristics and Dispositions toward Preparation and Licensing. *Theodore J. Kowalski, University of Dayton*

Impact of New Board Member Orientation on Effective School Governance: School Board - Superintendent Relations. *Charles E. Kline, Purdue University, Brent A. Wilson, Purdue University*

F.0800.HP Division Chairs and Co-Chairs

MWERA — Meeting

Friday, 8:00 AM to 9:20 AM — Hartman Parlor

CHAIR

Janet K. Holt, Northern Illinois University

DISCUSSANT

Sharon A. Valente, Ashland University

NOTES

All 2005 Division Chairs and Co-chairs are encouraged to attend.

F.0800.NH Exploring the Effective Use of Technology as a Tool for Expanding a Student's Knowledge and Facilitating Peer Social Interaction

G: Social Context of Education — Paper Presentation

Friday, 8:00 AM to 9:20 AM — Neil House Parlor

CHAIR

Mark S. Brown, Eastern Illinois University

DISCUSSANT

Steven Corfman, Antioch College

PRESENTATIONS

Instructional technology research: reviewing the definition and role of technology. *David R. Moore, Ohio University*

Non-native speakers of English in U.S. classrooms: Their classroom interaction within classroom and in cyberspace. *Mikyung Baek, The Ohio State University*

Calling All Bloggers! Engaging Student Writers With Technology. *Cathy M. Spidell, University of Akron*

How unhealthy internet content as well as education and family environment have influenced juvenile delinquency. *Diyan Liu, Miami University, Xiao Qin, Miami University, Aimin Wang, Miami University*

F.0800.PP Division Meeting

D: Measurement and Research Methodology — Meeting
Friday, 8:00 AM to 9:20 AM — Park Parlor

CHAIR *Gordon Brooks, Ohio University*

DISCUSSANT *Sema Kalaian, Eastern Michigan University*

INVITED ADDRESS

Mark A. Earley

Bowling Green State University

Improving Statistics Education:

Can We Collaborate with Faculty in Other Departments?

F.0800.S Americanization, Sport and Oral History

F: History and Historiography — Paper Presentation
Friday, 8:00 AM to 9:20 AM — Seneca Parlor

CHAIR *Sandra Spickard-Prettyman, University of Akron*

DISCUSSANT *Mary Zahner, University of Dayton*

PRESENTATIONS

The women's marathon: Lessons in history for the sports scientist. *Jon K. Linderman, University of Dayton, Julia M. Erbacher, University of Dayton*

The Influence of Lilian G. Katz on Early Childhood Education: An Oral History. *Lauren A. Wellen, Concordia University*

Hawaiian Female Education in the Service of American Hegemony during the 19th Century. *Carl K. Beyer, Concordia University*

Learning to be American: Slovenian Immigrant Women and Education. *Marlene E. Gombach, Cleveland State University*

F.0800.TC Measuring Learning

H: School Evaluation and Program Development — Paper Presentation
Friday, 8:00 AM to 9:20 AM — Thurber Conference Suite

CHAIR *Russell C. Brown, Cleveland Municipal School District*

DISCUSSANT *David O. Newman, Cleveland State University*

PRESENTATIONS

On the Question of Gender Difference in the Construct Validation of the 1985 Version of Kolb's Learning Style Inventory. *Jerry Obiekwe, The University of Akron-Wayne College*

The role of critical thinking in the learning of physics concepts. *Susan E. Ramlo, The University of Akron*

Managerial Competency Assessment of MBA Students. *Carol L. Pietrasz, Ashland University, John W. Fraas, Ashland University*

F.0930.GB MWERA Business Meeting

MWERA — Meeting

Friday, 9:30 AM to 10:20 AM — Grand Ballroom

CHAIR *Janet Holt, Northern Illinois University*

DISCUSSANT *Rodney J. Greer, Western Illinois University*

NOTES *Nominations for next year's officers and general business will be addressed.*

F.1030.CP The Five Ws of Getting Published

K: Teaching and Teacher Education — Workshop
Friday, 10:30 AM to 11:50 AM — Chittenden Parlor

PRESENTER *Deborah Bainer Jenkins, University of West Georgia*

ABSTRACT

Everyone can be effective at scholarship once they consider the five Ws of publishing. Prospective writers need to decide WHAT they'll write about, WHO they'll target with their manuscript, WHEN they work best on scholarship, WHERE they will submit their manuscript, and WHY they want to publish at all. This interactive workshop aims to answer questions commonly posed by would-be publishers, and to inspire participants to take action in setting concrete goals and becoming published. Information about the MWERA journal and submission processes will also be presented.

FEE: No charge.

F.1030.DP Curriculum Studies in Multiple Field-Based Contexts

B: Curriculum Studies — Paper Presentation

Friday, 10:30 AM to 11:50 AM — Deshler Parlor

CHAIR *Bruce W. Jones, Notre Dame College*

DISCUSSANT *Charlotte G. Andrist, Educational Consultant and Language-Learning Tutor*

PRESENTATIONS

Looking at Israel Through a Scientific Lens. *Eugenia S. Johnson-Whitt, University of Akron, Carole Newman, University of Akron*

The Cross-Cultural Literary Canon: Gender roles in the Curriculum of India and Canada. *Abigail Parker, Butler University, Hema Ramanathan, Butler University*

The State of Civics Education in the High Schools. *Doug Feldmann, Northern Kentucky University*

The effect of science context based curriculum in language development of k-graders. *Yang Eun Kim, Pennsylvania State University*

F.1030.HP Issues in Post-Secondary Education

J: Postsecondary Education — Paper Presentation

Friday, 10:30 AM to 11:50 AM — Hartman Parlor

CHAIR *Selma Vonderwell, Cleveland State University*

DISCUSSANT *Mark Magnuson, Ivy Tech State College – Central Indiana*

PRESENTATIONS

Organizing Anarchy: A Case Study of Using Cohen and March to Affect Institutional Change. *Marc Cutright, Ohio University, J. Malcolm Smith, Ohio University*

Student financial access to public higher education, 1974-2004. *Paul Vogt, Illinois State University, Edward Hines, Illinois State University, Ross Hodel, Illinois State University, Chris Mushrush, Illinois State University*

Evaluating KCTCS Teacher Attitudes and Perceptions Regarding Student Outcomes by Examining Teacher Educational Background and Self-Classification Within Hard and Social Sciences. *Jennifer A. Eli, University of Kentucky, Kenneth D. Royal, University of Kentucky, Kelly D. Bradley, University of Kentucky*

Personal Coping Resources to Prevent Stress and Burnout Among Teachers. *M. Susie Whittington, Ohio State University, Jaime Chenevey, West Holmes High School*

F.1030.NH Enhancing Reading Achievement: Research on Parental and Classroom Initiatives

C: Learning and Instruction — Paper Presentation

Friday, 10:30 AM to 11:50 AM — Neil House Parlor

CHAIR *Tracey Stuckey-Mickell, Northern Illinois University*

DISCUSSANT *Angie Stuckey, Northern Illinois University*

PRESENTATIONS

What parents do in the home and community that influences their child's reading. *Tasha M. Almond, Northern Illinois University, Janet K. Holt, Northern Illinois University*

Why Ask Why?: An Evaluative Study of the Use of Higher-Level Questions with Kindergarten Students in Reading and Their Effect on Reading Comprehension. *Gail L. Bradach, Notre Dame College of Ohio*

The Effects of Total Class Peer Tutoring on Sight-Word Acquisition, Maintenance, Reading Fluency and Comprehension of Students at Risk for Reading Failure. *Lefki Kourea, Ohio State University, Gwendolyn Cartledge, Ohio State University*

F.1030.PP Learning Outside the Traditional Classroom

G: Social Context of Education — Paper Presentation

Friday, 10:30 AM to 11:50 AM — Park Parlor

CHAIR *Camille Clark, Revere High School*

DISCUSSANT *Scott Schopieray, Michigan State University*

PRESENTATIONS

Experiential Learning and Action Research in the Business Classroom. *Kristen Hovsepian, Ashland University, Ashland University Students in Free Enterprise*

Where the Academy and Community Meet: Experiential Education and Career Preparation. *Michael P. Brown, Ball State University*

(Listing continued on next page)

Who Are They? Military Parents Who Homeschool Their Children: Recommendations for Adult Educators in the Military Community. *Melissa S. Silva, Northern Illinois University*
What Happened to Field Trips? A Descriptive Study of Community Resources Traditionally Visited By School Groups. *Naomi Jeffery Petersen, Indiana University South Bend*

F.1030.S MWERA Member Authors

MWERA — Alternative Session
Friday, 10:30 AM to 11:50 AM — Seneca Parlor

PRESENTATIONS

- TABLE 1 Isadore Newman, University of Akron, Carolyn Ridenour, University of Dayton, David Weis, University of Akron, and Keith McNeil, New Mexico State University, *Theses and Dissertations: A Guide to Writing in the Social and Physical Sciences*, University Press.
- TABLE 2 Isadore Newman, University of Akron, Keith McNeil, New Mexico State University, *Conducting Survey Research in the Social Sciences*, University Press.
- TABLE 3 Keith McNeil, New Mexico State University, Isadore Newman, University of Akron, Francis J. Kelly, *Testing Research Hypotheses with the General Linear Model*, Southern Illinois University Press.
- TABLE 4 Isadore Newman, University of Akron, Carole Newman, University of Akron, *Conceptual Statistics for Beginners: 2nd edition*, University Press.

Flyers will be available for:

Keith McNeil, New Mexico State University, Isadore Newman, University of Akron, and Jim Steinhauser, University of Akron, *How to be Involved in Program Evaluation: What Every Administrator Needs to Know*, University Press.

Gonzalez, Maria Luisa, Huerta-Macias, Anna, and Tinjero, Josie, *Educating Latino Students*, Technomic Publishing Company.

NOTES Come hear our member authors discuss their books. Get your very own autographed copy!

F.1030.TC Ideology, Context, and Educational Change

F: History and Historiography — Paper Presentation
Friday, 10:30 AM to 11:50 AM — Thurber Conference Suite

CHAIR *Joan Mari Johnson, Northeastern Illinois University*

DISCUSSANT *Sandra Spickard Prettyman, University of Akron*

PRESENTATIONS

Efforts Toward National Educational Reform: An Essentialist Agenda. *Thomas A. Kessinger, Xavier University*
Building Historical Sociocultural Context from Victorian Period Journalism. *Sharon A. Pinzone, Cleveland State University*

The Power of an Idea: Harry Hopkin's Approach to Adult Education during the Great Depression. *Robert E. Nolan, Oklahoma State University, Randal D. Ice, University of Central Oklahoma*

F.1200.GB Luncheon Keynote Address

MWERA — Alternative Session
Friday, 12:00 PM to 1:30 PM — Grand Ballroom

CHAIR *Janet K. Holt, Northern Illinois University*

PRESENTATION

Bernard Franklin
National Collegiate Athletic Association
College Athletics as a Model
for Promoting Academic Integrity in Higher Education

The Coalition on Intercollegiate Athletics adopted a resolution on April 1, 2005 that recognized the unique value of intercollegiate athletics lies in its potential to enhance education through engagement in sports. It can contribute to the personal development of athletes, it can form a focus of campus community for other students, and it can create bonds of shared loyalties to educational institutions among students, alumni, faculty, and broader communities. However, a century's experience has taught us that athletics can also compete with the educational missions of schools in ways that may negate this positive potential and undermine higher education. College sports should be pursued in a way that supports the value to enhance education. None of the values ascribed to college sports can be realized if we abandon the principle that personal development through athletics participation and academic achievement are linked.



(Listing continued on next page)

Dr. Bernard Franklin is currently Senior Vice-President for the National Collegiate Athletic Association (NCAA) Governance and Membership. He is responsible for working with the NCAA president, senior vice presidents, vice presidents, and governance structure team for the national office. Dr. Franklin has responsibility for assuring the development of policies and procedures that support the effective functioning of the governance groups and to work closely with the president to support the NCAA Executive Committee. Administrative areas also reporting to him are governance, membership services and research.



F.0140.CP Follow-Up Discussion From the Luncheon Keynote Address

MWERA — Alternative Session
Friday, 1:40 PM to 3:00 PM — Chittenden Parlor

CHAIR *Sharon A. Valente, Ashland University*

NOTES *This is a follow-up session to Dr. Franklin's luncheon address. There will be opportunities to pose questions and interact with Dr. Franklin.*

F.0140.DP A Mixture of Methodologies

D: Measurement and Research Methodology — Paper Presentation
Friday, 1:40 PM to 3:00 PM — Deschler Parlor

CHAIR *Marsha Lewis, Ohio University*

DISCUSSANT *Paul Vogt, Illinois State University*

PRESENTATIONS

Delphi Methodology: A Systematic Decision-Making Framework for Educational Research. *Sema A. Kalaian, Eastern Michigan University, Hiral Shah, Eastern Michigan University, David Anderson, Eastern Michigan University*

Mythocentric Methods: Serving A Civic Social Science. *Rich Hofmann, Miami University*

Contemplating "Mixed Methods Design Principles" for Educational Researchers. *Carolyn S. Ridenour, University of Dayton, Isadore Newman, University of Akron*

F.0140.HP Issues in On-Line and Distance Learning

J: Postsecondary Education — Paper Presentation
Friday, 1:40 PM to 3:00 PM — Hartman Parlor

CHAIR *Mark Magnuson, Ivy Tech Community College – Central Indiana*

DISCUSSANT *Scott Schopieray, Michigan State University*

PRESENTATIONS

Examining student roles in asynchronous discussions. *Selma Vonderwell, Cleveland State University*

Interactive Television (ITV) and Student Satisfaction: A Review of Selected Literature. *Kenneth D. Royal, University of Kentucky, Kelly D. Bradley, University of Kentucky*

Academic Integrity in On-line Learning: Current Status and Future Directions. *Jeffrey A. Ritchey, Pennsylvania State University*

F.0140.NH Applications of Multivariate Statistical Techniques to Specialized Situations

D: Measurement and Research Methodology — Paper Presentation
Friday, 1:40 PM to 3:00 PM — Neil House Parlor

CHAIR *Hua Fang, Ohio University*

DISCUSSANT *Rafa Kasim, Kent State University*

PRESENTATIONS

Re-evaluating social capital and homicide rates using structural equation modeling. *Raeal Moore, Ohio State University*

Latent Trait Modeling of Longitudinal Changes in Treatment Effects on Constructs of Teens' Sexual Abstinence. *Dimitar M. Dimitrov, George Mason University, Charles L. Thomas, George Mason University*

Persistence of Interest in Science, Technology, Engineering, and Mathematics: An Analysis of Persisting and Non-Persisting Students. *Jeffrey L. White, Ohio State University*

F.0140.PP Division Meeting

K: Teaching and Teacher Education — Meeting
Friday, 1:40 PM to 3:00 PM — Park Parlor

CHAIR *Francine C. Falk-Ross, Northern Illinois University*
DISCUSSANT *Glenda Moss, Indiana University Purdue University Fort Wayne*
PRESENTATIONS

Nina Dorsch
Northern Illinois University
Perspectives on Responsibilities in Teacher Education

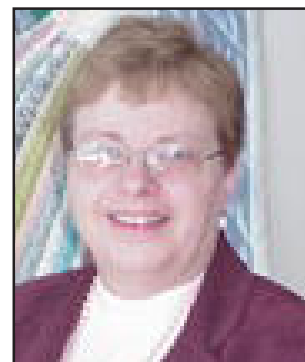

F.0140.S School Improvement

H: School Evaluation and Program Development — Paper Presentation
Friday, 1:40 PM to 3:00 PM — Seneca Parlor

CHAIR *Carole Newman, The University of Akron*
DISCUSSANT *Bruce Rogers, University of Northern Iowa*
PRESENTATIONS

Mixed Ability Grouping: A Qualitative View of De-Tracking Classes. *John L. Morris, Cleveland State University*
An Assessment of the Degree of Implementation of the Baldrige in Education Initiative. *Kathleen A. Sommers, Ashland University, Harold E. Wilson, Ashland University, Beverly A. Heimann, Ashland University, John W. Fraas, Ashland University*
Could the full service school concept help students improve academic achievement? *Yu-Chuan Huang, Pennsylvania State University*

F.0140.TC The Principalship

A: Administration — Paper Presentation
Friday, 1:40 PM to 3:00 PM — Thurber Conference Suite

CHAIR *Michelle Partlow, University of Dayton*
DISCUSSANT *Judy Zimmerman, Bowling Green State University*
PRESENTATIONS

Superintendent Perceptions of Traits of Effective and Ineffective Principals. *Derek Arrowood, Purdue University, Charles Kline, Purdue University*
Principals' Organizational Activities. *Sharon K. Kellogg, Ashland University, Carla Edlefson, Ashland University, John W. Fraas, Ashland University, Carol Engler, Ashland University*

F.0310.CP Certification and Licensure Issues in Teacher Education

K: Teaching and Teacher Education — Paper Presentation
Friday, 3:10 PM to 4:30 PM — Chittenden Parlor

CHAIR *Kathryn Wiggins, DePaul University*
DISCUSSANT *Beverly Klecker, Morehead State University*
PRESENTATIONS

A Longitudinal Study of Educator Supply and Demand in the United States (1997-2004). *Lingling Ma, University of Kentucky, Kelly D. Bradley, University of Kentucky, Shannon O. Sampson, University of Kentucky*
The Demand for Alternative Educator License in Ohio. *Ted A. Zigler, University of Cincinnati, Steffi Gilbertson, University of Cincinnati, Judy Wahrman, University of Findlay, Mary West, College of Mount St. Joseph, Corey Lee, University of Findlay*
Alternative Pathways to Teacher Certification: Do we want them? Are they ethical? *Deborah Bainer Jenkins, University of West Georgia, Kent Layton, University of West Georgia, Myrna Gantner, University of West Georgia*

E.0310.DP Division Meeting

I: Education in the Professions — Meeting
Friday, 3:10 PM to 4:40 PM — Deshler Parlor

CHAIR *LeAnn Derby, Air Force Academy*
DISCUSSANT *Catherine A. Marsh, North Park University*
PRESENTATIONS

Major LeAnn Derby
United States Air Force Academy
Academic Integrity: Responsible Learning
A Current Perspective from the United States Air Force Academy



E.0310.GB Roundtables and Posters

G: Social Context of Education and L: Educational Policy and Politics —
Roundtable Discussion/Poster
Friday, 3:10 PM to 4:30 PM — Grand Ballroom

PRESENTATIONS

- TABLE 1 Validation of a Retrospective Classroom Learning Procedure. *Charles L. Thomas, George Mason University, Dimiter M. Dimitrov, George Mason University*
- TABLE 2 Understanding the t-test: Explanations in educational statistics textbooks. *Bruce G. Rogers, University of Northern Iowa*
- TABLE 3 Program Evaluation in Deaf Education: How Do They Evaluate Their Programs? *Noriko Nagata, The Ohio State University, Mary K. Bendixen-Noe, The Ohio State University*
- TABLE 4 A Review of the Literature on Perceived Prevalence Rates and Reasons for Academic Dishonesty. *Jennifer A. Weber, University of Kentucky, Kelly D. Bradley, University of Kentucky*
- TABLE 5 Course Evaluation and Student Satisfaction: What Are They Really Saying?. *Naomi Jeffery Petersen, Indiana University South Bend, Randall Davies, Indiana University South Bend, Bruce Spitzer, Indiana University South Bend*
- TABLE 6 Social and Psychological Barriers to Parent School Involvement: What Can Teachers Do? *Angeline Stuckey, Northern Illinois University*
- TABLE 7 Constructing an Academic Project. *Craig Vivian, Monmouth College*
- TABLE 8 Gender Differences in School-Aged Chinese Students' Self-Perception. *Jianxiang Yang, Miami University, Aimin Wang, Miami University, Jinyu Xia, Miami University*
- TABLE 9 An Exploration of College Student Comfort Regarding Sexual Orientation and Gender Identity. *Vicki Johnson, Cleveland State University, Paul Putman, Cleveland State University*
- TABLE 10 Learning With Writing Exercises in Introductory Statistics. *Mark A. Earley, Bowling Green State University*

Call for Reviewers

The *Mid-Western Educational Researcher* is a scholarly journal that publishes research-based articles addressing a full range of educational issues. The journal also publishes literature reviews, theoretical and methodological discussions that make an original contribution to the research literature, and feature columns.

The editors seek professionals and faculty members from all ranks to add to its growing list of reviewers. Please e-mail Deborah Bainer-Jenkins at mer@westga.edu for further information.

F.0310.HP Redefining Traditional Education as We Have Come to Know it for Culturally Diverse Learners

G: Social Context of Education — Paper Presentation
Friday, 3:10 PM to 4:30 PM — Seneca Parlor

CHAIR *Doris Bergen, Miami University*

DISCUSSANT *Mark S. Brown, Eastern Illinois University*

PRESENTATIONS

Alternative Education for Street Children in Ghana. *Agya Boakye-Boaten, Ohio University*

New Pathways in the Workplace and Career Technical Education for the Disabled in Korea. *Hyosun Kim, The Ohio State University, Chris Zirkle, Ohio State University*

Prioritizing education: A passage to success for Asian-American students. *Weirong Wang, Illinois State University*

F.0310.NH Thinking and Learning: Research on Cognitive Processes

C: Learning and Instruction — Paper Presentation
Friday, 3:10 PM to 4:30 PM — Neil House Parlor

CHAIR *William Overton, Ashland University*

DISCUSSANT *Beverly Dretzke, University of Wisconsin - Eau Claire*

PRESENTATIONS

Metacognitive Performances of Hearing and Deaf and Hard-of-Hearing Students on Two Types of Measures: Visual-Verbal VS. Visual-Visual Stimuli. *Yasser A. Al-Hilawani, Kuwait University*

The Effect of scientific models on students' mental models of atomic structure in college chemistry. *Eun Jung Park, Ohio State University*

Problem-based learning of middle school students in the presence or absence of a teacher. *Jean W. Pierce, Northern Illinois University, Debra Gerdes, Illinois Mathematics and Science Academy*

F.0310.PP Addressing the Needs of Students At-Risk for Learning in the Classroom

K: Teaching and Teacher Education — Paper Presentation
Friday, 3:10 PM to 4:30 PM — Park Parlor

CHAIR *Martha Brueggeman, Ashland University*

DISCUSSANT *Sharon McNeely, Northeastern Illinois University*

PRESENTATIONS

“Too Little Too Late:” Parental Perspectives on Transition Planning for Students with Asperger Syndrome. *Deborah D. Webster, Cleveland State University, Penny L. Griffith, Kent State University*

Language Minority Students in the U.S. Mainstream Classroom. *Soonhyang Kim, The Ohio State University*

Comparison of Transition Studies: Two Studies, Two Voices. *Joyce A. Burgener, Michigan State University,*

F.0310.S Co-Sponsored Meeting of Division H and Division A

H: School Evaluation and Program Development and
A: Administration — Meeting
Friday, 3:10 PM to 4:30 PM — Seneca Parlor

CO-CHAIRS *Isadore Newman, University of Akron,*

Charles Kline, Purdue University

CO-DISCUSSANTS

Russell C. Brown, Cleveland Municipal School District,

Ted A. Zigler, University of Cincinnati

PRESENTATIONS

Dr. Barbara Byrd-Bennett
Cleveland Municipal School District

NOTES

This session is scheduled to overlap with F.0440.S. It is anticipated that F.0310.S will be time for Dr. Byrd-Bennett's invited address and F.0440.S will allow time for discussion and Division H and Division A business.



F.0310.TC Survey Research

D: Measurement and Research Methodology — Paper Presentation
Friday, 3:10 PM to 4:30 PM — Thurber Conference Suite

CHAIR *Ayres G. D'Costa, Ohio State University*

DISCUSSANT *Keith McNeil, New Mexico State University*

PRESENTATIONS

Correlates of Response Rates in Survey Research: A Meta-Analytic Review. *Sema A. Kalaian, Eastern Michigan University, Rafa M. Kasim, Kent State University*

Assessing the Needs of Nonprofit Organizations for Business Services. *Joe Jurczyk, University of Akron*

Web Based Surveys Basics. *Thomas M. Archer, The Ohio State University*

F.0440.CP MWERA Association Council and Officers' Orientation

MWERA — Meeting

Friday, 4:40 PM to 6:00 PM — Chittenden Parlor

CHAIR *Janet K. Holt, Northern Illinois University*

DISCUSSANT *Rodney J. Greer, Western Illinois University*

PRESENTATIONS

NOTES *This session will provide an orientation for newly elected Association Council members and MWERA officers. An overview will be given of our by-laws, policies and procedures, history, and issues that all elected officials should be familiar with as they start serving the Association. All members holding elected positions within the Association are requested to attend this session.*

F.0440.DP Perceptions of Quality Teaching

K: Teaching and Teacher Education — Paper Presentation

Friday, 4:40 PM to 6:00 PM — Deshler Parlor

CHAIR *Beverly Klecker, Morehead State University*

DISCUSSANT *Deborah D. Webster, Cleveland State University*

PRESENTATIONS

An investigation into traits that characterize high quality mathematics teachers and instruction. *Ali Webb, University of Kentucky, Kelly D. Bradley, University of Kentucky*

Preservice Teacher Concerns: A Teacher Quality Partnership Initiative. *Stephanie Gilbertson, University of Cincinnati, Judy Wahrman, University of Findlay, Mary West, College of Mount St. Joseph, Corey Lee, University of Findlay, Ted Zigler, University of Cincinnati*

A Survey of English Language Learners' Perceptions of Characteristics of Quality Math Teachers. *Tiffany A. Martinez, University of Kentucky, Shannon O. Sampson, University of Kentucky, Kelly D. Bradley, University of Kentucky*

F.0440.HP Division Meeting

J: Postsecondary Education — Meeting

Friday, 4:40 PM to 6:00 PM — Hartman Parlor

CHAIR *Heath Marrs, Fort Hays State University*

DISCUSSANT *Mark Magnuson, Ivy Tech State College – Central Indiana*

PRESENTATIONS

Mark Magnuson

Ivy Tech State College – Central Indiana

***Indiana's New Community College: Changing to Meet the Needs
of Its Higher Education Partners and the Workforce***

Be sure to join us later at 6 p.m. at the **Presidential Reception** in the **Great Southern Gallery**. Music provided by the Ashland University Jazz Combo under the direction of Scott Garlock.

F.0440.NH Issues of Diversity in the Field of Teacher Education

K: Teaching and Teacher Education — Paper Presentation
Friday, 4:40 PM to 6:00 PM — Neil House Parlor

CHAIR *Mary E. Lavin Crerand, Ashland University, Columbus Center*

DISCUSSANT *Hema Ramanathan, Butler University*

PRESENTATIONS

Pedagogy for Diversity and Social Justice while Maintaining Academic Integrity: Preparing Preservice Teachers. *Grace A. McDaniel, Otterbein College, Roland Coloma, Otterbein College, Dee Knoblauch, Otterbein College, Diane Ross, Otterbein College*

The Experiences of Turkish Faculty Members in the United States. *Sibel Duru, Indiana University*

An elementary school teacher's expectation with her cross-cultural background. *Chen-Ling Chang, Pennsylvania State University*

Satisfaction and retention of teachers in an urban school district. *Janet E. Kearney, Ashland University, Columbus Center*

F.0440.PP Monte Carlo Analyses of Statistical Methods

D: Measurement and Research Methodology — Paper Presentation
Friday, 4:40 PM to 6:00 PM — Park Parlor

CHAIR *David Newman, Cleveland State University*

DISCUSSANT *Thomas Smith, Northern Illinois University*

PRESENTATIONS

A Modified Shrinkage Formula for Extreme Conditions. *David Walker, Northern Illinois University*

A Monte Carlo Study for Comparing LM and HLM. *Hua Fang, Ohio University, Maria Rizzo, Ohio University, Gordon P. Brooks, Ohio University, Marsha Lewis, Ohio University, Robert Barcikowski, Ohio University*

The relationship between internal consistency and goodness of fit in maximum likelihood EFA. *Gibbs Y. Kanyongo, Duquesne University, James Schreiber, Duquesne University*

F.0440.S Co-Sponsored Meeting of Division H and Division A

H: School Evaluation and Program Development and A: Administration — Meeting
Friday, 4:40 PM to 6:00 PM — Seneca Parlor

CO-CHAIRS *Isadore Newman, University of Akron, Charles Kline, Purdue University*

CO-DISCUSSANTS *Russell C. Brown, Cleveland Municipal School District, Ted A. Zigler, University of Cincinnati*

PRESENTATIONS

Dr. Barbara Byrd-Bennett

Cleveland Municipal School District

NOTES This session is a continuation of F.0310.S. It is anticipated that F.0310.S will be time for Dr. Byrd-Bennett's invited address and F.0430.S will allow time for discussion and Division H and Division A business.

F.0440.S Division Meeting

F: History and Historiography — Meeting
Friday, 4:40 PM to 6:00 PM — Seneca Parlor

CHAIR *Amy D. Rose, Northern Illinois University*

DISCUSSANT *Sandra Spickard Prettyman, University of Akron*

PRESENTATIONS

Adah Ward Randolph

Ohio University

***Mining the Coal Fields: Conducting Historical Research
About African Americans in Ohio***

F.0600.M President's Reception

MWERA — Alternative Session
Friday, 6:00 PM to 8:00 PM — Great Southern Gallery

CHAIR *Janet K. Holt, Northern Illinois University*

Saturday, October 15, 2005

8:00 AM – 10:00 AM MWERA Registration Desk

S.0800.CP College Students and Responsible Learning

J: Postsecondary Education — Paper Presentation
Saturday, 8:00 AM to 9:20 AM — Chittenden Parlor

CHAIR *Katrina Daytner, Western Illinois University*

DISCUSSANT *Eric Mansfield, Western Illinois University*

PRESENTATIONS

How does community service learning affect college students' career choice? *Jie Yao, Ohio State University*
Student Attrition and Retention at the University Level. *John L. Rausch, John Carroll University*
An Analysis of Learning and Study Strategy Gains for Students Enrolled in Study Skills Courses. *Ellen A. Sigler, Indiana University Kokomo, Mark Magnuson, Ivy Tech State College – Central Indiana*
Developing Relationships and Communities: Relational and Entitative Frameworks for Learning. *Steven F. Corfman, Antioch College*

S.0800.DP Integration of Instructional Technology in Educational Classes

K: Teaching and Teacher Education — Paper Presentation
Saturday, 8:00 AM to 9:20 AM — Deshler Parlor

CHAIR *Ni Chang, Indiana University-South Bend*

DISCUSSANT *Francine C. Falk-Ross, Northern Illinois University*

PRESENTATIONS

Identifying Factors that Impact Teachers' Sustained Integration of Instructional Technology. *Jaclyn W. Babcock, University of Kentucky, Kelly D. Bradley, University of Kentucky, Shannon O. Sampson, University of Kentucky*
The impact of teacher preparation on teacher technology integration into early childhood classrooms. *Rachel Adeodu, Northeastern Illinois University*
Is this on the test? Technology integration in education courses. *Lesia C. Lennex, Morehead State University, Beverly Klecker, Morehead State University, Erika Ross, Morehead State University*

S.0800.HP The Impact of Professional Development on Teacher Efficacy

K: Teaching and Teacher Education — Paper Presentation
Saturday, 8:00 AM to 9:20 AM — Hartman Parlor

CHAIR *Cathryn Crosby, the Ohio State University*

DISCUSSANT *Carole Newman, The University of Akron*

PRESENTATIONS

Results of Professional Development in Acid-base Chemistry and Oxidation-reduction Chemistry. *Elizabeth A. Roland, University of Kentucky, Diane Johnson, Lewis County School System*
Opening Classroom Doors to Technology; Designing, Implementing, and Sustaining New Classroom Technologies. *Thomas F. Jackson, Northern Illinois University*
Technology empowerment through a learning community model: Impact on professional development in early childhood education. *Ruslan Slutsky, University of Toledo, Amy Allen, University of Toledo, Bob Cryan, University of Toledo*
Insiders' Perspective: What Distance Education Faculty Expect from Attending Training. *Haijun Kang, Pennsylvania State University*

S.0800.NH Recent Trends in Counseling Research

E: Counseling and Human Development — Paper Presentation
Saturday, 8:00 AM to 9:20 AM — Neil House Parlor

CHAIR *Jean Roberts, University of Toledo*

DISCUSSANT *John M. Laux, U. Toledo*

PRESENTATIONS

Technology Mediated vs. Face-to-Face Internship Supervision: A Study of Students' Perceptions. *Barbara M. Powell, Eastern Illinois University*

(Listing continued on next page)

General self-efficacy, assertiveness, and religion/spirituality as predictors of acculturative stress among international students. *Seongjik Lee, University of Kentucky, Kelly D. Bradley, University of Kentucky*
Issues in Using the SASSI-3 to Determine Substance Use Dependence Disorders. *Sandra L. Perosa, The University of Akron, Gregg Emmanuelson, Massillon Community Hospital, Linda Perosa, The University of Akron*
Family Background and Parenting Style: How Well Do They Correlate With College Students' Subsequent Alcohol and Drug Consumption? *Christina Johnson, Upper Iowa University, Amanda Luker, Upper Iowa University, Thomas S. Parish, Upper Iowa University*

S.0800.PP Structure of Schools for Improvement

A: Administration — Paper Presentation
Saturday, 8:00 AM to 9:20 AM — Park Parlor

CHAIR *Judy Zimmerman, Bowling Green State University*

DISCUSSANT *Nancy Mansberger, Western Michigan University*

PRESENTATIONS

Comparison of Magnet School Program Options and Magnet School to Non-Magnet School Program Options. *Charles E. Kline, Purdue University, Nikki C. Woodson, Purdue University*
Integration of Social and Emotional Learning in Middle Schools: Relationship to Adequate Yearly Academic Progress. *Jeffrey K. Butts, Purdue University, Charles Kline, Purdue University*

S.0800.TC Examining the Impact of Teacher-Related Factors on Student Affect and Motivation

C: Learning and Instruction — Paper Presentation
Saturday, 8:00 AM to 9:20 AM — Thurber Conference Suite

CHAIR *Carmen R. Giebelhaus, ETS Praxis Workshop*

DISCUSSANT *Greg Montalvo, Western Illinois University*

PRESENTATIONS

The effects of teacher expectations (academic press) on student self-efficacy and motivation in mathematics classrooms. *Matthew D. Deevers, Cleveland State University, Sean Folk, Baldwin Wallace College*
Does endorsement of mastery goals increase motivation in mathematics classrooms? *Matthew D. Deevers, Cleveland State University, Sean Folk, Baldwin Wallace College*
Pre-Service Teachers' Conceptions of Student Intelligence: Have Ideas About Intelligence Changed Over the Past 20 Years? Phase II. *John L. Morris, Cleveland State University, James Harvey, Cleveland State University, Vic Higgins, Cleveland State University, Josh Englehart, Cleveland State University, Anthony Pizzutti, Cleveland State University*

S.0800.VB Mid-Western Educational Researcher Editorial Board Meeting

MWERA — Meeting
Saturday, 8:00 AM to 9:20 AM — Vendome Board Room

CHAIR *Deborah Bainer Jenkins, University of West Georgia*

DISCUSSANT *Adrian Rodgers, The Ohio State University*

PRESENTATIONS

NOTES *All MWERA Editorial Advisory Board members are encouraged to attend this discussion about the focus and business of the Researcher. The editors, Deborah Bainer Jenkins and Adrian Rodgers, will be there to answer questions.*

S.0930.GB Presidential Address

MWERA — Alternative Session
Saturday, 9:30 AM to 10:20 AM — Grand Ballroom

PRESENTATION

MWERA 2005 President
Janet K. Holt
Northern Illinois University
How Do We Measure Up?
Capturing the Complexities of Educational Growth



Recent advances in growth modeling have introduced new possibilities for capturing the nuances of educational achievement growth. Yet, typical methods of assessing achievement progress often fail to take advantage of best practices in growth modeling. This address explores how advances in growth modeling approaches facilitate the measurement of educational policy goals. Analyses of policy questions regarding educational progress that are best addressed with state-of-the-art growth modeling approaches are illustrated.

S.1030.CP Studying Standardized Testing

D: Measurement and Research Methodology — Paper Presentation
Saturday, 10:30 AM to 11:50 AM — Chittenden Parlor

CHAIR *Marsha Lewis, Ohio University*

DISCUSSANT *Bruce Rogers, University of Northern Iowa*

PRESENTATIONS

Examining the Literacy Skills of Kindergartners in the Mid-Western region of the United States: A Hierarchical Analysis of the Early Childhood Longitudinal Study (ECLS-K). *Dipendra R. Subedi, Michigan State University*

The 'Gender Gap' in NAEP Fourth and Eighth Grade Reading Scores Across Years. *Beverly M. Klecker, Morehead State University*

Comparability of student performance on basic science tests across academic years. *Margarita D. Kokinova, Northeastern Ohio Universities College of Medicine*

S.1030.DP MWERA 2005 Conference Feedback and Planning

MWERA — Meeting

Saturday, 10:30 AM to 11:50 AM — Deschler Parlor

CHAIR *Sharon A. Valente, Ashland University*

DISCUSSANT *Craig A. Mertler, Bowling Green State University*

NOTES *All Division chairs for both the 2005 and 2006 conferences should attend this session. Feedback from this session will be integrated into the conference planning that begins at this afternoon's board meeting.*

S.1030.HP Academic Achievement in College: Factors and Influences

C: Learning and Instruction — Paper Presentation

Saturday, 10:30 AM to 11:50 AM — Hartman Parlor

CHAIR *Steve Wallace, Aurora University*

DISCUSSANT *Cynthia Campbell, Northern Illinois University*

PRESENTATIONS

The Impact of Full-Time Employment on Academic Effort and Higher Order Thinking Skills. *M. Linda Wastyn, Illinois State University, Theresa L. Schlabach, Illinois State University, Darryl Taylor, Illinois State University, Jared S. Trullinger, Illinois State University, John K. Rugutt, Illinois State University*

An Attempt to Assist Student-Athletes Succeed in Various Ways: A Pilot Study. *Thomas S. Parish, Upper Iowa University, Brad Baker, Upper Iowa University*

A Study of Factors that Influence College Academic Achievement: A Structural Equation Modeling Approach. *John K. Rugutt, Illinois State University, Caroline C. Chemosit, Illinois State University*

S.1030.NH Measuring Teacher and Student Attitudes and Learning

H: School Evaluation and Program Development — Paper Presentation

Saturday, 10:30 AM to 11:50 AM — Neil House Parlor

CHAIR *John Fraas, Ashland University*

DISCUSSANT *David Newman, Cleveland State University*

PRESENTATIONS

Part II: Evaluation of the Ohio Based Red Flags Depression Awareness Program. *Amanda M. Rovnak, University of Akron, Isadore Newman, University of Akron, Carole Newman, University of Akron, Shannon Smith, University of Nevada Las Vegas, Russell C. Brown, Cleveland Municipal School District, Rudy Libertini, Mental Health Association of Summit County, Victoria Doepeker, Penny Freese*

Teacher Trust in Building Principals: A Contextual Relationship to School Climate in K-4 Buildings, *Roger J. Goudy, South Euclid-Lyndhurst Schools*

E-Learning Revisited: Applying Formative Data to Shape Program Development, *Russell C. Brown, Cleveland Municipal School District*

S.1030.PP Teachers, Schools, and Teacher Training

F: History and Historiography — Paper Presentation
Saturday, 10:30 AM to 11:50 AM — Park Parlor

CHAIR *Mary Zahner, University of Dayton*

DISCUSSANT *Carl Beyer, Concordia University*

PRESENTATIONS

Treating the Maladjusted Teacher: The Mental Hygienic Selection, Education, and Supervision of Teachers, 1840-1960. *Laurie A. Hines, Kent State University-Trumbull*

Competition and Collaboration within Independent Schooling: A Historical Case Study. *James L. Green, College of Mount St. Joseph*

Boom and Bust in the Free Market of Education: A historical case study of National Normal University, 1855-1917. *Nathan R. Myers, Ashland University*

Moriane Park School: The Origins of the Antioch Plan. *Joseph Watras, University of Dayton*

S.1030.S Educational Politics and Market Pressures

L: Educational Policy and Politics — Paper Presentation
Saturday, 10:30 AM to 11:50 AM — Seneca Parlor

CHAIR *James E. Murray, University of Missouri St. Louis*

DISCUSSANT *Kathleen Brown, University of Missouri St. Louis*

PRESENTATIONS

Privatization: An Overview of the Trends in and Consequences of Privatizing Education. *Rosaire I. Ifedi, Ashland University*

Swallowing Cames and Straining at Gnats: School Choice Politics in Ohio. *Frances C. Fowler, Miami University*

Accountability through market-based ideology: Academic integrity or political smokescreen. *Judy J. May, Bowling Green State University*

S.1030.TC Research Approaches in Teacher Education Topics

K: Teaching and Teacher Education — Paper Presentation
Saturday, 10:30 AM to 11:50 AM — Thurber Conference Suite

CHAIR *James A. Freeman, III, The Ohio State University*

DISCUSSANT *Sharon McNeely, Northeastern Illinois University*

PRESENTATIONS

Testing for the Structural Validity of Scores from a Preservice Teacher Survey. *Yonghee Kim, Ohio State University, William E. Loadman, Ohio State University*

Teacher Quality Partnership - State Profile & Analysis of Cohort 1 Data. *Kevin G. Kula, The Ohio State University - TQP Project, William E. Loadman, Ohio State University*

Promoting Academic Integrity and Responsible Learning Through the Pedagogy of Plagiarism. *Cathryn R. Crosby, The Ohio State University*

S.1230.VB MWERA Board of Directors Meeting

MWERA — Meeting
Saturday, 12:30 PM to 5:00 PM — Vendome Board Room

CHAIR *Janet K. Holt, Northern Illinois University*

DISCUSSANT *Rodney J. Greer, Western Illinois University*

NOTES Lunch will be served at 12:30 with the board meeting starting promptly at 1 pm. All board members including the past president, the president, the president elect, the vice president, the secretary, the member-at-large, the vice president-elect, the executive director, the historian, and the journal co-editors, are expected to attend the entire meeting.

Division Meetings/Invited Addresses

It is with great honor and pride that the 2005 MWERA Program Committee announces that each of our 12 divisions has an invited address! For those of our speakers who are new to our research organization, welcome. We know you will enjoy the experience of the MWERA style of hospitality: collegiality, research inquiry, challenge, and support. After all, that is what responsible learning is all about!

To our members, please take advantage of this wonderful opportunity to hear from such learned professionals. Come prepared to have your expertise challenged and reinvigorated. Engage in what is sure to be exciting debates within a collegial atmosphere.

Co-Sponsored Meeting of Division H and Division A

H: School Evaluation and Program Development and A: Administration
Friday, 3:10 PM to 4:30 PM; 4:40 PM to 6:00 PM —Seneca Parlor

CO-CHAIRS *Isadore Newman, University of Akron,*
 Charles Kline, Purdue University

CO-DISCUSSANTS *Russell C. Brown, Cleveland Municipal School District,*
 Ted A. Zigler, University of Cincinnati

INVITED ADDRESS

Barbara Byrd-Bennett
Cleveland Municipal School District

Division B: Curriculum Studies

Thursday, 3:10 PM to 4:30 PM — Hartman Parlor

CHAIR *Bruce W. Jones, Notre Dame College*

DISCUSSANT *Doug Feldmann, Northern Kentucky University*

INVITED ADDRESS

Doug Feldmann
Northern Kentucky University
Curriculum and Community Involvement

Division C: Learning and Instruction

Thursday, 3:10 PM to 4:30 PM — Deshler Parlor

CHAIR *Tracey Stuckey-Mickell, Northern Illinois University*

INVITED ADDRESS

Greg Montalvo
Western Illinois University
*Online Design Elements: Improving Student Success and
Minimizing Instructor Load*

Division D: Measurement and Research Methodology

Friday, 8:00 AM to 9:20 AM — Park Parlor

CHAIR *Gordon Brooks, Ohio University*

DISCUSSANT *Sema Kalaian, Eastern Michigan University*

INVITED ADDRESS

Mark A. Earley
Bowling Green State University
*Improving Statistics Education: Can We Collaborate
with Faculty in Other Departments?*

Division E: Counseling and Human Development

Thursday, 3:10 PM to 4:30 PM — Seneca Parlor

CHAIR *John Laux, University of Toledo*

DISCUSSANT *Andrew Burck, University of Toledo*

INVITED ADDRESS

Andrew Burck and Jean Roberts
University of Toledo
*The Road Less Traveled:
How to Make a Difference in Your Doctoral Studies*

Division F: History and Historiography

Friday, 4:40 PM to 6:00 PM — Thurber Conference Suite

CHAIR *Amy D. Rose, Northern Illinois University*

DISCUSSANT *Sandra Spickard Prettyman, University of Akron*

INVITED ADDRESS

Adah Ward Randolph
Ohio University
*Mining the Coal Fields: Conducting Historical Research
About African Americans in Ohio*

Division G: Social Context of Education

Thursday, 1:40 PM to 3:00 PM — Seneca Parlor

CHAIR *Aimin Wang, Miami University*

DISCUSSANT *Mark S. Brown, Daemen College*

INVITED ADDRESS

William M. Bowen
Cleveland State University
*The University and Its Enemies:
Social and Economic Implications of the Idea Variation Hypothesis*

Division I: Education in the Professions

Friday, 3:10 PM to 4:40 PM — Deshler Parlor

CHAIR *LeAnn Derby, Air Force Academy*

DISCUSSANT *Catherine A. Marsh, North Park University*

INVITED ADDRESS

Major LeAnn Derby
United States Air Force Academy
*Academic Integrity: Responsible Learning
A Current Perspective From the United States Air Force Academy*

Division J: Postsecondary Education

Friday, 4:40 PM to 6:00 PM — Hartman Parlor

CHAIR *Heath Marrs, Fort Hays State University*

DISCUSSANT *Mark Magnuson, Ivy Tech State College – Central Indiana*

INVITED ADDRESS

Mark Magnuson
Ivy Tech State College – Central Indiana
*Indiana's New Community College:
Changing to Meet the Needs of
Its Higher Education Partners and the Workforce*

Division K: Teaching and Teacher Education

Friday, 1:40 PM to 3:00 PM — Park Parlor

CHAIR *Francine C. Falk-Ross, Northern Illinois University*

DISCUSSANT *Glenda Moss, Indiana University Purdue University Fort Wayne*

INVITED ADDRESS

Nina Dorsch
Northern Illinois University
Perspectives on Responsibilities in Teacher Education

Division L: Educational Policy and Politics

Thursday, 1:40 PM to 3:30 PM — Neil House Parlor

CHAIR *Kathleen Brown, University of Missouri St. Louis*

DISCUSSANT *James E. Murray, University of Missouri St. Louis*

INVITED ADDRESS

The Honorable Bill Harris
President of Ohio Senate
*Ohio's FY06-07 Budget:
Primary, Secondary, and Higher Education*

Cross-Index to Session Sponsors

A: Administration

- T.1030.PP Trends for Leadership
 T.0310.PP Leadership Issues T.0310.PP
 F.0800.DP The Superintendency
 F.0140.TC The Principalship
 F.0310.S Co-Sponsored Meeting of Division H and Division A
 F.0440.S Co-Sponsored Meeting of Division H and Division A
 S.0800.PP Structure of Schools for Improvement

B: Curriculum Studies

- T.0310.HP Division Meeting
 F.1030.DP Curriculum Studies in Multiple Field-Based Contexts

C: Learning and Instruction

- T.0800.CP Improving Learning Through Professional Development for Educators
 T.0140.HP Investigations in Technology and Learning
 T.0140.PP Facilitating Stimulating Case Study Discussions
 T.0310.DP Division Meeting
 T.0310.GB Roundtables and Posters
 F.1030.NH Enhancing Reading Achievement: Research on Parental and Classroom Initiatives
 F.0310.NH Thinking and Learning: Research on Cognitive Processes
 S.0800.TC Examining the Impact of Teacher-Related Factors on Student Affect and Motivation
 S.1030.HP Academic Achievement in College: Factors and Influences

D: Measurement and Research Methodology

- W.0100.NH Hierarchical Linear Modeling (HLM) Workshop
 W.0400.PP Focus Group Interview Moderator Training
 T.0800.NH Simulations and Online Technology as Learning Tools in Statistics Courses
 T.1030.NH TQP Preservice Survey: Development, Implementation and Results
 T.0140.CP Issues in Reliability
 T.0310.GB Roundtables and Posters
 T.0310.NH Assessment of Learning in Preservice Teachers

- T.0440.CP Analyzing Test Items
 F.0800.PP Division Meeting
 F.0140.DP A Mixture of Methodologies
 F.0140.NH Applications of Multivariate Statistical Techniques to Specialized Situations
 F.0310.TC Survey Research
 F.0440.PP Monte Carlo Analyses of Statistical Methods
 S.1030.CP Studying Standardized Testing

E: Counseling and Human Development

- T.1030.DP Challenges to Academic Development
 T.0310.S Division Meeting
 S.0800.NH Recent Trends in Counseling Research

F: History and Historiography

- T.0800.PP Philanthropy and Educational Reform in the Early Twentieth Century
 T.0140.DP Education and the Struggle for African American Education during the 1960s and 1970s in Two Northern Cities in the Delaware Valley: Philadelphia and Camden
 F.0800.S Americanization, Sport and Oral History
 F.1030.TC Ideology, Context, and Educational Change
 F.0440.TC Division Meeting
 S.1030.PP Teachers, Schools, and Teacher Training

G: Social Context of Education

- T.0800.HP Self-Perception and Culture: Exploring Their Unique Interrelationship in the Classroom
 T.1030.HP Perceptions of International Students and Faculty
 T.0140.S Division Meeting
 T.0440.TC Exploring Diversity Issues in the Classroom and In Society: Broadening our Cultural-Familial Awareness
 F.0800.NH Exploring the Effective Use of Technology as a Tool for Expanding a Student's Knowledge and Facilitating Peer Social Interaction
 F.1030.PP Learning Outside the Traditional Classroom
 F.0310.GB Roundtables and Posters
 F.0310.HP Redefining Traditional Education as We Have Come to Know it for Culturally Diverse Learners

H: School Evaluation and Program Development

| | |
|-----------|--|
| W.0100.PP | Writing and Securing Grants |
| T.0800.TC | Expanding Services to Reach More Students |
| T.1030.S | Data to Inform School Decision Making Processes |
| T.0310.TC | Faculty Issues in Academic Integrity |
| F.0800.TC | Measuring Learning |
| F.0140.S | School Improvement |
| F.0310.S | Co-Sponsored Meeting of Division H and Division A |
| F.0440.S | Co-Sponsored Meeting of Division H and Division A |
| S.1030.NH | Measuring Teacher and Student Attitudes and Learning |

I: Education in the Professions

| | |
|-----------|---|
| T.0440.DP | Processes of Life: Jobs, Satisfaction, and Learning |
| F.0310.DP | Division Meeting |

J: Postsecondary Education

| | |
|-----------|--|
| T.0140.TC | Effective and Ineffective Metacognitive Knowledge Monitoring in Post-Secondary Education |
| T.0310.CP | Diversity Issues in Higher Education |
| T.0440.PP | Faculty Issues |
| F.1030.HP | Issues in Post-Secondary Education |
| F.0140.HP | Issues in On-Line and Distance Learning |
| F.0440.HP | Division Meeting |
| S.0800.CP | College Students and Responsible Learning |

K: Teaching and Teacher Education

| | |
|-----------|--|
| T.0800.S | Models for Teacher Preparation |
| T.1030.TC | Using Technology in the Classroom for Assessment and Instruction |
| T.0440.NH | Factors in Teacher Preparation |
| F.0800.CP | Factors Affecting Students' Success in the Classroom |
| F.1030.CP | The Five Ws of Getting Published |
| F.0140.PP | Division Meeting |
| F.0310.CP | Certification and Licensure Issues in Teacher Education |
| F.0310.PP | Addressing the Needs of Students At-Risk for Learning in the Classroom |
| F.0440.DP | Perceptions of Quality Teaching |

| | |
|-----------|--|
| F.0440.NH | Issues of Diversity in the Field of Teacher Education |
| S.0800.DP | Integration of Instructional Technology in Educational Classes |
| S.0800.HP | The Impact of Professional Development on Teacher Efficacy |
| S.1030.TC | Research Approaches in Teacher Education Topics |

L: Educational Policy and Politics

| | |
|-----------|---|
| T.0800.DP | The Mirror of Comparative Analysis in Policy and Practice |
| T.0140.NH | Division Meeting |
| T.0440.HP | Building Leaders, Building Schools, and Building a Sense of Community |
| F.0310.GB | Roundtables and Posters |
| S.1030.S | Educational Politics and Market Pressures |

MWERA

| | |
|-----------|--|
| W.0800.M | Fireside Chat and Social with Dr. Michael Schwartz |
| T.0930.GB | Keynote Address |
| T.1030.CP | Follow-Up Discussion from the Keynote Address |
| T.1030.M | New Member Welcome |
| T.1200.GB | MWERA Association Council Meeting |
| T.0440.GB | MWERA Member Authors |
| T.0440.S | Student Member Meeting |
| T.0600.M | Cracker Barrel Social |
| F.0700.HP | Division Chair and Co-Chair Breakfast |
| F.0800.HP | Division Chairs and Co-Chairs |
| F.0930.GB | MWERA Business Meeting |
| F.1030.S | MWERA Member Authors |
| F.1200.GB | Luncheon Keynote Address |
| F.0140.CP | Follow-Up Discussion From the Luncheon Keynote Address |
| F.0440.CP | MWERA Association Council and Officers' Orientation |
| F.0600.M | President's Reception |
| S.0800.VB | Mid-Western Educational Researcher Editorial Board Meeting |
| S.0930.GB | Presidential Address |
| S.1030.DP | MWERA 2005 Conference Feedback and Planning |
| S.1230.VB | MWERA Board of Directors Meeting |

Subject Index

Ability Grouping

T.0800.DP F.0140.S

Accountability

T.0800.DP T.0440.DP F.0140.HP
S.0800.PP S.1030.TC

Achievement

T.0800.DP T.0310.GB T.0310.PP
T.0440.PP F.1030.NH F.0310.HP
S.1030.HP

Action Research

T.0800.CP T.0800.S

Adaptive Testing

T.0310.NH

Administration

T.1030.PP T.0310.PP F.0800.DP
F.0140.TC S.0800.PP S.1030.S

Admissions

S.0800.CP

Adolescence

T.1030.DP T.1030.HP T.1030.TC
F.0800.NH F.0310.GB

Adult Education/Development

T.1030.HP T.0140.HP T.0310.GB
T.0440.DP F.1030.PP F.1030.TC
S.1030.HP S.1030.PP

Arts Education

F.0800.CP

Asian Education

T.0800.DP T.1030.HP F.0310.HP

Assessment

T.0800.CP T.0800.DP T.0310.CP
T.0310.GB T.0310.NH T.0440.CP
T.0440.NH T.0440.PP F.0800.TC
F.0140.S F.0310.GB F.0310.NH
S.0800.NH S.1030.CP

At-Risk Students

F.0800.NH F.1030.NH F.0140.NH
F.0310.PP S.1030.NH T.0310.CP

Bilingual/Bicultural

T.0310.CP F.0440.DP

Black Education

T.0140.DP

Business Education

T.0140.HP F.1030.PP

Career Development

T.0440.DP S.0800.CP

Case Studies

T.0800.DP T.0140.PP T.0310.CP
T.0440.NH F.0800.S F.1030.TC
F.1030.HP

Certification/Licensure

F.0310.CP

Child Development

T.1030.DP F.0800.CP F.0310.GB
S.0800.NH

Classroom Management

T.0310.TC

Classroom Research

T.0800.CP F.1030.DP F.1030.NH
F.0310.GB S.1030.HP S.1030.TC

Clinical Education

T.0440.DP T.0440.NH

Cognitive Processes/Development

T.0440.TC T.0310.GB F.0310.NH

Collaboration

T.1030.PP F.0800.CP F.1030.DP
F.1030.PP F.0140.S F.0310.PP
F.0440.TC S.0800.CP

Community Colleges

T.0310.CP F.1030.HP F.0440.TC

Comparative Education

T.0800.DP T.0310.GB F.1030.DP
F.0310.HP

Comprehension

F.1030.NH

Computer Applications

T.0800.NH T.0140.HP F.0310.TC

Computerized Testing

T.0310.NH

Computers and Learning

T.1030.TC T.0140.HP T.0310.DP
F.0800.NH

Conceptual Change

F.0800.TC S.0800.HP

Constructivism

T.0800.S T.0310.GB

Cooperative Learning

T.0310.GB S.0800.CP

Counseling

T.1030.DP S.0800.NH

Counselor Training/Supervision

S.0800.NH

Critical Theory

T.0440.TC

Critical Thinking

F.0800.TC S.1030.HP

Cross-Cultural Studies

T.0310.GB T.0440.TC F.1030.DP
S.0800.NH

Curriculum

T.0800.S T.0310.HP F.0800.CP
F.1030.DP S.0800.DP S.1030.PP

Data Analysis

W.0100.NH T.0800.CP T.1030.S
T.0140.CP F.0440.PP

Decision Making

F.0140.DP

Demography

T.0440.HP

Desegregation

T.0140.DP

Differential Item Functioning

T.0310.NH

Dimensionality

T.0310.NH

Early Childhood

T.0800.HP T.1030.TC F.0800.CP
F.0800.S F.1030.DP F.1030.NH
S.0800.DP S.1030.CP

Economics of Education

S.1030.S

Educational Policy

T.0140.DP F.0800.DP T.0440.HP
F.0310.CP S.1030.PP S.1030.S

Educational Reform

T.0800.DP T.0800.PP T.0140.DP
T.0440.TC F.0800.DP F.1030.TC
F.0440.NH S.1030.PP S.1030.S

Elementary Schools

T.1030.HP F.0140.TC

Equating

T.0310.GB

Equity

T.0440.NH S.1030.S

Ethics

T.0310.PP T.0310.TC F.0140.HP
F.0310.GB

Ethnicity

T.1030.HP T.0310.CP F.0800.S

Evaluation

W.0100.PP W.0400.PP T.0440.NH
F.0800.TC F.0140.NH F.0140.S
F.0310.GB F.0310.TC

Experimental Design

F.0140.DP F.0140.S

Facilities

T.0440.HP

Factor Analysis

F.0800.CP F.0800.TC F.0140.NH
F.0310.GB F.0440.PP

Faculty Development

T.0440.DP T.0440.PP F.0310.PP
S.0800.HP

Family/Home Education

T.0310.PP F.1030.PP S.0800.NH

Finance

W.0100.PP F.1030.HP

Gay/Lesbian Studies

F.0310.GB

Gender Studies

T.0310.CP F.0800.S F.1030.DP
F.0310.GB S.0800.TC

Governance

T.0310.TC F.0800.DP

High Schools

T.1030.HP T.0310.PP F.1030.DP
F.0140.S

History

T.0800.PP T.0140.DP T.0440.PP
F.0800.S F.1030.TC S.1030.PP

Indicators/Information Systems

T.1030.S

Individual Differences

F.0310.GB F.0310.PP

Instructional Design/Development

T.0310.DP F.0800.CP S.0800.NH

Instructional Practices

T.0800.S T.0140.PP T.0310.GB
T.0440.PP F.1030.HP

Instructional Technology

T.0800.S T.0140.HP F.0800.NH
F.0140.HP

Intelligence

T.0440.DP F.0800.CP

International Education/Studies

T.1030.TC F.0310.HP F.0440.NH
S.1030.TC

Item Response Theory (IRT)

T.0140.CP T.0310.NH S.1030.CP

Language Comprehension/Development

F.1030.DP

- Leadership**
T.1030.PP T.0140.HP T.0310.PP
F.0800.DP T.0440.HP F.0140.TC
- Learning Environments**
T.0800.TC T.0310.GB F.0800.NH
F.1030.NH F.1030.PP F.0140.HP
S.0800.HP
- Learning Processes/Strategies**
T.1030.PP T.0310.GB T.0440.TC
F.0800.TC F.1030.PP S.0800.HP
- Life-Span Development**
T.1030.DP
- Literacy**
T.1030.TC F.0800.CP F.1030.NH
S.1030.CP
- Literature**
F.0140.HP F.0310.GB F.0440.DP
S.0800.DP
- Mainstreaming**
T.1030.DP
- Mathematics Education**
T.0310.GB F.0440.DP S.0800.TC
- Measurement**
W.0100.NH T.0140.CP T.0310.GB
T.0310.NH F.0140.NH S.1030.CP
- Media**
T.1030.TC F.0800.NH F.0140.NH
- Medical Education**
T.0440.DP S.1030.CP
- Meta-Analysis**
F.0310.TC
- Metacognition**
T.0140.TC F.0310.NH
- Middle Schools**
T.1030.DP S.0800.PP S.1030.NH
- Military Education**
T.0310.CP F.0310.DP
- Minorities**
T.1030.HP T.0310.CP T.0440.NH
F.0310.PP
- Moral Education/Development**
T.0800.PP
- Motivation**
T.0140.TC T.0310.GB T.0440.CP
F.0310.GB S.0800.TC
- Museum Education**
F.1030.PP
- NAEP**
S.1030.CP
- Networking**
W.0100.PP
- Organization Theory/Change**
T.1030.PP F.1030:HP S.0800.CP
- Peer Interaction/Friendship**
T.1030.DP T.0310.DP
- Performance Assessment**
T.0440.PP F.0800.TC S.0800.PP
- Philosophy**
F.1030.TC
- Physical Education**
F.0800.S
- Politics**
T.0800.DP T.0140.DP F.1030.TC
T.0440.HP S.1030.S
- Postsecondary Education**
T.0800.HP T.0310.CP T.0440.DP
T.0440.PP F.1030.CP F.1030:HP
F.0140.HP F.0310.GB F.0440.TC
S.0800.CP S.1030.TC
- Principals**
F.0140.TC
- Private Education**
S.1030.PP
- Problem Solving**
T.0140.HP T.0140.PP F.0310.NH
- Professional Development**
T.0800.CP T.0800.S T.0440.CP
T.0440.DP F.1030.CP S.0800.HP
- Program Evaluation**
F.0800.TC F.0140.S S.0800.PP
S.1030.NH
- Psychometrics**
T.0140.CP T.0440.CP S.1030.CP
- Qualitative Research**
W.0400.PP T.0800.TC T.1030.TC
T.0140.CP T.0310.GB F.0800.NH
F.0140.DP F.1030.TC F.0140.S
S.0800.CP
- Race**
T.0140.DP T.0440.TC
- Reading**
F.1030.NH S.1030.CP
- Research Methodology**
W.0400.PP T.1030.S T.0140.CP
F.0800.NH F.0800.S F.0140.DP
F.0310.GB F.0310.TC F.0440.PP
S.1030.CP
- Research Utilizations**
T.1030.PP T.1030.S
- Retention**
T.0310.CP F.0140.NH F.0440.NH
S.0800.CP
- Rural Education**
T.0310.HP
- School/Teacher Effectiveness**
T.0800.DP T.0800.HP T.1030.DP
T.0310.DP F.0310.GB F.0310.PP
F.0440.DP S.0800.PP S.0800.TC
- Science Education**
T.1030.TC T.0310.NH F.0800.TC
F.1030.DP F.0310.NH S.0800.DP
S.0800.HP
- Self-Concept**
T.1030.DP T.1030.HP T.0440.NH
- Social Class**
T.0440.CP F.1030:HP
- Social Context**
T.0800.HP T.1030.HP T.0310.GB
T.0310.HP F.0800.NH F.1030.PP
F.0140.DP T.0440.HP F.0310.GB
F.0310.HP
- Social Processes/Development**
T.1030.DP T.0440.TC F.0310.HP
S.0800.NH
- Social Studies Education**
F.1030.DP
- Special Education**
F.0310.GB F.0310.NH F.0310.PP
F.0310.HP
- Standard Setting**
T.0440.HP
- Statistics**
W.0100.NH T.0800.NH T.0140.CP
F.0140.S F.0140.TC F.0310.GB
F.0310.TC F.0440.PP
- Stress/Coping**
T.0310.DP T.0440.PP F.1030:HP
S.0800.NH
- Structural Modeling**
T.0140.HP T.0440.CP T.0440.NH
F.0140.NH S.1030.HP
- Student Behavior/Attitude**
T.0800.HP T.1030.DP T.0310.DP
T.0310.GB T.0440.CP F.0800.NH
F.0310.DP S.0800.TC S.1030.HP
- Student Cognition**
T.0310.GB
- Student Knowledge**
F.0310.GB S.1030:HP
- Student Teaching**
T.0440.NH
- Studying**
T.0140.TC S.0800.CP S.1030.HP
- Survey Research**
T.0800.S T.0800.TC T.1030.DP
T.1030.NH T.1030.S T.0310.GB
T.0440.TC F.0800.CP F.0140.DP
F.1030.HP F.0310.CP F.0310.GB
F.0310.TC F.0440.DP S.0800.NH
S.1030.TC
- Teacher Assessment**
F.0140.PP
- Teacher Characteristics**
F.1030.HP F.0440.DP F.0140.PP
- Teacher Cognition**
F.0800.CP
- Teacher Education/Development**
T.0800.CP T.0800.S T.1030.TC
T.0440.CP T.0440.NH T.0440.TC
F.0140.PP F.0310.CP F.0310.GB
F.0310.PP F.0440.DP F.0440.NH
S.0800.DP S.0800.HP S.0800.TC
S.1030.PP S.1030.TC
- Teacher Knowledge**
T.0310.GB T.0440.CP
- Teacher Research**
T.0800.CP T.0800.S F.1030:HP
F.0310.CP F.0440.NH
- Teaching Context**
T.0440.PP S.0800.TC
- Technology**
T.0800.NH T.0140.HP F.0800.NH
F.0140.HP S.0800.DP S.0800.HP
S.0800.NH
- Testing**
T.0310.GB
- Textbooks**
T.0800.CP F.0310.GB
- Urban Education**
T.0440.NH F.0310.CP F.0440.NH
- Validity/Reliability**
T.0140.CP T.0310.NH F.0310.GB
S.1030.TC
- Vocational Education**
F.0310.HP S.0800.CP
- Women's Issues**
T.0310.CP F.0800.S
- Work**
F.0310.DP
- Writing**
T.0140.HP F.1030.CP S.1030.TC

Participant Index

- Abbott, Jeff, *T.1030.PP*
Adams, Gail, *T.1030.DP*
Adderley, Kenneth, *T.0310.GB*
Adeodu, Rachel, *S.0800.DP*
Alderman, Kay, *T.0310.NH*
Al-Hilawani, Yasser A., *F.0310.NH*
Allen, Amy, *S.0800.HP*
Almond, Tasha M., *F.1030.NH*
Anderson, David, *T.1030.NH*
F.0140.DP
Andrist, Charlotte G., *F.1030.DP*
Archer, Thomas M., *W.0400.PP*
F.0310.TC
Arrowood, Derek, *F.0140.TC*
- Babcock, Jaclyn W., *T.0440.CP*
S.0800.DP
Baek, Mikyung, *F.0800.NH*
Bagakas, Joshua, *T.0440.TC*
Baker, Brad, *S.0800.HP*
Bakken, Linda, *T.1030.DP*
Barcikowski, Robert, *T.0800.NH*
F.0440.PP
Beilke, Jayne R., *T.0800.PP*
Bendixen-Noe, Mary, *T.1200.GB*
F.0310.GB
Bergen, Doris, *T.1200.GB T.0440.TC*
F.0310.HP
Beyer, Carl K., *F.0800.S S.1030.PP*
Boakye-Boaten, Agya, *F.0310.HP*
Bowen, William M., *T.0140.S*
Bradach, Gail L., *F.1030.NH*
Bradley, Kelly D., *T.0800.TC*
T.1200.GB T.0140.CP T.0440.CP
T.0440.S T.0440.TC F.1030.HP
F.0140.HP F.0310.CP F.0310.GB
F.0440.DP S.0800.DP S.0800.NH
Brooks, Gordon, *T.0800.CP*
T.1200.GB T.0440.CP F.0800.PP
F.0440.PP S.1230.VB
Brown, Kathleen, *T.1200.GB*
T.0140.NH S.1030.S
Brown, Mark S., *T.0140.S F.0800.NH*
F.0310.HP
Brown, Michael P., *F.1030.PP*
Brown, Russell C., *T.0800.TC*
F.0800.TC F.0310.S F.0440.S
S.1030.NH
Brueggeman, Martha, *F.0310.PP*
Burck, Andrew, *T.0310.S*
Burgener, Joyce A., *F.0310.PP*
Buskey, Frederick C., *T.1030.PP*
Butts, Jeffrey K., *S.0800.PP*
Byrd-Bennett, Barbara, *F.0310.S*
F.0440.S
- Calvert, Christy, *T.1030.DP*
- Campbell, Cynthia, *T.0800.CP*
T.1200.GB T.0310.NH T.0440.CP
S.1030.HP S.1230.VB
Cartledge, Gwendolyn, *F.1030.NH*
Chang, Chen-Ling, *F.0440.NH*
Chang, Ni, *T.0800.S S.0800.DP*
Chappell, Cathryn, *T.0310.NH*
Charity, Pamela C., *T.0440.TC*
Chen, Yun-chi, *T.0800.DP*
Chemosit, Caroline C., *S.1030.HP*
Chenevey, Jaime, *F.1030.HP*
Christo-Baker, Anne, *T.0310.PP*
Clark, Camille, *T.0800.HP F.1030.PP*
Clark, Mark A., *T.0310.GB*
Cody, Tom, *T.1030.DP T.1200.GB*
T.0310.CP
Collins, Vicki L., *T.0800.CP*
Coloma, Roland, *F.0440.NH*
Colville-Hall, Susan, *T.0301.NH*
Conley, Valerie Martin, *T.0440.PP*
Corfman, Steven F., *T.0440.TC*
F.0800.NH S.0800.CP
Crandall, Mary E. Lavin, *T.1030.HP*
Crosby, Cathryn R., *T.0440.NH*
S.0800.HP S.1030.TC
Cryan, Bob, *S.0800.HP*
Cutright, Marc, *T.0310.TC F.1030.HP*
- Daugherty, Yvette N., *T.0440.TC*
Davies, Randall, *F.0310.GB*
Davis, Matthew, *T.0140.DP*
Daytner, Katrina, *S.0800.CP*
D'Costa, Ayres G., *T.0140.CP*
F.0310.TC
Deevers, Matthew D., *S.0800.TC*
DeLuca, Barbara, *T.0800.CP*
Derby, Dustin C., *T.0310.CP*
Derby, LeAnn, *T.0440.DP F.0310.DP*
Dimitrov, Dimiter M., *T.1200.GB*
T.0440.CP F.0140.NH F.0310.GB
S.1230.VB
DiSilvestro, Frank R., *T.0440.DP*
Dixon, Tamela, *T.0440.NH*
Dobria, Lidia, *S.1030.CP*
Doepker, Victoria, *S.1030.NH*
Dorsch, Nina, *F.0140.PP*
Drake, Corey, *T.0800.DP*
Dretzke, Beverly, *T.0800.NH*
T.1200.GB F.0310.NH
Duru, Sibel, *F.0440.NH*
- Earley, Mark A., *T.0800.NH*
T.1030.PP T.0310.NH F.0310.GB
Edlefson, Carla, *T.0310.PP*
F.0800.DP F.0140.TC
Edmister, Julie, *T.0440.HP*
Eli, Jennifer A., *F.1030.HP*
- Emmanuelson, Gregg, *S.0800.NH*
Englehart, Joshua M., *T.0310.GB*
S.0800.TC
Engler, Carol, *F.0140.TC*
Erbacher, Julia M., *F.0800.S*
Ewing, John, *T.1030.S*
- Falk-Ross, Francine C., *T.0800.S*
T.1030.TC F.0140.PP S.0800.DP
Fang, Hua, *F.0140.NH F.0440.PP*
Farrell, Courtney A., *T.0140.HP*
Fasko, Dan, *T.0310.NH*
Faulkner, Jessica K., *T.0800.TC*
Feldmann, Doug, *T.1030.DP*
T.1200.GB T.0310.HP T.0440.GB
F.1030.DP
Folk, Sean, *S.0800.TC*
Fontana, Jessica M., *T.0440.DP*
Fowler, Frances C., *S.1030.S*
Fraas, John, *T.1030.S F.0800.TC*
F.0140.S F.0140.TC S.1030.NH
Franklin, Bernard, *F.1200.GB*
F.0140.CP
Freeman, III, James A., *T.0800.S*
T.1030.NH S.1030.TC
Freese, Penny, *S.1030.NH*
Frey, Joan L., *T.0440.DP*
- Gantner, Myrna, *F.0310.CP*
Gardner, Nancy, *T.0310.GB*
Garii, Barbara, *T.0440.PP*
Gerdes, Debra, *F.0310.NH*
Ghaffari, Masoud, *T.0440.DP*
Gibelhaus, Carmen R., *T.1200.GB*
S.0800.TC
Gilbertson, Stephanie, *F.0310.CP*
F.0440.DP
Gombach, Marlene E., *F.0800.S*
Goudy, Roger J., *T.1030.S S.1030.NH*
Green, James L., *S.1030.PP*
Greer, Rodney J., *T.1200.GB*
F.0930.GB F.0440.CP S.1230.VB
Griffith, Penny L., *F.0310.PP*
Guidry, Kellye L., *T.0140.HP*
- Harris, Bill, *T.0140.NH*
Harris, Jr., William, *T.0440.TC*
Harvey, James, *S.0800.TC*
Haynes, Thomas S., *T.0440.NH*
He, Wei, *T.0440.CP*
Heanacho, Ashimuneze, *T.0800.DP*
Heimann, Beverly A., *F.0140.S*
Herrelko, Janet M., *T.0800.CP*
Higgins, Vic, *S.0800.TC*
Hines, Edward, *F.1030.HP*
Hines, Laurie A., *T.0800.PP*
S.1030.PP

- Hodel, Ross, *F.1030.HP*
Hofmann, Rich, *T.0800.DP T.1200.GB T.0310.NH T.0440.HP F.0140.DP*
Holder, Kim Kit, *T.0140.DP*
Holt, Janet K., *T.1200.GB F.0800.HP F.0930.GB F.1030.HP F.0440.CP F.0600.M S.0930.GB S.1230.VB*
Hovsepian, Kristen, *F.1030.PP*
Hsieh, Min-Hua, *T.1030.HP*
Huang, Yu-Chuan, *F.0140.S*
Hudgens, Stacie, *S.1030.CP*
Hung, Hsin-Ling, *T.1030.DP*
- Ice, Randal D., *F.1030.TC*
Ifedi, Rosaire I., *S.1030.S*
Ilg, Tim, *T.1030.PP*
Isaacson, Randy M., *T.0140.TC*
- Jackson, Thomas F., *S.0800.HP*
Jenkins, Deborah Bainer, *T.1200.GB F.1030.CP F.0310.CP S.0800.VB S.1230.VB*
Jenkins, Percy, *T.0800.DP*
Johnson, Christina, *S.0800.NH*
Johnson, Diane, *S.0800.HP*
Johnson, Joan Mari, *F.1030.TC*
Johnson, Vicki, *F.0310.GB*
Johnson-Whitt, Eugenia S., *F.1030.DP*
Jones, Bruce W., *T.0310.HP F.1030.DP*
Jorissen, Kathleen T., *T.0440.HP*
Jurczyk, Joe, *F.0310.TC*
- Kalaian, Sema, *W.0100.NH T.0800.HP T.0140.CP F.0800.PP F.0140.DP F.0310.TC*
Kang, Haijun, *S.0800.HP*
Kang, Zongmin, *T.0800.HP*
Kanpol, Barry, *T.1030.PP*
Kanyongo, Gibbs Y., *T.0310.NH F.0440.PP*
Kasim, Rafa M., *W.0100.NH T.1030.TC F.0140.NH F.0310.TC*
Kearney, Janet E., *F.0440.NH*
Kellogg, Sharon K., *F.0140.TC*
Kempton, Kevin, *T.1030.PP*
Kessinger, Thomas A., *F.1030.TC*
Kim, Hyosun, *F.0310.HP*
Kim, Soonhyang, *F.0310.PP*
Kim, Yang Eun, *T.1030.TC F.1030.DP*
Kim, Yonghee, *T.1030.NH S.1030.TC*
Klecker, Beverly M., *T.0440.NH F.0310.CP F.0440.DP S.0800.DP S.1030.CP*
Kline, Charles E., *T.1030.PP F.0800.DP F.0140.TC F.0310.S F.0440.S S.0800.PP*
Knoblauch, Dee, *F.0440.NH*
- Koh, Myung-sook, *T.1030.HP*
Kokinova, Margarita D., *S.1030.CP*
Koomson, William K., *T.0800.DP*
Koos, Carolyn, *T.0310.GB*
Kourea, Lefki, *F.1030.NH*
Kowalski, Theodore J., *F.0800.DP*
Kula, Kevin G., *S.1030.TC*
- LaForte, Erica, *S.1030.CP*
Lahey, Laurie, *T.0140.DP*
Laird, Scott, *T.0310.GB*
Lane, Terri L., *T.0440.PP*
Laux, John M., *T.0310.S S.0800.NH*
Lavin Crerand, Mary E., *T.1030.HP F.0440.NH*
Layton, Kent, *F.0310.CP*
Lee, Corey, *F.0310.CP F.0440.DP*
Lee, Seongjik, *S.0800.NH*
Lennox, Lesia C., *S.0800.DP*
Lewis, Marsha S., *T.0800.CP F.0140.DP F.0440.PP S.1030.CP*
Li, Tianli, *T.0140.CP*
Liang, Xin, *T.0310.NH*
Libertini, Rudy, *S.1030.NH*
Linderman, Jon K., *F.0800.S*
Liu, Diyan, *F.0800.NH*
Loadman, William E., *T.1030.NH S.1030.TC*
Loe, David R., *T.0800.S T.1030.TC*
Loy, Kevin, *T.1030.NH*
Luker, Amanda, *S.0800.NH*
- Ma, Lingling, *F.0310.CP*
Madden, Paul M., *T.0440.PP*
Magnuson, Mark, *F.1030.HP F.0140.HP F.0440.HP F.0440.TC S.0800.CP*
Mansberger, Nancy, *S.0800.PP*
Mansfield, Eric, *T.0310.CP S.0800.CP*
Marrs, Heath, *T.0440.TC F.0440.HP*
Marsh, Catherine A., *T.0440.DP F.0310.DP*
Martinez, Sylvia L., *T.0440.PP*
Martinez, Tiffany A., *F.0440.DP*
Matthews-Lopez, Joy L., *T.0440.HP*
May, Dale R., *T.1030.DP*
May, Judy J., *S.1030.S*
McCoy, Lori, *t.0440.NH*
McDaniel, Grace A., *F.0440.NH*
McGuire, Dan C., *T.0310.GB*
McKnight, Oscar T., *T.0310.TC*
McNeely, Sharon, *T.1200.GB F.0310.PP S.1030.TC S.1230.VB*
McNeil, Keith, *F.1030.S F.0310.TC*
Mertler, Craig A., *T.0800.CP T.1030.M T.1200.GB T.0310.NH T.0440.GB S.1030.DP S.1230.VB*
Miller, Larry E., *T.0440.DP*
- Montalvo, Greg, *T.1200.GB T.0310.DP T.0440.PP F.0310.NH S.0800.TC*
Moore, David R., *F.0800.NH*
Moore, Raéal, *T.1030.NH F.0140.NH*
Morris, John L., *F.0800.CP F.0140.S S.0800.TC*
Mosley-Howard, Susan, *T.0800.DP*
Moss, Glenda C., *T.1030.PP T.1200.GB T.0440.TC F.0800.CP F.0140.PP*
Mrozek, Lawrence J., *T.0310.CP*
Murphey, Kathleen, *T.1030.PP*
Murray, James E., *T.0140.NH T.0440.HP S.1030.S*
Mushrush, Chris, *F.1030.HP*
Myers, Nathan R., *S.1030.PP*
Myford, Carol, *S.1030.CP*
- Nagata, Noriko, *F.0310.GB*
Navarro, Virginia, *T.0800.DP*
Newman, Carole, *T.1200.GB F.1030.DP F.0140.S S.0800.HP S.1030.NH*
Newman, David, *T.1200.GB F.0800.TC F.0440.PP S.1030.NH*
Newman, Isadore, *F.1030.S F.0140.DP F.0310.S F.0440.S S.1030.NH*
Nichols, Joe, *T.1030.PP*
Nicholson, Mike, *T.0800.CP*
Ngudgratoke, Sungworn, *T.0440.CP*
Nolan, Robert E., *F.1030.TC*
- Oberlander, Judith N., *T.0140.HP T.0440.NH*
Obiekwe, Jerry, *T.0440.CP F.0800.TC*
O'Brien, Thomas, *T.0800.PP*
Overton, William, *F.0310.NH*
- Parish, Joycelyn Gay, *T.0310.GB*
Parish, Thomas S., *T.0310.GB S.0800.NH S.1030.HP*
Park, Eun Jung, *F.0310.NH*
Parker, Abigail, *F.1030.DP*
Parmigian, Guy L., *T.0440.HP*
Partlow, Michelle, *T.0800.HP F.0140.TC*
Patterson, Christine, *T.0440.TC*
Perosa, Linda, *S.0800.NH*
Perosa, Sandra L., *S.0800.NH*
Petersen, Naomi Jeffery, *T.0440.PP F.1030.PP F.0310.GB*
Phillips, Anne E., *T.0140.DP*
Pierce, Jean W., *T.1200.GB F.0310.GB F.0310.NH S.1230.VB*
Pietrasz, Carol L., *F.0800.TC*
Pinzone, Sharon A., *F.1030.TC*
Pizzutti, Anthony, *S.0800.TC*

- Place, A. William, *T.1200.GB*
 Powell, Barbara M., *S.0800.NH*
 Putman, Paul, *F.0310.GB*
- Qin, Xiao, *T.0800.HP*
 Quade, Scott, *T.0310.TC*
- Ramanathan, Hema, *T.0800.S*
T.0440.NH F.1030.DP F.0440.NH
 Ramlo, Susan E., *F.0800.TC*
 Randolph, Adah Ward, *F.0440.TC*
 Rausch, John L., *T.0140.CP*
S.0800.CP
 Reams, Paula K., *T.1030.PP*
 Reckase, Mark D., *T.0440.CP*
 Richardson, Theresa, *T.0800.PP*
 Richter, Dirk, *T.1030.NH T.0440.NH*
 Ridenour, Carolyn S., *F.1030.S*
F.0140.DP
 Ritchey, Jeffrey A., *T.0440.PP*
F.0140.HP
 Rizzo, Maria, *F.0440.PP*
 Roberts, Jean, *T.0310.S S.0800.NH*
 Rodgers, Adrian, *T.1200.GB*
S.0800.VB S.1230.VB
 Rogers, Bruce G., *F.0140.S*
F.0310.GB S.1030.CP
 Roland, Elizabeth A., *S.0800.HP*
 Rose, Amy D., *F.0440.TC*
 Ross, Diane, *F.0440.NH*
 Ross, Erika, *S.0800.DP*
 Roulette-McIntyre, Ovella V.,
T.0310.PP
 Rovnak, Amanda M., *T.0800.TC*
S.1030.NH
 Royal, Kenneth D., *F.1030.HP*
F.0140.HP
 Rugutt, John K., *T.0310.GB*
S.1030.HP
- Sampson, Shannon O., *T.0440.CP*
F.0310.CP F.0440.DP S.0800.DP
 Sarther, Diane P., *T.0310.CP*
 Schlabach, Theresa L., *S.1030.HP*
 Schopieray, Scott, *F.1030.PP*
F.0140.HP
 Schreiber, James, *F.0440.PP*
 Schuh, Kathy L., *T.0140.HP*
 Schwartz, Michael, *W.0800.M*
T.0930.GB T.1030.CP
 Senteney, Hua G., *T.0310.GB*
 Shah, Hiral A., *T.0140.CP*
- Shen, Chia-Shen, *T.0800.TC*
 Sherman, Lawrence W., *T.0800.DP*
 Shin, Sunwoo, *T.1030.HP*
 Sigler, Ellen A., *S.0800.CP*
 Silva, Melissa S., *F.1030.PP*
 Skidmore, Ron, *T.0310.NH*
 Slutsky, Ruslan, *F.0800.CP*
S.0800.HP
 Smith, J. Malcolm, *F.1030.HP*
 Smith, Shannon, *S.1030.NH*
 Smith, Thomas J., *T.0800.NH*
T.1030.DP T.1200.GB F.0440.PP
 Smith Jr., Everett V., *S.1030.CP*
 Sommers, Kathleen A., *F.0140.S*
 Spearman, Patrick, *T.0140.DP*
 Spickard-Prettyman, Sandra,
F.0800.S F.1030.TC F.0440.TC
 Spidell, Cathy M., *T.1030.HP*
F.0800.NH
 Spitzer, Bruce, *F.0310.GB*
 Springer, Terry, *T.1030.PP*
 Stuckey, Angeline, *T.0140.HP*
T.0310.GB F.1030.NH F.0310.GB
 Stuckey-Mickell, Tracey, *T.0800.S*
T.0140.HP T.0310.DP F.1030.NH
 Subedi, Dipendra R., *T.0140.HP*
S.1030.CP
 Sudzina, Mary R., *T.0140.PP*
T.0440.GB
 Suggs, Robert, *T.0310.TC*
- Talbert-Johnson, Carolyn, *T.0140.HP*
T.0440.NH
 Tandoc, Bonnie E., *T.1030.DP*
 Taylor, Darryl, *S.1030.HP*
 Tekin, Ali K., *F.0800.CP*
 Thomas, Charles L., *F.0140.NH*
F.0310.GB
 Trullinger, Jared S., *S.1030.HP*
 Tsai, Min Ju, *T.0800.HP*
 Turner, Sandra V., *T.1030.TC*
 Turner, Susan Z., *F.0800.CP*
 Twale, Darla, *T.0800.CP*
- Valente, Sharon A., *W.0100.PP*
W.0800.M T.0930.GB T.1030.CP
T.1200.GB F.0800.HP F.1200.GB
F.0140.CP S.1030.DP S.1230.VB
 Vivian, Craig, *F.0310.GB*
 Vogt, Paul, *F.1030.HP F.0140.DP*
 Vonderwell, Selma, *F.1030.HP*
F.0140.HP
- Wahrman, Judy, *F.0310.CP*
F.0440.DP
 Walker, David, *T.0800.NH T.1030.S*
T.0140.CP F.0440.PP
 Wallace, Steve, *T.0800.CP S.1030.HP*
 Walters, Howard D., *W.0100.PP*
 Wang, Aimin, *T.0800.HP T.1030.HP*
T.1200.GB T.0140.S F.0310.GB
 Wang, Huei-Ling, *T.0800.TC*
 Wang, Weirong, *T.0440.NH*
F.0310.HP
 Wastyn, M. Linda, *S.1030.HP*
 Watras, Joseph, *T.0800.PP*
S.1030.PP
 Webb, Ali, *F.0440.DP*
 Weber, Jennifer A., *F.0310.GB*
 Webster, Deborah D., *F.0800.CP*
F.0310.PP F.0440.DP
 Weis, David, *F.1030.S*
 Wellen, Lauren A., *F.0800.S*
 Wendel, Paul J., *T.0310.GB*
 West, Mary, *F.0310.CP F.0440.DP*
 Wharton, Barbara I., *T.0310.CP*
 White, Jeffrey L., *F.0140.NH*
 Whittington, M. Susie, *T.1030.S*
F.1030.HP
 Wiggins, Kathryn, *F.0310.CP*
 Williams, E. Jane, *T.1200.GB*
 Wilson, Harold, *F.0140.S*
 Wiggins, Kathryn, *F.0310.CP*
 Woodson, Nikki C., *S.0800.PP*
- Xia, Jinyu, *F.0310.GB*
 Xia, Mingzhu, *T.1030.HP*
- Yang, Jianxiang, *T.1030.HP*
F.0310.GB
 Yang, Qingling, *T.0310.GB*
 Yao, Jie, *S.0800.CP*
 Yeh, Ling-Miao, *T.0310.CP*
 Yew, Feiye, *T.0310.GB*
 Yuan, Guofang, *T.0310.GB*
- Zahner, Mary, *F.0800.S S.1030.PP*
 Zigler, Ted A., *T.1200.GB F.0800.DP*
F.0310.CP F.0310.S F.0440.DP
F.0440.S
 Zimmerman, Judith A., *T.1200.GB*
T.0310.PP F.0140.TC S.0800.PP
 Zirkle, Chris, *F.0310.HP*

Address Directory of Participants

- Adeodu, Rachel** *R-Adeodu@neiu.edu*
Northeastern Illinois University, 6210 N. Washtenaw Ave, Unit 1,
Chicago, IL 60659
- Adusah, Albert** *aa363803@ohio.edu*
Ohio University, 314D McCracken Hall, Athens, OH 45701
- Al-Hilawani, Yasser** *yhilawani@netscape.net*
Kuwait University, Department of Educational Psychology,
College of Education, Kuwait
- Almond, Tasha** *Tasha_Almond@hotmail.com*
Northern Illinois University, 1425 W. Lincoln Hwy, DeKalb, IL 60115
- Anderson, David** *DAnderson@emich.edu*
Eastern Michigan University, College of Education,
Ypsilanti, MI 48197
- Andrist, Charlotte** *CharlotteAndrist@aol.com*
Educational Consultant and Language-Learning Tutor,
2948 Scioto Place, Columbus, OH 43221
- Archer, Thomas** *archer.3@osu.edu*
Department of Extension, The Ohio State University, Room 6
Agricultural Administration Building, 2120 Fyffe Road,
Columbus, OH 45365
- Arrowood, Derek** *chuck@purdue.edu*
Purdue University, 5133 Beering Hall, West Lafayette, IN 47907
- Babcock, Jaelyn** *weberjm2@hotmail.com*
University of Kentucky, 538 Dabney Drive, Lexington, KY 40509
- Baek, Mikyung** *Baek.7@osu.edu*
The Ohio State University, 1884 Dry Wash Rd, Hilliard, OH 43026
- Bagakas, Joshua** *j.bagakas@csuohio.edu*
Cleveland State University, RT 1351, 1860 East 22nd Street,
Cleveland, OH 44114-4435
- Bainer Jenkins, Deborah** *djenkins@westga.edu*
University of West Georgia, 228 Education Annex,
University of West Georgia, Carrollton, GA 30118
- Bakken, Linda** *linda.bakken@whicita.edu*
Wichita State University, 312 Hubbard Hall, Wichita, KS 67260-0123
- Barcikowski, Robert** *barcikow@ohio.edu*
Ohio University, 201 McCracken Hall, Athens, OH 45701
- Basham, Jamie** *jdbasham@eiu.edu*
Eastern Illinois University, Dept of Special Education,
1212 Buzzard Hall, 600 Lincoln Avenue, Charleston, IL 61920
- Beilke, Jayne** *jbeilke@bsu.edu*
Ball State University, Teachers College 804, Muncie, IN 47306
- Bergen, Doris** *bergend@muohio.edu*
Miami University, EDP Department, 100G McGuffey Hall,
Oxford, OH 45056
- Beyer, Carl** *beyerc@sbcglobal.net*
Concordia University, River Forest, 7400 Augusta Street,
River Forest, IL 60305
- Boakye-Boaten, Agya** *agya_boaten@yahoo.com*
Ohio University, 4245 Babble Dr., Columbus, OH 43207
- Bolliger, Doris** *dubolliger@stcloudstate.edu*
St. Cloud State University, 720 Fourth Ave S., MC 204 H,
St. Cloud, MN 56301
- Bowen, William M.** *bowen@urban.csuohio.edu*
Cleveland State University, 1737 Euclid Avenue, UB 107,
Cleveland, OH 44115-2105
- Bradach, Gail** *amethyst_04@hotmail.com*
Notre Dame College of Ohio, 8143-A Independence Drive,
Mentor, OH 44060
- Bradley, Kelly** *kbrad2@uky.edu*
University of Kentucky, College of Education,
131 Taylor Education Bldg., Lexington, KY 40506
- Bradley, Will** *jwillbradley@hotmail.com*
University of Kentucky, 144 A Taylor Education Building,
Lexington, KY 40506
- Brooks, Gordon** *brooksg@ohiou.edu*
Ohio University, 305A McCracken Hall, Athens, OH 45701
- Brown, Kathleen** *kathleen_brown@umsl.edu*
University of Missouri St. Louis, One University Boulevard,
269 Marillac Hall, St. Louis, MO 63121
- Brown, Mark** *mbrowneiu@hotmail.com*
Daemen College, Education Department, 4380 Main Street,
Amherst, NY 14226
- Brown, Michael** *mbrown@bsu.edu*
Ball State University, Department of Criminal Justice and Criminology,
North Quad 255, Muncie, IN 47306
- Brown, Russell** *Russell.C.Brown@cmsdnet.net*
Cleveland Municipal School District, 1380 East 6th Street,
Cleveland, OH 44114
- Brueggeman, Martha** *mbruegge@ashland.edu*
Ashland University, 1900 E. Dublin-Granville Road,
Columbus, Ohio 43229
- Burck, Andrew** *amburck@yahoo.com*
University of Toledo, 3272 Milstead Dr., Toledo, OH 43606
- Burgener, Joyce** *burgene2@msu.edu*
Michigan State University, 1512 Lupine Dr., St. Joseph, MI 49085
- Buskey, Frederick** *tworainbows63@yahoo.com*
Putnam County Educational Service Center, 129 Third St.,
Findlay, OH 45840
- Butts, Jeffrey** *chuck@purdue.edu*
Purdue University, 5133 Beering Hall, West Lafayette, IN 47907
- Camardese, Amy** *camardah@westminster.edu*
Westminster College, 12 Redfern Drive, Youngstown, OH 44505
- Campbell, Cynthia** *ccampbell@niu.edu*
Northern Illinois University, Gabel Hall 208, Dept of ETRA,
DeKalb, IL 60115
- Chang, Chen-Ling** *cuc180@psu.edu*
Pennsylvania State University, 425 Waupelani Drive #123,
State College, PA 16801
- Chang, Ni** *nchang@uisb.edu*
Indiana University-South Bend, 1700 Mishawaka Avenue,
South Bend, IN 46634
- Charity, Pamela** *p.charity@csuohio.edu*
Cleveland State University, 2121 Euclid Avenue, Cleveland, OH 44115
- Chen, Yun-chi** *ycx213@psu.edu*
Pennsylvania State University, 425 Waupelani Drive, Apt. #323,
State College, PA 16801
- Christo-Baker, Anneanne** *christo-baker@utoledo.edu*
University of Toledo, 1500B Transportation Center, MS 205,
Toledo, OH 43606

- Clark, Camille** *cclark@revere.k12.oh.us*
Revere HighSchool, 6502 Cross Creek Trail, Brecksville, OH 44141
- Clark, Mark** *MClark@ilstu.edu*
Illinois State University, 4950 N. 450th Rd., Plymouth, IL 62367
- Cody, Tom** *TJ-Cody@wiu.edu*
Western Illinois University, 80 Horrabin Hall, Macomb, IL 61455-1390
- Corfman, Steven** *scorfman@antioch-college.edu*
Antioch College, 795 Livermore Street, Yellow Springs, OH 45387
- Corley, Ed** *ecorley@heidelberg.edu*
Heidelberg College, 310 E. Market Street, Tiffin, OH 44883
- Coupland, Daniel** *dbcoupla@svsu.edu*
Saginaw Valley State University, EN 235 Regional Education Center,
7400 Bay Road, University Center, MI 48710
- Cox, Jane** *jane.cox@utoledo.edu*
University of Toledo, MS 119, Toledo, Oh 43560-3390
- Crosby, Cathryn** *crosby.69@osu.edu*
The Ohio State University, 60 Arps Hall, 1945 N. High Street,
Columbus, OH 43210
- Cunningham, Jessica** *jjvirgin@ms.uky.edu*
University of Kentucky, College of Education, Lexington, KY 40506
- Cutright, Marc** *cutrightm@ohio.edu*
Ohio University, Counseling and Higher Education,
305-D McCracken Hall, Athens, OH 45701
- Davis, Matthew** *davis@rowan.edu*
Rowan University, School of Education, Milford, NJ 60115
- Davis, Sally** *sally.a.davis@verizon.net*
Northern Illinois University, P. O. Box 985, DeKalb, IL 60115
- Daytner, Gary** *GT-Daytner@wiu.edu*
Western Illinois University, Horrabin Hall 80, One University Circle,
Macomb, IL 61455
- Daytner, Katrina** *km-daytner@wiu.edu*
Western Illinois University, Horrabin Hall 80J, One University Circle,
Macomb, IL 61455
- Daza, Stephanie** *daza.1@osu.edu*
Ohio State University, 141 Ramseyer, 29 W. Woodruff Ave,
Columbus, OH 43210
- D'Costa, Ayres** *dcosta.1@osu.edu*
Ohio State University, 315A Ramseyer, 29 W Woodruff Ave,
Columbus, OH 43210
- Deevers, Matthew** *deevers@crestwood.sparcc.org*
Cleveland State University, 2260 Frost Road, Streetsboro, OH 44241
- Derby, Dustin** *dderby10@niu.edu*
Northern Illinois University, 1802 Kennicott Ct., Sycamore, IL 60178
- Derby, LeAnn** *leann.derby@usafa.af.mil*
United States Air Force Academy, 2354 Fairchild Dr. Suite 4L8,
Colorado Springs, CO 80840
- Dimitrov, Dimiter** *ddimitro@gmu.edu*
George Mason University, GMU, 4400 University Drive, MS 4B3,
Fairfax, VA 22030
- DiSilvestro, Frank** *disil@indiana.edu*
Indiana University, Owen Hall, Room 105, Bloomington, IN 47405
- Dorsch, Nina** *pa0jcf1@wpo.cso.niu.edu*
Northern Illinois University, Chair,
Department of Teaching and Learning, DeKalb, IL 60115
- Drake, Corey** *drakec@umsl.edu*
University of Missouri St. Louis, One University Boulevard,
369 Marillac Hall, St. Louis, MO 63121
- Dretzke, Beverly** *dretzkbj@uwec.edu*
University of Wisconsin - Eau Claire, Department of Psychology,
Eau Claire, WI 54702
- Driana, Elin** *elindr@earthlink.net*
Ohio University, 314D McCracken Hall, Athens, OH 45701
- Duru, Sibel** *sduru@indiana.edu*
Indiana University, 417 N. Grant Apt. 6, Bloomington, IN 47408
- Earley, Mark** *earleym@bgnet.bgsu.edu*
Bowling Green State University, 550 Education Building,
Bowling Green, OH 43403
- Edlefsen, Carla** *cedlefsa@ashland.edu*
Ashland University, 1900 E. Dublin-Granville Road,
Columbus, OH 43229
- Eli, Jennifer** *jrice@ms.uky.edu*
University of Kentucky, 1101 Beaumont Centre Lane, Apt 18305,
Lexington, KY 40513
- Englehart, Joshua** *pa_englehart@lgca.org*
Cleveland State University, 112 Chestnut Street, Painesville, OH 44077
- Ewing, John** *Ewing.104@osu.edu*
The Ohio State University, 2120 Fyffe Rd., Columbus, OH 43210
- Falk-Ross, Francine** *ffalkross@niu.edu*
Northern Illinois University, Department of Literacy Education,
DeKalb, IL 60115
- Fang, Hua** *fang@ilgard.ohiou.edu*
Ohio University, 22 First St, Athens, OH 45701
- Farrell, Courtney** *courtney-farrell@uiowa.edu*
The University of Iowa, 505 E. Burlington Apt. 10B,
Iowa City, IA 52240
- Faulkner, Jessica** *jkfaulkner8@aol.com*
University of Kentucky, 506 Steele Street #3, Frankfort, KY 40601
- Feldmann, Doug** *feldmand1@nku.edu*
Northern Kentucky University, College of Education, BEP 281,
Highland Heights, KY 41099
- Fitzpatrick, Clara** *cfitzpatrick@colum.edu*
Columbia College, 600 S. Michigan, Chicago, IL 60605
- Fowler, Frances** *fowlerfc@muohio.edu*
Miami University, EDL 304 McGuffey Hall, Miami University,
Oxford, OH 45056
- Fraas, John** *jfraas@ashland.edu*
Ashland University, 401 College Avenue, Ashland, OH 44805
- Franklin, Bernard** *bfranklin@ncaa.org*
National Collegiate Athletic Association, P. O. Box 6222,
Indianapolis, IN 46206-6222
- Freeman, III, James** *freemanj@columbus.rr.com*
The Ohio State University, 1283 Hunter Avenue, Columbus, OH 43201
- Frey, Joan** *jfrey@aultman.com*
Aultman College of Nursing and Health Sciences,
2600 Sixth Street SW, Canton, OH 44710
- Ghaffari, Masoud** *ghaffari@etsu.edu*
East Tennessee State University, 195 Eastern Star Road,
Kingsport, TN 37663
- Giebelhaus, Carmen** *drgieb@aol.com*
ETS Praxis Workshop, 9500 Lehr Court, Manassas, VA 20110
- Gilbertson, Stephanie** *Gilbersa@ucmail.uc.edu*
University of Cincinnati, 511C Dyer Hall, PO Box 210002,
Cincinnati, OH 45221

- Goddard, Connie** *conniegoddard@comcast.net*
Roosevelt University, College of Education, 430 S. Michigan Ave,
Chicago, IL 60605
- Gombach, Marlene** *megombach@yahoo.com*
Cleveland State University, 2121 Euclid Ave., MC 218B,
Cleveland, OH 44115
- Goudy, Roger** *Russell.C.Brown@cmsdnet.net*
South Euclid-Lyndhurst Schools, 5044 Mayfield Rd.,
Lyndhurst, OH 44121
- Graham, Barbara** *bmgraham1@bsu.edu*
Ball State University, Dept. of Educational Studies, Muncie, IN 47306
- Green, James** *jim_green@mail.msjs.edu*
College of Mount St. Joseph, 7855 Trailwind Dr., Cincinnati, OH 45242
- Greer, Rodney** *RJ-Greer@wiu.edu*
Western Illinois University, 76 Horrabin Hall, Macomb, IL 61455-1390
- Guidry, Kellye** *kguidry1@sbcglobal.net*
Northern Illinois University, 1927 South State, Unit 4, Chicago, IL 60616
- Harris, Bill** *SD19@mailr.sen.state.oh.us*
Ohio Senate, Statehouse, Room #201, Second Floor,
Columbus, OH 43215
- Harris, Jr., William** *grovhannzs15@hotmail.com*
University of Kentucky, 131 Taylor Education Building,
Lexington, KY 40506
- Hassenpflug, Ann** *hassenp@uakron.edu*
University of Akron, Dept. of EF&L, College of Education, Zook 301,
Akron, OH 44325-4208
- Haynes, Thomas** *tshayne@ilstu.edu*
Illinois State University, Campus Box 5330,
Curriculum and Instruction, Normal, IL 61790
- He, Wei** *hewei1@msu.edu*
Michigan State University, 1724 E. Grand River Ave. Apt. 001,
East Lansing, MI 48823
- Heanacho, Ashimunezedrheanacho@yahoo.com**
Central Michigan University, 3820 East Pierce Road, Ithaca, MI 48847
- Heh, Victor** *vh101201@ohio.edu*
Ohio University, 1030 Carriage Hill Dr, Athens, OH 45701
- Herrelko, Janet** *janet.herrelko@udayton.edu*
University of Dayton, 357 Cork Elm Trail, Beavercreek, OH 45440
- Hines, Laurie** *lhines@kent.edu*
Kent State University-Trumbull, Cultural Foundations of Education,
4314 Mahoning Ave., NW, Warren, OH 44483
- Hofmann, Rich** *hofmanr@muohio.edu*
Miami University, 350 McGuffey Hall, Oxford, OH 45056
- Holder, Kim** *phillips@rowan.edu*
Rowan University, 935 Manatawana Avenue, Philadelphia, PA 19128
- Holt, Janet K.** *jholt@niu.edu*
Northern Illinois University, ETRA Department, DeKalb, IL 60115
- Hovsepiyan, Kristen** *khovsepi@ashland.edu*
Ashland University, 401 College Avenue, Ashland, OH 44805
- Hsieh, Min-Hua** *evaeva123@hotmail.com*
Northern Illinois University, 820 N. Annie Glidden 403,
DeKalb, IL 60115
- Huang, Yu-Chuan** *yxh156@psu.edu*
Pennsylvania State University, 111 Osborn Hall White Course,
University Park, PA 16802
- Hung, Hsin-Ling** *hung.33@osu.edu*
Ohio State University, 515 Riverview Dr. Apt. 307,
Columbus, OH 43202
- Hunn, Diane** *hunndm@muohio.edu*
Miami University, Institute for Integrated Science, Billings Hall,
Oxford, OH 45056
- Hwang, Yooyeun** *Hwang@hope.edu*
Hope College, Holland, MI 49422
- Ifedi, Rosaire** *Rifedisis@aol.com*
Ashland University, 1735 Scottsdale Avenue, Columbus, OH 43235
- Ilg, Tim** *tim.ilg@notes.udayton.edu*
University of Dayton, College of Education, Dayton, OH 45469
- Isaacson, Randy** *risaacso@iusb.edu*
Indiana University South Bend, 1700 Mishawaka Avenue,
South Bend, IN 46615
- Jackson, Thomas** *tjackson2@yahoo.com*
Northern Illinois University, 669 Tamarisk Terrace,
Crystal Lake, IL 60014
- Janak, Edward** *EJanak@uwyo.edu*
University of Wyoming, Dept. of Educational Studies, Dept. 3374,
1000 E. University Ave., Laramie, WY 82071-3374
- Johanningmeier, Erwin** *Johannin@tempest.coedu.usf.edu*
University of South Florida, Social Foundation, EDU 162,
Tampa, FL 33620
- Johanson, George** *johanson@ohio.edu*
Ohio University, 314A McCracken Hall, Athens, OH 45701
- Johnson, Christina** *parisht@uiiu.edu*
Upper Iowa University, c/o Thomas Parish, Psychology,
29 Professional Building, Fayette, IA 52142
- Johnson, Joan** *joanmjohnson@comcast.net*
Northeastern Illinois University, 1022 Seward Street,
Evanston, IL 60202
- Johnson, Vicki** *v.d.johnson01@csuohio.edu*
Cleveland State University, 2121 Euclid Ave, CB, Cleveland, OH 44115
- Johnson-Whitt, Eugenia** *ewhitt@jecc.org*
University of Akron, 32580 Arlesford Drive, Solon, OH 44139
- Jones, Bruce** *bjones@ndc.edu*
Notre Dame College, 4545 College Road, South Euclid, OH 44121
- Jones, Melissa** *mljones2@eiu.edu*
Eastern Illinois University, Dept of Special Education, 1212 Buzzard
Hall, 600 Lincoln Avenue, Charleston, IL 61920
- Jorissen, Kathleen** *ktjoris@bgnet.bgsu.edu*
Bowling Green State University, 507 Education Building,
Bowling Green, OH 43403
- Jurczyk, Joe** *jurczyk@yahoo.com*
University of Akron, 10022 Gatewood Dr., Brecksville, OH 44141
- Justice, Benjamin** *bjust@rci.rutgers.edu*
Rutgers University, 10 Seminary Place,
New Brunswick, NJ 08901-1183
- Kalaian, Sema** *skalaian@emich.edu*
Eastern Michigan University, 145 Sill Hall, Ypsilanti, MI 48197
- Kalkman, Deborah** *dkalkman@niu.edu*
Northern Illinois University, Gabel Hall 101D, DeKalb, IL 60115
- Kang, Haijun** *hxx229@psu.edu*
Pennsylvania State University, 315 Keller Building,
University Park, PA 16801

- Kang, Zongmin** *zmkang@yahoo.com*
University of Toledo, 2650 Drummond Road, Toledo, OH 43606
- Kanyongo, Gibbs** *kanyongog@duq.edu*
Duquesne University, 410A Canevin Hall, 600 Forbes Avenue,
Pittsburgh, PA 15237
- Karasu, Necdet** *nkarasu@indiana.edu*
Indiana University, 1025 Persimmon Tree Circle,
Bloomington, IN 47403
- Karpinski, Carol** *karpin@fdu.edu*
Fairleigh Dickinson University, 1000 River Rd TBH2-01,
Teaneck, NJ 07666
- Kasim, Rafa** *rkasim@kent.edu*
Kent State University, Educational Foundations & Special Services
Dept, 507 E White Hall, Kent, OH 44242
- Kearney, Janet** *drkearney@columbus.rr.com*
Ashland University, Columbus Center, 520 Whitson Drive,
Gahanna, OH 43230
- Kellogg, Sharon** *gowest@wowway.com*
Ashland University, 7411 Murrayfield Drive, Worthington, OH 43085
- Kessinger, Thomas** *Kessinger@Xavier.edu*
Xavier University, 3800 Victory Parkway, 107 Elet,
Cincinnati, OH 45207
- Kidder, Ralph** *rkidder@newbury.edu*
Newbury College, 129 Fisher Ave, Brookline, MA 02445
- Kim, Hyosun** *kim.1667@osu.edu*
The Ohio State University, 287 Arps Hall, 1945 N High Street,
Columbus, OH 43210
- Kim, Soonhyang** *kim.1259@osu.edu*
The Ohio State University, 1871 Wetherburn Drive,
Columbus, OH 43235
- Kim, Yang Eun** *yuk120@psu.edu*
Pennsylvania State University, 425 Waupelani Dr. #320,
State College, PA 16801
- Kim, Yonghee** *kim.915@osu.edu*
Ohio State University, 315 Ramseyer Hall, 29 West Woodruff Ave.,
Columbus, OH 43210
- Klecker, Beverly** *b.klecker@morehead-st.edu*
Morehead State University, 503 Ginger Hall, Morehead, KY 40351
- Kline, Charles** *chuck@purdue.edu*
Purdue University, 5136 Beering Hall, West Lafayette, IN 47907
- Koh, Myung-sook** *mskohshin@hotmail.com*
Eastern Michigan University, School of Education, Ypsilanti, MI 48197
- Kokinova, Margarita** *mkokinov@neoucom.edu*
Northeastern Ohio Universities College of Medicine,
4209 State Route 44, PO Box 95, Rootstown, OH 44272
- Koomson, William** *wkk109@psu.edu*
Pennsylvania State University College of Education, 3734 W 137th St.,
Cleveland, OH 44111
- Kourea, Lefki** *kourea.1@osu.edu*
Ohio State University, 2330 Neil Avenue Apt. D, Columbus, OH 43202
- Kowalski, Theodore** *theodore.kowalski@notes.udayton.edu*
University of Dayton, Chaminade Hall - Room 101,
300 College Park, Dayton, OH 45469
- Kula, Kevin** *kula.8@osu.edu*
The Ohio State University - TQP Project, 1087 Tenagra Way,
Columbus, OH 43228
- Lahey, Laurie** *phillips@rowan.edu*
George Washington University, c/o Anne Phillips, 935 Manatawna Ave.,
Philadelphia, PA 19128
- Lane, Terri** *mtlane@woh.rr.com*
University of Dayton, Counselor Education and Human Services
Department, 300 College Park, Dayton, OH 45469
- Laux, John** *john.laux@utoledo.edu*
University of Toledo, MS 119, Toledo, OH 43606
- Lavin Crerand, Marymcrerand** *@ashland.edu*
Ashland University - Columbus Center, 1900 East Dublin-Granville Rd.,
Columbus, OH 43229-3553
- Lee, Seongjik** *seojlee@hotmail.com*
University of Kentucky, 131 Taylor Education Building,
Lexington, KY 40506
- Lennex, Lesia** *l.lennex@morehead-st.edu*
Morehead State University, 503 Ginger Hall, Counseling, Leadership,
Adult, and Secondary Education, Morehead, KY 40351
- Levine, Jay** *Jay10@uakron.edu*
The University of Akron School of Law, 302 Buchtel Commons,
Akron, OH 44325
- Lewis, Marsha** *lewism5@ohio.edu*
Ohio University, Voinovich Center for Leadership and Public Affairs,
Building 21, The Ridges, Athens, OH 45701
- Li, Tianli** *litianli@msu.edu*
Michigan State University, 931 Cherry Lane Apt G,
East Lansing, MI 48823
- Liang, Xin** *liang@uakron.edu*
University of Akron, Zook Hall 301N, Akron, OH 44325
- Linderman, Jon** *jonlinderman@udayton.edu*
University of Dayton, 300 College Park, Dayton, OH 45506
- Liu, Diyan** *liudiyan@hotmail.com*
Miami University, Educational Psychology Department,
Oxford, OH 45056
- Loadman, Wiliam** *loadman.1@osu.edu*
The Ohio State University, 149 Arps, 1945 North High Street,
Columbus, OH 43210
- Loe, David** *dloe@kent.edu*
Kent State University, 11605 Edgewood Rd, Chardon, OH 44024
- LoPrieno, Ann Marie** *a-loprieno@northwestern.edu*
Northwestern University, 633 Clark St, Evanston, IL 60208
- Love, Brenda** *brendaleelove2@aol.com*
Private, 3180 Happy Valley Road, Sun Prairie, WI 53590
- Lugg, Catherine** *luggaun@earthlink.net*
Rutgers University, 1604 Taggart Drive, Belle Mead, NJ 08502
- Martinez, Sylvia** *sylviam@ku.edu*
University of Kansas, 2328 Ranch Way, Lawrence, KS 66047
- Ma, Lingling** *Lingling-Ma@uky.edu*
University of Kentucky, 131 Taylor Education Building,
Lexington, KY 40506
- Madden, Paul** *pmadden@shawnee.edu*
Ohio University, 3199 Woodridge Way, Portsmouth, OH 45662
- Magnuson, Mark** *mmagnuso@ivytech.edu*
Ivy Tech State College - Central Indiana, One West 26th Street,
Indianapolis, IN 46206
- Malone, Michael** *d.michael.malone@uc.edu*
University of Cincinnati, Early Childhood Education Program One
Edwards Center, Room 2150-U, Cincinnati, OH 45221-0105

- Mansberger, Nancy** *nancy.mansberger@wmich.edu*
Western Michigan University, 35951 44th Avenue, Paw Paw, MI49079
- Mansfield, Eric** *EA-Mansfield@wiu.edu*
Western Illinois University, 1 University Circle HH80V,
Macomb, IL 61455
- Marion, Virginia** *vmarion@ursuline.edu*
Ursuline College, 2550 Lander Road, Pepper Pike, OH 44124
- Marrs, Heath** *hmarrs@fhsu.edu*
Fort Hays State University, 600 Park Street, Hays, KS 67601
- Marsh, Catherine** *cmarsh@northpark.edu*
North Park University, 5455 N. Sheridan Rd. #1006, Chicago, IL 60640
- Martinez, Tiffany** *tahagu2@uky.edu*
University of Kentucky, 131 Taylor Education Building,
Lexington, KY 40506
- Matthews-Lopez, Joy** *matthej2@ohio.edu*
Ohio University-COM, 422 Grosvenor Hall, Athens, OH 45701
- May, Charles** *charles.may@uni.edu*
University of Northern Iowa, College of Education,
Cedar Falls, IA 50614
- May, Dale** *dmay@usd506.k12.ks.us*
Pittsburg State University, 215 Oak, Mound Valley, KS 67354
- May, Judy** *judyjac@bgnet.bgsu.edu*
Bowling Green State University, 517 Education Building,
Bowling Green, OH 43403
- McDaniel, Grace** *GMcDaniel@otterbein.edu*
Otterbein College, 442 Roush Hall, Westerville, OH 43228
- McGuire, Dan** *dmcguire1@ncusd203.org*
Northern Illinois University, 1509 Longbranch Ct, Naperville, IL 60565
- McKnight, Oscar** *omcknigh@ashland.edu*
Ashland University, 247 HCSC, Ashland, OH 44805
- McNeely, Sharon** *mcneelys@execpc.com*
Northeastern Illinois University, 5500 North St. Louis,
Chicago, IL 60634
- McNeil, Keith** *kmcneil@nmsu.edu*
New Mexico State University, Box 3CEP, Las Cruces, NM 88003
- Mertler, Craig** *mertler@bgnet.bgsu.edu*
Bowling Green State University, College of Education Room 550,
Bowling Green, OH 43403
- Metzger, Scott** *metzgers@msu.edu*
Michigan State University, 895 Haslett Rd., Williamston, MI 48895
- Mickell, Willie** *wmickell@yahoo.com*
Northern Illinois University, 1515 W. Lincoln Hwy.,
NIU Convocation Center, DeKalb, IL 60115
- Miller, Larry** *miller.103@osu.edu*
Ohio State University, 204 Ag. Adm. Bldg., 2120 Fyffe Road,
Columbus, OH 43210
- Montalvo, Greg** *gp-montalvo@wiu.edu*
Western Illinois University, 80 Horrabin Hall, 1 University Circle,
Macomb, IL 61455
- Moore, David** *moored3@ohio.edu*
Ohio University, 250 McCracken Hall, Ohio University, Athens, OH
45701
- Moore, Raéal** *moore.1219@osu.edu*
The Ohio State University, 29 W. Woodruff Avenue,
310D Ramseyer Hall, Columbus, OH 43210
- Morris, John** *morris_j@shaker.org*
Cleveland State University, 2504 E. 126th St., Cleveland, OH 44120
- Moss, Glenda** *moss@ipfw.edu*
Indiana University Purdue University Fort Wayne,
2101 E. Coliseum Blvd., Fort Wayne, IN 46805
- Mrozek, Lawrence** *mrozek.5@osu.edu*
The Ohio State University, 2506 Indianola Ave., Columbus, OH 43202
- Murray, James** *murrayja@umsl.edu*
University of Missouri St. Louis, One University Boulevard,
St. Louis, MO 63139
- Myers, Nathan** *jennynate_2000@yahoo.com*
Ashland University, 401 College Avenue, Bixler Hall,
Ashland, OH 44805
- Nagata, Noriko** *Nagata.3@osu.edu*
The Ohio State University, 3178 Bethel Rd. APT-210,
Columbus, OH 43220
- Navarro, Virginia** *virginia_navarro@umsl.edu*
University of Missouri St. Louis, One University Boulevard,
St. Louis, MO 63139
- Newman, Carole** *cnewman@uakron.edu*
The University of Akron, 302 Buchtel Commons, Akron, OH 44325
- Newman, David** *d.o.newman@csuohio.edu*
Cleveland State University, 2121 Euclid Avenue Suite 1500,
Cleveland, OH 44115
- Newman, Isadore** *inewman@uakron.edu*
The University of Akron, 302 Buchtel Commons, Akron, OH 44325
- Ngudgratoke, Sungworn** *ngudgrat@msu.edu*
Michigan State University, 1544 Spartan Village Apartments K,
EastLansing, MI 48823
- Nolan, Robert** *bob.nolan@okstate.edu*
Oklahoma State University, School of Educational Studies,
205 Willard Hall, Stillwater, OK 74078
- Oberlander, Judith** *Judith.Oberlander@notes.udayton.edu*
University of Dayton, School of Education, 202H Chaminade Hall,
300 College Park, Dayton, OH 45469
- Obiekwe, Jerry** *obiekwe@uakron.edu*
University of Akron-Wayne College, P.O. Box 411, Orrville, OH 44667
- O'Brien, Thomas** *joseph.watras@notes.udayton.edu*
Ohio State University at Mansfield, c/o Joe Watras,
University of Dayton, Dayton, OH 45469
- Parish, Thomas** *parisht@uiu.edu*
Upper Iowa University and Kansas State University, 605 Washington St.,
P. O. Box 1857, Fayette, IA 52142
- Park, Eun Jung** *park.565@osu.edu*
Ohio State University, 7612 Cutters Edge Ct. Apt #F.,
Dublin, OH 43016
- Parker, Abigail** *abparker@butler.edu*
Butler University, 5882 Kennesaw Trail, Columbus, IN 47203
- Parmigian, Guy** *Parmiggl@muohio.edu*
Miami University, 402 Heather Lane, Apt. 5, Oxford, OH 45056
- Partlow, Michelle** *michelle.partlow@notes.udayton.edu*
University of Dayton, Learning Teaching Center, Dayton, OH 45469
- Paul, Kelli** *kelpaul@indiana.edu*
Indiana University, Educational Psychology, Bloomington, IN 47405
- Perosa, Sandra** *sperosa@uakron.edu*
The University of Akron, 127 Carroll Hall, Akron, OH 44325
- Petersen, Naomi Jeffery** *NJP@iusb.edu*
Indiana University South Bend, 2110 Spring Hill,
South Bend, IN 46628

- Phillips, Anne** *phillips@rowan.edu*
Rowan University, 935 Manatawna Avenue, Philadelphia, PA 19128
- Pierce, Jean** *jeanpierce@aol.com*
Northern Illinois University, LEPP Department, DeKalb, IL 60115
- Pietrasz, Carol** *cpietras@ashland.edu*
Ashland University, 401 College Avenue, Ashland, OH 44805
- Pinzone, Sharon** *sharoncom@adelphia.net*
Cleveland State University, 16401 Claire Avenue, Cleveland, OH 44111
- Pittman, Kim** *KPitt39264@aol.com*
Aurora University, 980 Raleigh Road, Glenview, IL 60025
- Place, A. William** *will.place@notes.udayton.edu*
University of Dayton, Dept. of Educational Leadership,
Dayton, OH 45469
- Poster, John** *jposter@umd.umich.edu*
University of Michigan-Dearborn, School of Education,
19000Hubbard Dr., Dearborn, MI 48126
- Powell, Barbara** *cfbmp@eiu.edu*
Eastern Illinois University, Department of Counseling
and Student Development, 600 Lincoln, Charleston, IL 61920
- Pugh, Cathy** *pugh@ohio.net*
Ohio University, College of Education, Athens, OH 45701
- Qin, Xiao** *qinx@muohio.edu*
Miami University, Educational Psychology Department,
Oxford, OH 45056
- Quade, Scott** *quades@mail.mcsoh.org*
Medina High School, 777 East Union Street, Medina, OH44256-1992
- Ramanathan, Hema** *hramanat@butler.edu*
Butler University, 4600 Sunset Avenue, Indianapolis, IN 46208
- Ramlo, Susan** *sramlo@uakron.edu*
The University of Akron, Department of Engineering & Science
Technology, Schrank Hall South 123, +6104, Akron, OH 44325
- Randolph, Adah** *wardrand@ohio.edu*
Ohio University, 248 McCracken Hall, Athens, OH 45701
- Rausch, John** *jrausch@jcu.edu*
John Carroll University, Dept. of Education, 20700 North Park Blvd.,
University Heights, OH 44118
- Reams, Paula** *PaulaR128@earthlink.net*
University of Dayton, 128 Deer Trail Drive, Springboro, OH 45066
- Richardson, Theresa** *theresa.joseph.watras@notes.udayton.edu*
Ball State University, c/o Joe Watras, University of Dayton,
Dayton, OH 45469
- Richter, Dirk** *richter.63@osu.edu*
Ohio State University, 61 E Northwood, Columbus, OH 43201
- Ridenour, Carolyn** *carolyn.ridenour@notes.udayton.edu*
University of Dayton, Chaminade Hall 310, Dayton, OH 45469
- Ritchey, Jeffrey** *jritchey@psu.edu*
Pennsylvania State University, 302 Beaver St., Hollidaysburg, PA 16648
- Roberts, Jean** *jeana_roberts@yahoo.com*
University of Toledo, MS 119, 2801 West Bancroft,
Toledo, OH 43606-4208
- Rogers, Bruce** *bruce.rogers@uni.edu*
University of Northern Iowa, Dept. of Educational Psychology,
Cedar Falls, IA 50614
- Roland, Elizabeth** *elizabeth.edwards@uky.edu*
University of Kentucky, 335 Dickey Hall, Lexington, KY 40324
- Rose, Amy** *arose@niu.edu*
Northern Illinois University, Dept. of Counseling, Adult,
and Higher Education, DeKalb, IL 60115
- Roseman, Chris** *christopher.roseman2@verizon.net*
University of Toledo, MS 119, Toledo, OH 43606-3390
- Roulette-McIntyre, Ovella** *ovrm@earthlink.net*
Cleveland State University, 2996 Warrensville Center Road,
Shaker Heights, OH 44122
- Rovnak, Amanda** *taylor3@ukron.edu*
University of Akron, 426 Marviel Drive, Fairlawn, OH 44333
- Royal, Kenneth** *kdroya2@uky.edu*
University of Kentucky, 131 Taylor Education Building,
Lexington, KY 40515
- Rugutt, John** *jkrugut@ilstu.edu*
Illinois State University, Campus Box 5900, 331 DeGarmo Hall,
Normal, IL 61790
- Russell, Joy** *cfjlr@eiu.edu*
Eastern Illinois University, Dept of Special Education,
1212 Buzzard Hall-600 Lincoln Avenue, Charleston, IL 61820
- Rutter, J. Paul** *jpr12@psu.edu*
Pennsylvania State University, 528 Clarence Ave,
State College, PA 16803
- Ryan, Ann Marie** *aryan3@luc.edu*
Loyola University Chicago, School of Education,
820 N. Michigan Avenue, 11th Floor, Chicago, IL 60611
- Sadler, Lesa** *sevengen@hotmail.com*
Pennsylvania State University, 2409 Boudreau, Urbana, IL 61801
- Sampson, Shannon** *shannon.sampson@uky.edu*
University of Kentucky, 131 Taylor Education Building,
Lexington, KY 40506
- Sarther, Diane** *sarther@aol.com*
Northern Illinois University, 818 S. Vine St., Hinsdale, IL 60521
- Schilling, Alvin** *al@alschilling.com*
University of Florida, 641 NW 36th Drive, Gainesville, FL 32607
- Schommer-Aikins, Marlene** *marlene.schommer-aikins@wichita.edu*
Wichita State University, College of Education #123,
Wichita, KS 67260
- Schopieray, Scott** *schopie1@msu.edu*
Michigan State University, 4103 Kirkway Ct., Howell, MI48843
- Schroeder, Lucia** *cfilas@ux1.cts.eiu.edu*
Eastern Illinois University, Early Childhood/Elementary Education/
Middle Level, 2200 Buzzard Hall, 600 Lincoln, Charleston, IL 61920
- Schwartz, Michael** *michael.schwartz@csuohio.edu*
Cleveland State University, 2121 Euclid Avenue, RT 1201,
Cleveland, OH44115
- Seals, Greg** *seals@mail.csi.cuny.edu*
College of Staten Island/CUNY, Education Dept 3S-208,
2800 Victory Blvd., Staten Island, NY 10314
- Senteney, Hua** *senteneh@ohio.edu*
Ohio University, 54 Nurad Rd., Athens, OH 45701
- Shah, Hiral** *hiral.shah@emich.edu*
Eastern Michigan University, 118 Sill Hall, Ypsilanti, MI 48197
- Shaw, Carla** *cshaw@niu.edu*
Northern Illinois University, Dept. of Teaching and Learning,
Gabel Hall 156, DeKalb, IL 60115

- Shen, Chia-Shen** *czs131@psu.edu*
 Pennsylvania State University, 16-C, Graduate Circle,
 State College, PA 16801
- Sheppard, David** *davids@tricity607.com*
 TriCounty Special Education, 220 E. Chestnut,
 Independence, KS 67301
- Sherman, Lawrence** *shermalw@muohio.edu*
 Miami University, Department of Educational Psychology,
 McGuffey Hall, Oxford, OH 45056
- Sherman, Shelley** *sherman@hermes.lfc.edu*
 Lake Forest College, 555 N. Sheridan Road, Lake Forest, IL 60045
- Siebert, Cathy** *cjsiebert@bsu.edu*
 Ball State University, 802 Teachers College, Muncie, IN 47306
- Sigler, Ellen** *elsigler@iuk.edu*
 Indiana University Kokomo, 2300 S. Washington, Kokomo, IN 46904
- Silva, Melissa** *melissasilva2@verizon.net*
 Northern Illinois University, 12702 Courtney Drive,
 Quantico, VA 22134
- Sinclair, Thomas** *tjsinclair@eiu.edu*
 Eastern Illinois University, Dept of Special Education,
 1212 Buzzard Hall-600 Lincoln Avenue, Charleston, IL 61920
- Slutsky, Ruslan** *rslutsk@utnet.utoledo.edu*
 University of Toledo, 3040 Snyder Memorial, 2801 W. Bancroft Street,
 Toledo, OH 43606
- Smith, Denise** *drdms@prodigy.net*
 California State University-Monterey Bay, 12765 Fair Way,
 Watsonville, CA 95076
- Smith, Thomas** *tjsmith@niu.edu*
 Northern Illinois University, Dept. of ETRA, College of Education,
 Northern Illinois University, DeKalb, IL 60115
- Smith Jr., Everett** *evsmith@uic.edu*
 University of Illinois at Chicago, 1040 West Harrison Street,
 Chicago, IL 60607
- Sommers, Kathleen** *ksedd03@aol.com*
 Ashland University, 2613 Sterling Oaks, Grove City, OH 43123
- Spearman, Patrick** *phillips@rowan.edu*
 Rowan University, 935 Manatawna Avenue, Philadelphia, PA 19128
- Spickard Prettyman, Sandrassandra** *spickard@uakron.edu*
 University of Akron, 326 Zook Hall, Akron, OH 44325-4208
- Spidell, Cathy** *cspidel@uakron.edu*
 University of Akron, 8248 Arlington Ave. N.W.,
 North Canton, OH 44720
- Sposet, Barbara** *bsposet@ndc.edu*
 Notre Dame College, 4545 College Road, South Euclid, OH 44121
- Stone, William** *stone@sxu.edu*
 Saint Xavier University, School of Education, 3700 W. 103rd Street,
 Chicago, IL 60655
- Stuckey, Angeline** *astuckey@niu.edu*
 Northern Illinois University, Gabel Hall 148, DeKalb, IL 60115
- Stuckey-Mickell, Tracey** *tstuckey@niu.edu*
 Northern Illinois University, 208 Gabel Hall, DeKalb, IL 60115
- Subedi, Dipendra** *subedidi@msu.edu*
 Michigan State University, 1422 Spartan Village, Apartment E,
 East Lansing, MI 48823
- Sudzina, Mary** *sudzina@udayton.edu*
 University of Dayton, 300 College Park, Dayton, OH 45469
- Suggs, Robert** *rsuggs@ashland.edu*
 Ashland University, 205 Founders, 401 College Avenue,
 Ashland, OH 44805
- Talbert-Johnson, Carolyn** *Carolyn.Johnson@notes.udayton.edu*
 University of Dayton, 300 College Park, 228C Chaminade,
 Dayton, OH 45469
- Tandoc, Bonnie** *tandocbe@wichtaclinic.com*
 Wichita State University, 720 Medical Center Drive, Newton, KS 67114
- Taylor, KayAnn** *KayAnn.Taylor@fredonia.edu*
 SUNY Fredonia, Foundations of Education, College of Education,
 E278 Thompson Hall, Fredonia, NY 14063
- Tekin, Ali** *akt135@psu.edu*
 Pennsylvania State University, College of Education,
 12-H Graduate Circle, State College, PA 16801
- Thomas, Charles** *cthomas@gmu.edu*
 George Mason University, 4400 University Drive, Fairfax, VA 22030
- Thomas, Kelli** *kthomas@ku.edu*
 University of Kansas, Dept. of Teaching and Leadership,
 1122 W. Campus Road, Room 343, Lawrence, KS 66045
- Tsai, Min Ju** *mxt926@psu.edu*
 Pennsylvania State University, 915 Southgate Dr. Apt 12,
 State College, PA 16801
- Turk, Randy** *randy.turk@cox.net*
 Wichita State University, Campus Box 2, Wichita, KS 67206-0142
- Turner, Sandra** *turners@ohio.edu*
 Ohio University, McCracken Hall, College of Education,
 Athens, OH 45701
- Turner, Susan** *szt1@uakron.edu*
 University of Akron, 472 Park Ave., Salem, OH 44460
- Valente, Sharon** *svalente@ashland.edu*
 Ashland University, 247 Dauch, 401 College Avenue,
 Ashland, OH 44805
- Vivian, Craig** *cvivian@monm.edu*
 Monmouth College, 700 East Broadway, Monmouth, IL 61462
- Vogt, Paul** *wpvogt@ilstu.edu*
 Illinois State University, DeGarmo 339, Normal, IL 61790
- Vonderwell, Selma** *s.vonderwell@csuohio.edu*
 Cleveland State University, 1180 Chambers Rd. 103-B,
 Columbus, OH 43212
- Walker, David** *dawalker@niu.edu*
 Northern Illinois University, ETRA Department, 101J Gabel,
 DeKalb, IL 60115
- Wallace, Steve** *swallace@niu.edu*
 Aurora University, 59 Snow Street, Sugar Grove, IL 60554
- Wallenstein, Peter** *pwallens@vt.edu*
 Virginia Tech, Dept. of History (0117), Blacksburg, VA 24061
- Walters, Howard** *hwalters@ashland.edu*
 Ashland University, 401 College Avenue, Ashland, OH 44805
- Wang, Aimin** *wanga@muohio.edu*
 Miami University, 118 McGuffey Hall, Oxford, OH 45056
- Wang, Weirong** *wwang@ilstu.edu*
 Illinois State University, O-168, Cardinal Court, Normal, IL 61761
- Wastyn, M. Linda** *WastynLindaM@sau.edu*
 Illinois State University, SAU Advancement Office,
 518 West Locust Street, Davenport, IA 52803

Watras, Joseph *joseph.watras@notes.udayton.edu*
University of Dayton, Dept. of Teacher Education, 300 College Park,
Dayton, OH 45469-0525

Webb, Ali *kbrad2@uky.edu*
University of Kentucky, 131 Taylor Education Building,
Lexington, KY 40506

Weber, Jennifer *jweber@uky.edu*
University of Kentucky, 527 Lake Tower #59, Lexington, KY 40502

Webster, Deborah *d.d.webster@csuohio.edu*
Cleveland State University, 422 Sun Valley Drive, Akron, OH 44333

Wellen, Lauren *Lauren.Wellen@curf.edu*
Concordia University, 7400 Augusta Street, River Forest, IL 60305

Wendel, Paul *pwendel@kent.edu*
Kent State University, 4261 Scarlet Oak Dr., Copley, OH 44321

White, Jeffrey *white.795@osu.edu*
The Ohio State University, 6605 Farlook Court, Columbus, OH 43231

Whittington, M. Susie *whittington.1@osu.edu*
The Ohio State University, 2120 Fyffe Rd, Columbus, OH 43210

Wiggins, Kathryn *kwiggins@depaul.edu*
DePaul University, School of Education, 2320 N. Kenmore,
Chicago, IL 60614

Wilkins, Elizabeth *ewilkins@niu.edu*
Northern Illinois University, Dept. of Teaching and Learning,
DeKalb, IL 60115

Wolff, Robert *wolffr@mail.ccsu.edu*
Central Connecticut State University, Dept. of History,
208 DiLoreto Hall, 1615 Stanley St, New Britain, CT 60500

Yang, Jianxiang *yangjl@muohio.edu*
Miami University, EDP, Miami University, Oxford, OH 45056

Yang, Qingling *qlyang88@yahoo.com*
Cleveland State University, 1545 East 32nd Street,
Cleveland, OH 44114

Yao, Jie *yao.49@osu.edu*
The Ohio State University, College of Education,
643 Tuscarawas Court, Columbus, OH 43210

Yeh, Ling-Miao *lingmyeh@yahoo.com*
The Ohio State University, 39 North St. Apt C1, Columbus, OH 43202

Yew, Feiye *yew.3@osu.edu*
The Ohio State University, 231 W18th Ave, Columbus, OH 43210

Young, Jennifer *jyoung4@wisc.edu*
University of Wisconsin, 905 University Ave, Suite 401,
Madison, WI 53715-1005

Yuan, Guofang *qlyang88@yahoo.com*
Cleveland State University, 1545 East 32nd Street,
Cleveland, OH 44114

Zahner, Mary *mary.zahner@notes.udayton.edu*
University of Dayton, 2649 Greystoke Ct, Xenia, OH 45385

Zigler, Ted *ted.zigler@uc.edu*
University of Cincinnati, 405 Teachers College,
Cincinnati, OH 45221-0002

Zimmerman, Judith *judithz@bgnet.bgsu.edu*
Bowling Green State University, EALS - Room 511 - Education Bldg.,
Bowling Green, OH 43403



The Board of Directors of MWERA would like to extend special thanks to the Ashland University Chapter of Students in Free Enterprise for their assistance during our 2005 conference.



SIFE is a global, non-profit organization that is literally changing the world through highly dedicated student teams on more than 1600 university campuses in 40 countries. SIFE offers these students the opportunity to develop leadership, teamwork and communication skills through learning, practicing and teaching the principles of free enterprise, thereby improving the standard of living for millions in the process. Guided by distinguished faculty advisors and supported by businesses around the globe, SIFE Teams teach important concepts through educational outreach projects, including market economics, entrepreneurship, personal and financial success, and business ethics to better themselves, their communities and their countries.



THE WESTIN
GREAT SOUTHERN
Columbus

Meeting space at-a-glance 12004 square feet

Lobby Level



Second Floor

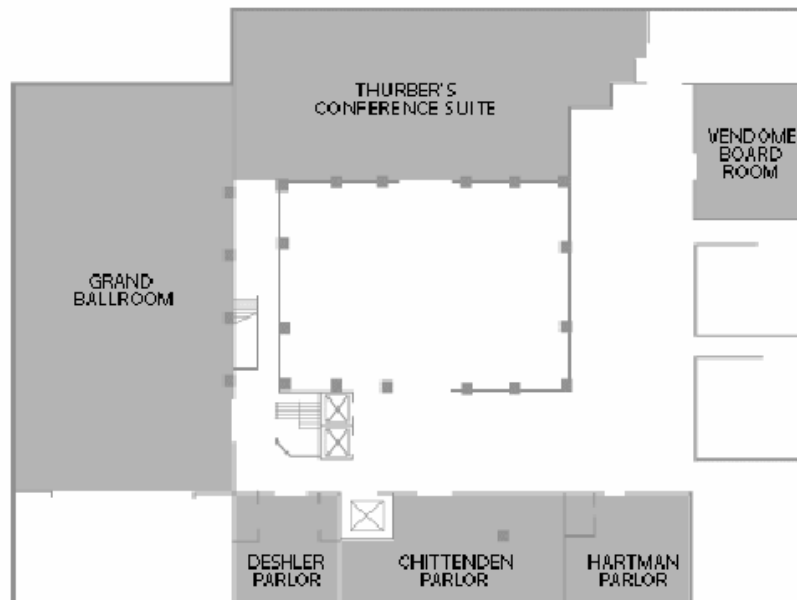

Conference At-A-Glance

| Time | MWERA Registration Desk | Chittenden Parlor (CP) | Deschler Parlor (DP) | Grand Ballroom (GB) | Hartman Parlor (HP) | Great Southern Gallery (GSG) | Neil House Parlor (NH) | Park Parlor (PP) | Seneca Parlor (S) | Thurber's Conference Suite (TC) | Vendome Board Room (VB) |
|------------------------------------|-------------------------|------------------------|---------------------------------|-----------------------------|---------------------|------------------------------|-------------------------------|------------------------------------|------------------------|--|-------------------------|
| Wednesday, October 12, 2005 | | | | | | | | | | | |
| 1:00 p.m. | 1:00 - 6:00 p.m. | | | | | | HLM Workshop | Grant Workshop | | | |
| 4:00 p.m. | | | | | | | | Focus Group Workshop | | | |
| 8:00 p.m. | | | | | | | Fireside Chat Dr. Schwartz | | | | |
| Thursday, October 13, 2005 | | | | | | | | | | | |
| 8:00 a.m. | 8:00 a.m. - 5:00 p.m. | Division C | Division L | | Division G | | Division D | Division F | Division K | Division H | |
| 9:30 a.m. | | | Keynote Address Dr. Schwartz | | | | | | | | |
| 10:30 a.m. | | Keynote Follow-Up | Division E | | Division G | New Member Welcome | Division D | Division A | Division H | Division K | |
| 12:00 p.m. | | | | Association Council | | | | | | | |
| 1:40 p.m. | | Division D | Division F | | Division C | | Division L | Facilitating Case Studies Workshop | Division G | Metacognitive Knowledge Monitoring Workshop | |
| 3:10 p.m. | | Division J | Division C | Divisions C & D Roundtables | Division B | | Division D | Division A | Division E | Faculty Issues in Academic Integrity Invited Panel | |
| 4:40 p.m. | | Division D | Division I | Book Signing | Division L | | Division K | Division J | Student Member Meeting | Division G | |
| 6:00 p.m. | | | | Cracker Barrel Social | | | | | | | |

Conference At-A-Glance

| Time | MWERA Registration Desk | Chittenden Parlor (CP) | Deschler Parlor (DP) | Grand Ballroom (GB) | Hartman Parlor (HP) | Great Southern Gallery (GSG) | Neil House Parlor (NH) | Park Parlor (PP) | Seneca Parlor (S) | Thurber's Conference Suite (TC) | Vendome Board Room (VB) |
|-----------------------------------|-------------------------|-----------------------------------|-------------------------------------|-------------------------------|-------------------------------------|------------------------------|------------------------|-------------------------------------|-------------------------------------|---------------------------------|-------------------------|
| Friday, October 14, 2005 | | | | | | | | | | | |
| 7:00 a.m. | | | | | Division Chair Breakfast/ Meeting | | | | | | |
| 8:00 a.m. | 8:00 a.m. - 5:00 p.m. | Division K | Division A | | Division J | Exhibits | Division G | Division D Meeting/ Invited Address | Division F | Division H | |
| 9:30 a.m. | | | | Business Meeting | | | | | | | |
| 10:30 a.m. | | Getting Published Workshop | Division B | | Division J | | Division C | Division G | Book Signing | Division F | |
| 12:00 p.m. | | | | Luncheon Keynote Dr. Franklin | | | | | | | |
| 1:40 p.m. | | Keynote Follow-Up | Division D | | Division J | | Division D | Division K Meeting/ Invited Address | Division H | Division A | |
| 3:10 p.m. | | Division K | Division I Meeting/ Invited Address | Divisions G & L Roundtables | Division G | | Division C | Division K | Division H Meeting/ Invited Address | Division D | |
| 4:40 p.m. | | Council and Officers' Orientation | Division K | | Division J Meeting/ Invited Address | | Division K | Division D | Division A Meeting/ Invited Address | Division F | |
| 6:00 p.m. | | | | | | President's Reception | | | | | |
| Saturday, October 15, 2005 | | | | | | | | | | | |
| 8:00 a.m. | 8:00 - 10:00 a.m. | Division J | Division K | | Division K | | Division E | Division A | | Division C | MWERJ Editorial Meeting |
| 9:30 a.m. | | | | Presidential Address Dr. Holt | | | | | | | |
| 10:30 a.m. | | Division D | Conference Feedback | | Division C | | Division H | Division F | Division L | Division K | |



The Ohio State University
2500 Kenny Road
Columbus, Ohio 43210

Nonprofit Org.
U.S. Postage
PAID
Columbus, Ohio
Permit No. 711
